

**MMI**

---

**WAFER, HOUSING & TERMINAL  
PITCH: 2.00x2.00mm**

---

## TERMINAL- MCb 001

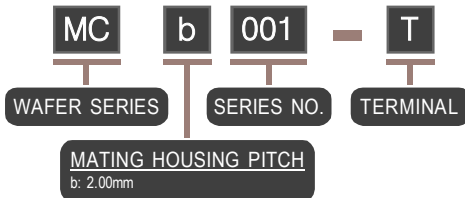
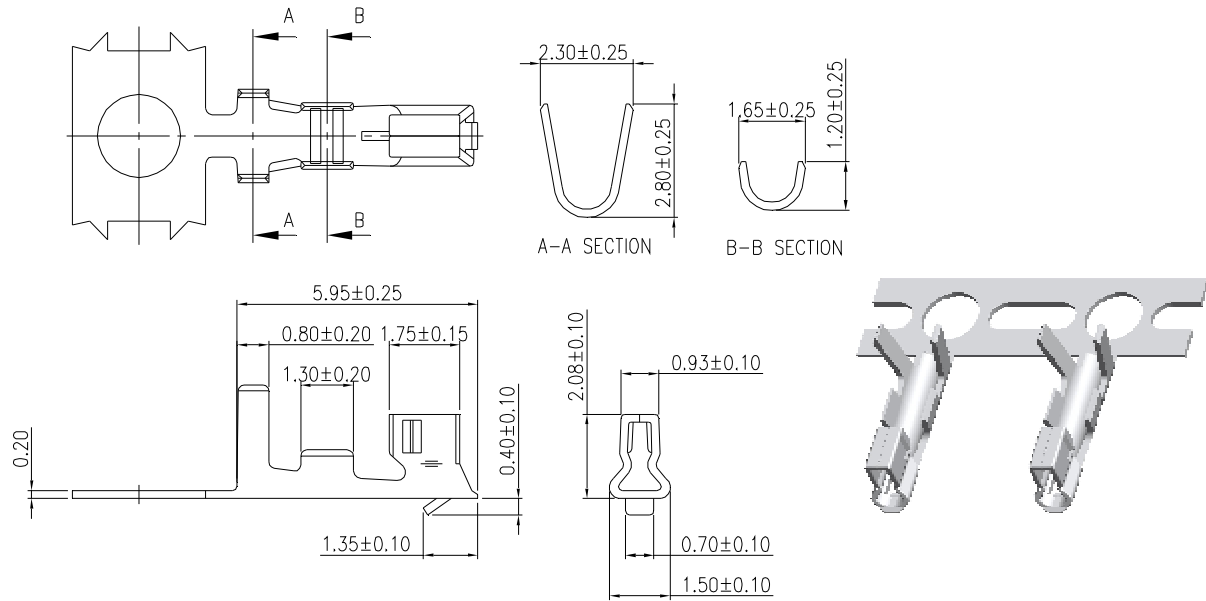

WIRE RANGE: AWG #24 - #28  
 INSULATION O.D.: 1.40mm MAX.  
 MATERIAL: PHOSPHOR BRONZE  
 FINISH: TIN PLATED

## TERMINAL- MCb 002

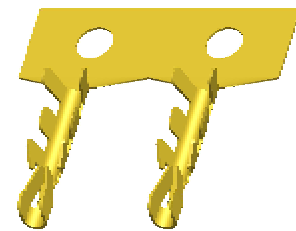
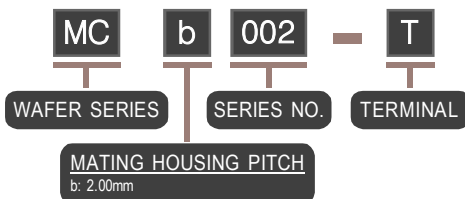
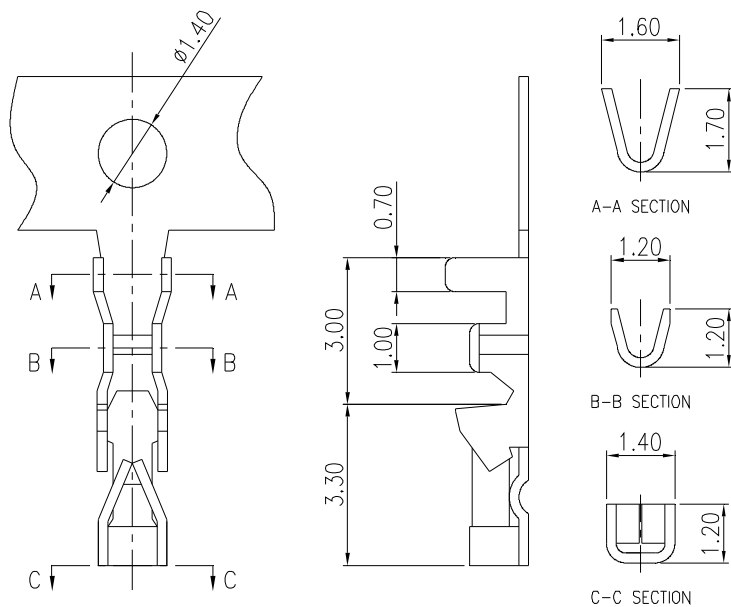

### SPECIFICATIONS

VOLTAGE RATING: 250V AC/DC  
 CURRENT RATING: 3A AC/DC  
 WITHSTAND VOLTAGE: 1000V AC/MINUTE  
 INSULATOR RESISTANCE: 1000M OHM MIN.  
 CONTACT RESISTANCE: INITIAL VALUE - 20m OHM MAX.  
 AFTER ENVIRONMENTAL TESTING: 20m OHM MAX.  
 TEMPERATURE RANGE: -25°C ~ +85°C  
 APPLICABLE WIRES: AWG #26 - #30  
 THICKNESS: 0.20mm

### MATERIALS

BASE: PHOSPHOR BRONZE  
 FINISH: TIN PLATED

NOTE : SOME SIZES, STYLES AND OPTION ARE NON-STANDARD, NON-CANCELLABLE, NON-RETURNABLE

## TERMINAL- MCb 004

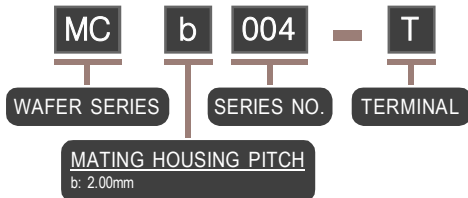
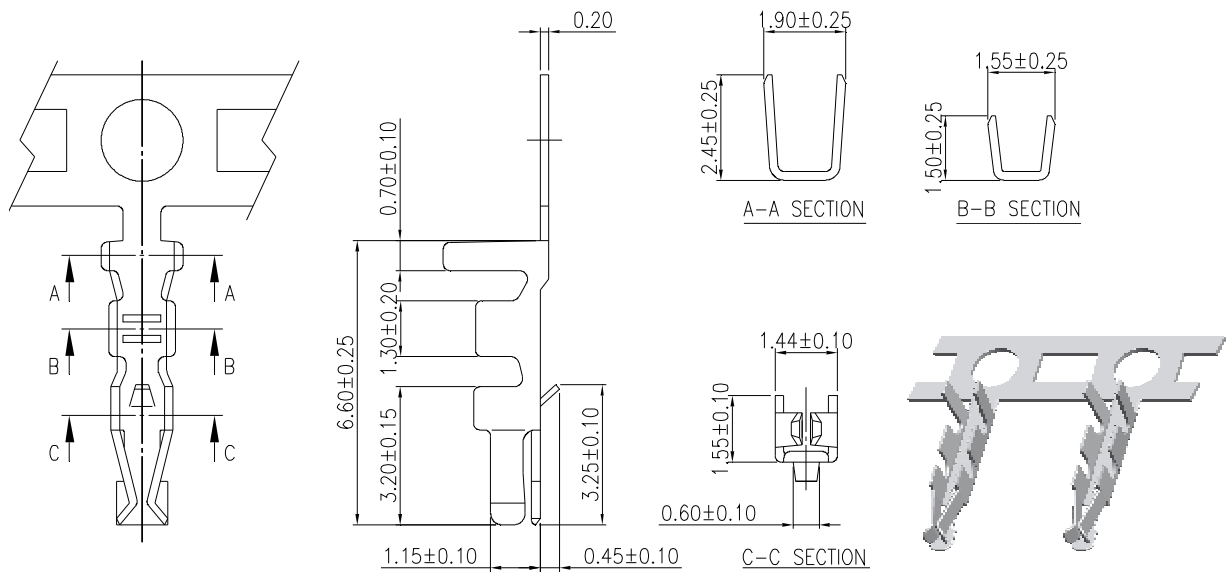

WIRE RANGE: AWG #24 - #28  
 INSULATION O.D.: 1.60mm MAX.  
 MATERIAL: PHOSPHOR BRONZE  
 FINISH: TIN PLATED

## TERMINAL- MCb 005

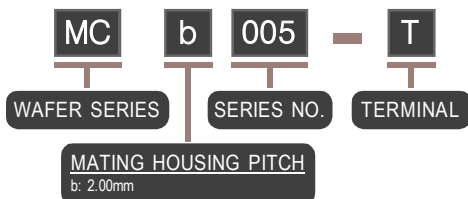
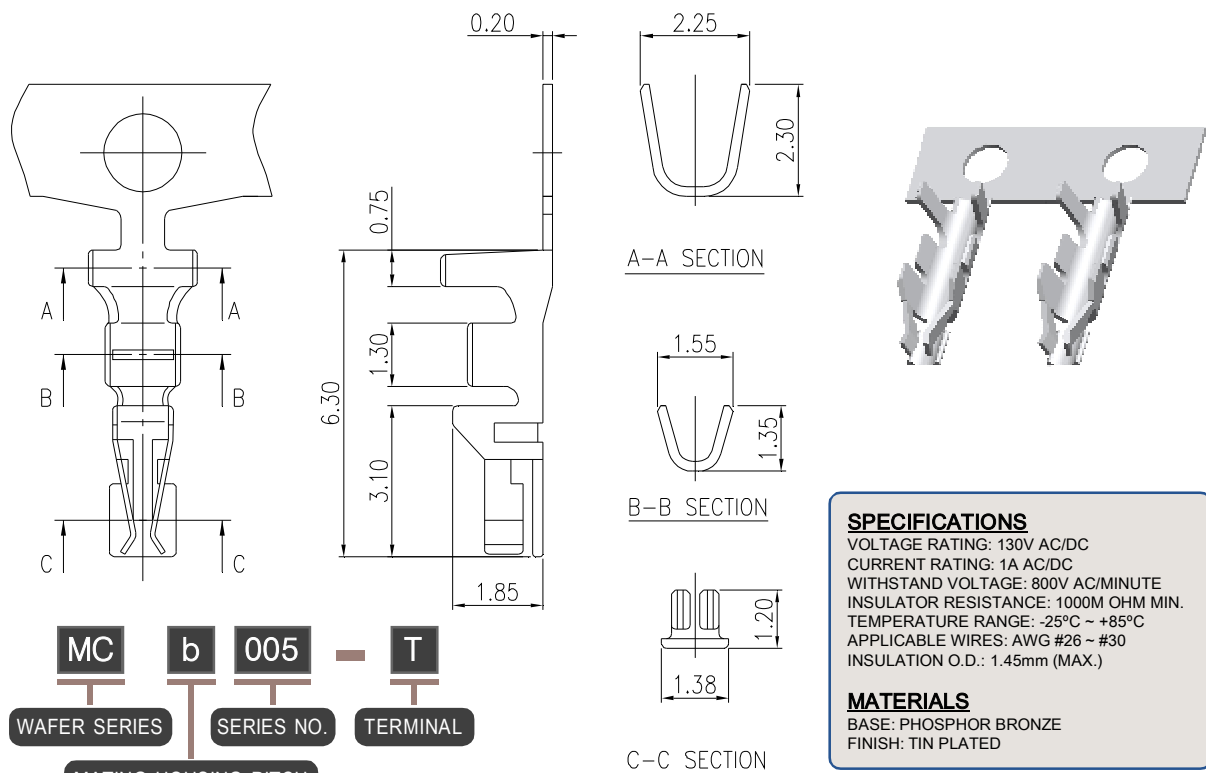

**SPECIFICATIONS**  
 VOLTAGE RATING: 130V AC/DC  
 CURRENT RATING: 1A AC/DC  
 WITHSTAND VOLTAGE: 800V AC/MINUTE  
 INSULATOR RESISTANCE: 1000M OHM MIN.  
 TEMPERATURE RANGE: -25°C ~ +85°C  
 APPLICABLE WIRES: AWG #26 ~ #30  
 INSULATION O.D.: 1.45mm (MAX.)

**MATERIALS**  
 BASE: PHOSPHOR BRONZE  
 FINISH: TIN PLATED

NOTE : SOME SIZES, STYLES AND OPTION ARE NON-STANDARD, NON-CANCELLABLE, NON-RETURNABLE

## TERMINAL- MCb 006

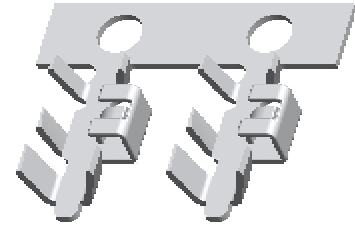
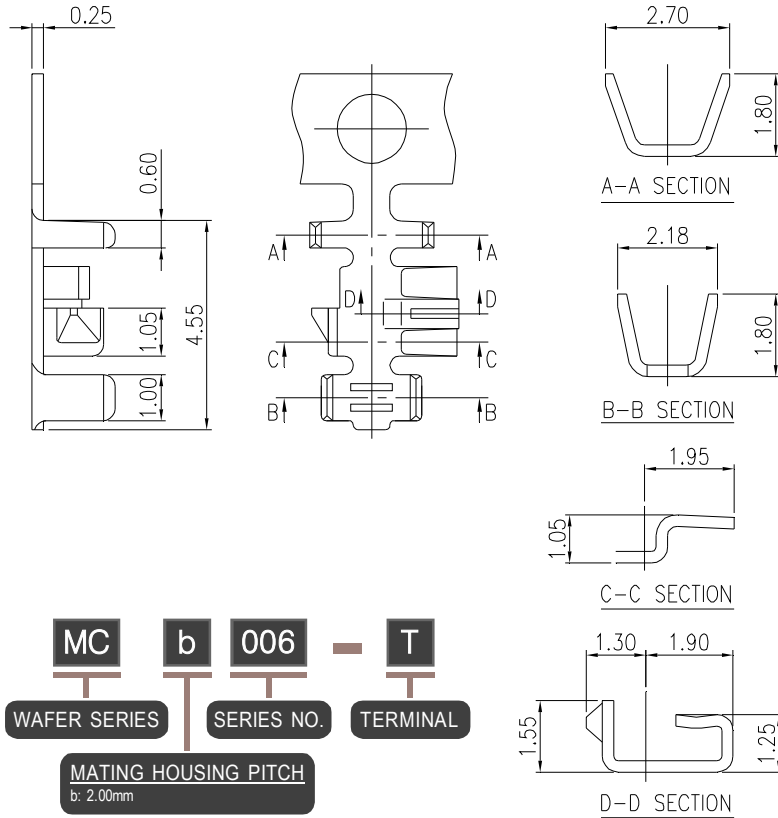

### SPECIFICATIONS

VOLTAGE RATING: 100V AC/DC  
CURRENT RATING: 1A AC/DC  
WITHSTAND VOLTAGE: 800V AC/MINUTE  
INSULATOR RESISTANCE: 1000M OHM MIN.  
CONTACT RESISTANCE: 20m OHM MAX.  
TEMPERATURE RANGE: -25°C ~ +85°C  
APPLICABLE WIRES: AWG #22 ~ #26  
INSULATION O.D.: 1.50mm (MAX.)

### MATERIALS

BASE: PHOSPHOR BRONZE  
FINISH: TIN PLATED

## TERMINAL- MCb 007

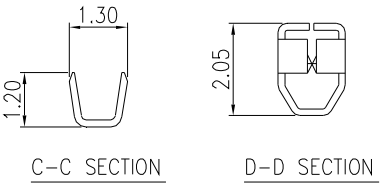
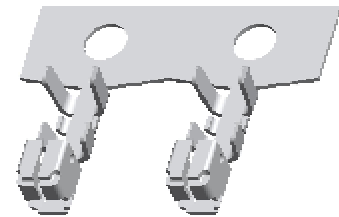
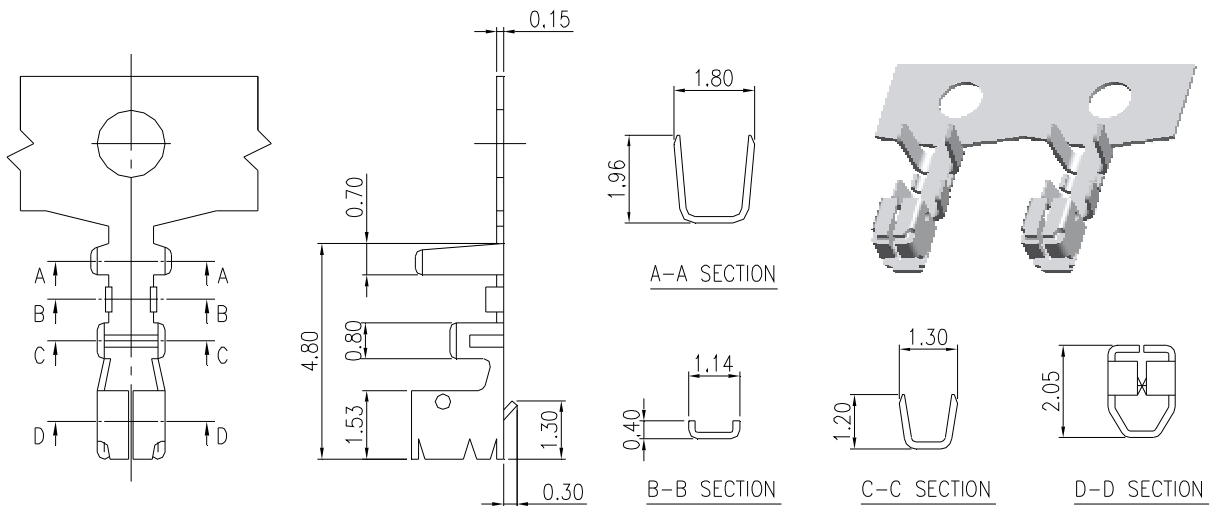

### SPECIFICATIONS

VOLTAGE RATING: 100V AC/DC  
CURRENT RATING: 1A AC/DC  
WITHSTAND VOLTAGE: 800V AC/MINUTE  
INSULATOR RESISTANCE: 1000M OHM MIN.  
CONTACT RESISTANCE: 20m OHM MAX.  
TEMPERATURE RANGE: -25°C ~ +85°C  
APPLICABLE WIRES: AWG #24 ~ #28  
INSULATION O.D.: 1.40mm (MAX.)

### MATERIALS

BASE: PHOSPHOR BRONZE  
FINISH: TIN PLATED

NOTE : SOME SIZES, STYLES AND OPTION ARE NON-STANDARD, NON-CANCELLABLE, NON-RETURNABLE

## 2.00 mm WAFER - MCb 001 STRAIGHT TYPE - P

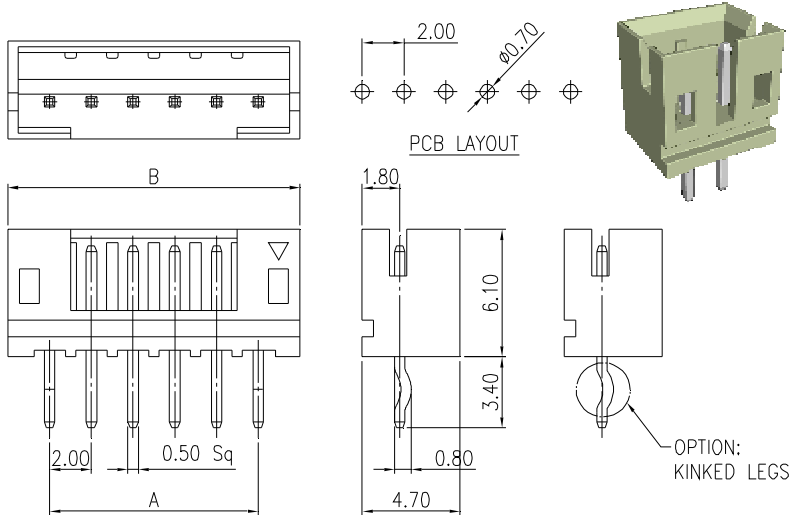

### SPECIFICATIONS

VOLTAGE RATING: 100V AC/DC  
 CURRENT RATING: 1A AC/DC  
 WITHSTAND VOLTAGE: 800V AC/MINUTE  
 INSULATOR RESISTANCE: 1000M OHM MIN.  
 CONTACT RESISTANCE: 20m OHM MAX.  
 TEMPERATURE RANGE: -25°C ~ +85°C

### MATERIALS

CONTACT: BRASS, TIN PLATED  
 BASE: NYLON 66, UL 94V-0

| PART NO.    | POLES | DIMENSION |       |
|-------------|-------|-----------|-------|
|             |       | A         | B     |
| MCb001-P02T | 2     | 2.00      | 6.00  |
| MCb001-P03T | 3     | 4.00      | 8.00  |
| MCb001-P04T | 4     | 6.00      | 10.00 |
| MCb001-P05T | 5     | 8.00      | 12.00 |
| MCb001-P06T | 6     | 10.00     | 14.00 |
| MCb001-P07T | 7     | 12.00     | 16.00 |
| MCb001-P08T | 8     | 14.00     | 18.00 |
| MCb001-P09T | 9     | 16.00     | 20.00 |
| MCb001-P10T | 10    | 18.00     | 22.00 |
| MCb001-P11T | 11    | 20.00     | 24.00 |
| MCb001-P12T | 12    | 22.00     | 26.00 |
| MCb001-P13T | 13    | 24.00     | 28.00 |
| MCb001-P14T | 14    | 26.00     | 30.00 |
| MCb001-P15T | 15    | 28.00     | 32.00 |
| MCb001-P16T | 16    | 30.00     | 34.00 |

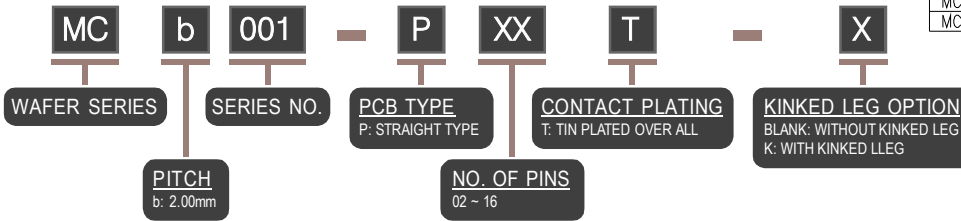

| MATING CONNECTOR |              |
|------------------|--------------|
| PRODUCT          | PART NO.     |
| HOUSING          | MCb001-___-H |
| TERMINAL         | MCb001-T     |

## 2.00 mm WAFER - MCb 001 RIGHT ANGEL TYPE - Pa

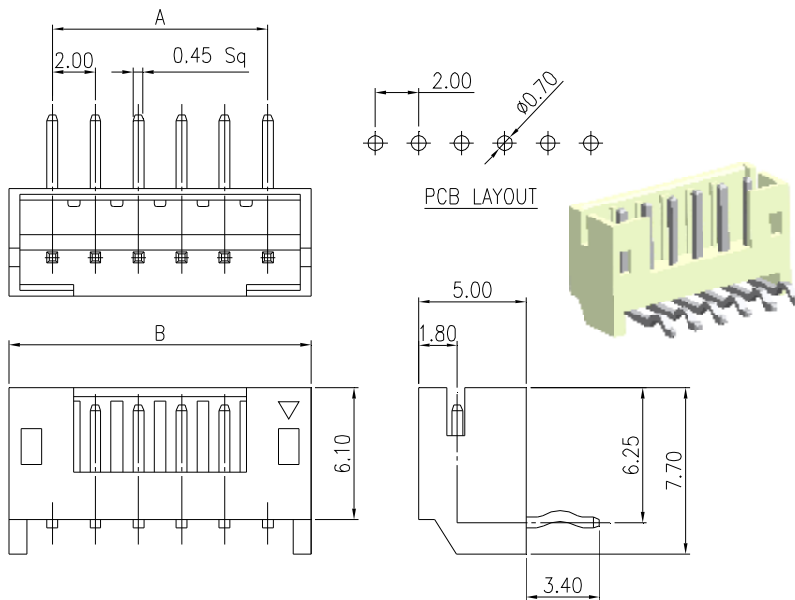

### SPECIFICATIONS

VOLTAGE RATING: 100V AC/DC  
 CURRENT RATING: 1A AC/DC  
 WITHSTAND VOLTAGE: 800V AC/MINUTE  
 INSULATOR RESISTANCE: 1000M OHM MIN.  
 CONTACT RESISTANCE: 20m OHM MAX.  
 TEMPERATURE RANGE: -25°C ~ +85°C

### MATERIALS

CONTACT: BRASS, TIN PLATED  
 BASE: NYLON 66, UL 94V-0

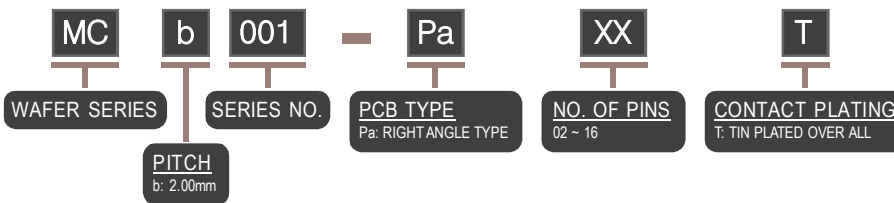

| MATING CONNECTOR |              |
|------------------|--------------|
| PRODUCT          | PART NO.     |
| HOUSING          | MCb001-___-H |
| TERMINAL         | MCb001-T     |

| PART NO.     | POLES | DIMENSION |       |
|--------------|-------|-----------|-------|
|              |       | A         | B     |
| MCb001-Pa02T | 2     | 2.00      | 6.00  |
| MCb001-Pa03T | 3     | 4.00      | 8.00  |
| MCb001-Pa04T | 4     | 6.00      | 10.00 |
| MCb001-Pa05T | 5     | 8.00      | 12.00 |
| MCb001-Pa06T | 6     | 10.00     | 14.00 |
| MCb001-Pa07T | 7     | 12.00     | 16.00 |
| MCb001-Pa08T | 8     | 14.00     | 18.00 |
| MCb001-Pa09T | 9     | 16.00     | 20.00 |
| MCb001-Pa10T | 10    | 18.00     | 22.00 |
| MCb001-Pa11T | 11    | 20.00     | 24.00 |
| MCb001-Pa12T | 12    | 22.00     | 26.00 |
| MCb001-Pa13T | 13    | 24.00     | 28.00 |
| MCb001-Pa14T | 14    | 26.00     | 30.00 |
| MCb001-Pa15T | 15    | 28.00     | 32.00 |
| MCb001-Pa16T | 16    | 30.00     | 34.00 |

NOTE : SOME SIZES, STYLES AND OPTION ARE NON-STANDARD, NON-CANCELLABLE, NON-RETURNABLE

## 2.00 mm WAFER - MCb 001 SURFACE MOUNT TYPE - Pt

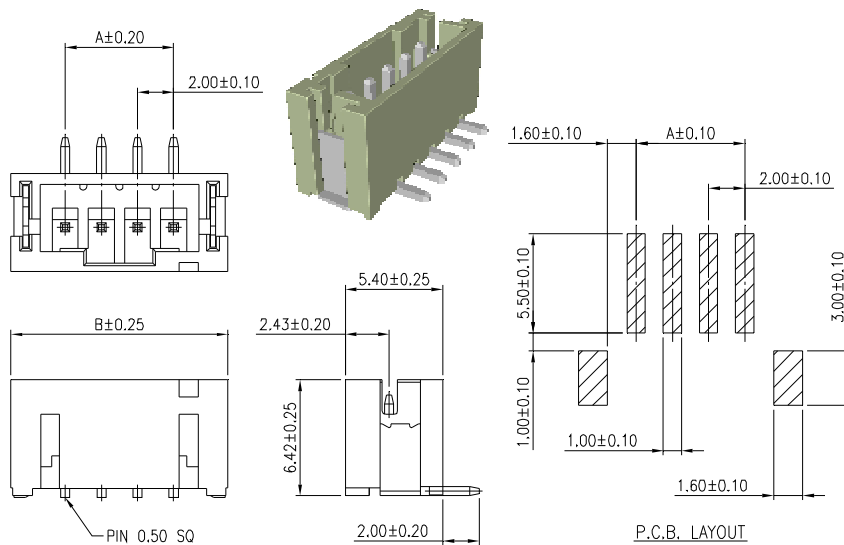

### SPECIFICATIONS

VOLTAGE RATING: 100V AC/DC  
 CURRENT RATING: 1A AC/DC  
 WITHSTAND VOLTAGE: 800V AC/MINUTE  
 INSULATOR RESISTANCE: 1000M OHM MIN.  
 CONTACT RESISTANCE: 20m OHM MAX.  
 TEMPERATURE RANGE: -25°C ~ +85°C

### MATERIALS

CONTACT: BRASS, TIN PLATED  
 SOLDER TABS: BRASS, TIN PLATED  
 BASE: NYLON 66, UL 94V-0

### MATING CONNECTOR

| PRODUCT  | PART NO.    |
|----------|-------------|
| HOUSING  | MCb001-__-H |
| TERMINAL | MCb001-T    |

| PART NO.     | POLES | DIMENSION |       |
|--------------|-------|-----------|-------|
|              |       | A         | B     |
| MCb001-Pt02T | 2     | 2.00      | 8.00  |
| MCb001-Pt03T | 3     | 4.00      | 10.00 |
| MCb001-Pt04T | 4     | 6.00      | 12.00 |
| MCb001-Pt05T | 5     | 8.00      | 14.00 |
| MCb001-Pt06T | 6     | 10.00     | 16.00 |
| MCb001-Pt07T | 7     | 12.00     | 18.00 |
| MCb001-Pt08T | 8     | 14.00     | 20.00 |
| MCb001-Pt09T | 9     | 16.00     | 22.00 |
| MCb001-Pt10T | 10    | 18.00     | 24.00 |
| MCb001-Pt11T | 11    | 20.00     | 26.00 |
| MCb001-Pt12T | 12    | 22.00     | 28.00 |
| MCb001-Pt13T | 13    | 24.00     | 30.00 |
| MCb001-Pt14T | 14    | 26.00     | 32.00 |
| MCb001-Pt15T | 15    | 28.00     | 34.00 |
| MCb001-Pt16T | 16    | 30.00     | 36.00 |

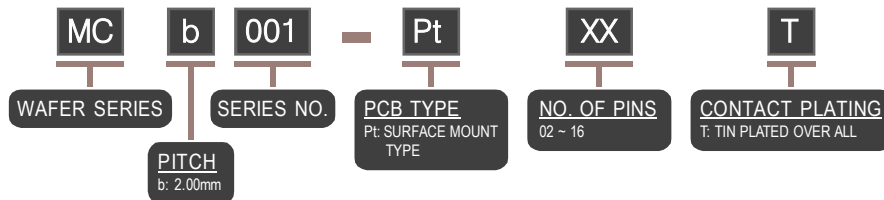

## 2.00 mm WAFER - MCb 001 RIGHT ANGLE SURFACE MOUNT TYPE - Rt

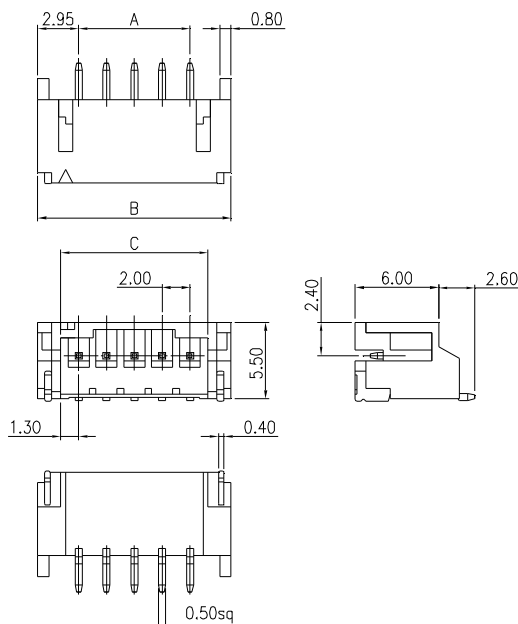

### SPECIFICATIONS

VOLTAGE RATING: 100V AC/DC  
 CURRENT RATING: 2A AC/DC  
 WITHSTAND VOLTAGE: 800V AC/MINUTE  
 INSULATOR RESISTANCE: 1000M OHM MIN.  
 CONTACT RESISTANCE: INITIAL VALUE: 10m OHM MAX.  
 AFTER ENVIRONMENTAL TESTING: 20m OHM MAX.  
 TEMPERATURE RANGE: -25°C ~ +85°C  
 APPLICABLE PC BOARD THICKNESS: 0.80 - 1.60mm

### MATERIALS

CONTACT: HIGH STRENGTH BRASS WITH TIN OVER NICKEL PLATED.  
 WAFER: HIGH TEMPERATURE PLASTIC NYLON 46, UL 94V-0

### MATING CONNECTOR

| PRODUCT  | PART NO.    |
|----------|-------------|
| HOUSING  | MCb001-__-H |
| TERMINAL | MCb001-T    |

| PART NO.     | POLES | DIMENSION |       |       |
|--------------|-------|-----------|-------|-------|
|              |       | A         | B     | C     |
| MCb001-Rt02T | 2     | 2.00      | 8.00  | 4.60  |
| MCb001-Rt03T | 3     | 4.00      | 10.00 | 6.60  |
| MCb001-Rt04T | 4     | 6.00      | 12.00 | 8.60  |
| MCb001-Rt05T | 5     | 8.00      | 14.00 | 10.60 |
| MCb001-Rt06T | 6     | 10.00     | 16.00 | 12.60 |
| MCb001-Rt07T | 7     | 12.00     | 18.00 | 14.60 |
| MCb001-Rt08T | 8     | 14.00     | 20.00 | 16.60 |
| MCb001-Rt09T | 9     | 16.00     | 22.00 | 18.60 |
| MCb001-Rt10T | 10    | 18.00     | 24.00 | 20.60 |
| MCb001-Rt11T | 11    | 20.00     | 26.00 | 22.60 |
| MCb001-Rt12T | 12    | 22.00     | 28.00 | 24.60 |
| MCb001-Rt13T | 13    | 24.00     | 30.00 | 26.60 |
| MCb001-Rt14T | 14    | 26.00     | 32.00 | 28.60 |
| MCb001-Rt15T | 15    | 28.00     | 34.00 | 30.60 |
| MCb001-Rt16T | 16    | 30.00     | 36.00 | 32.60 |

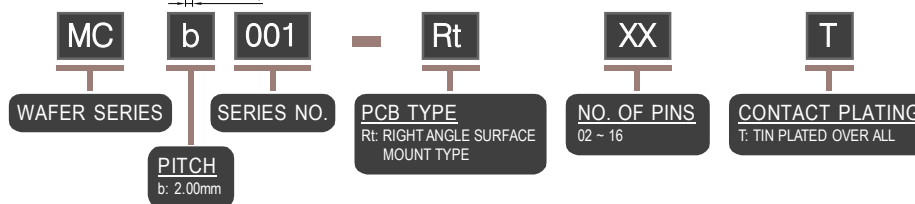

NOTE : SOME SIZES, STYLES AND OPTION ARE NON-STANDARD, NON-CANCELLABLE, NON-RETURNABLE

## 2.00 X 2.00 mm WAFER - MCb 004 STRAIGHT TYPE - P

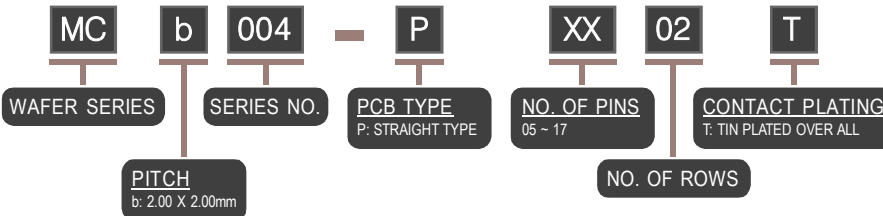
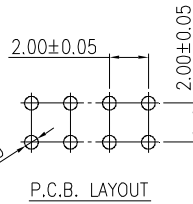
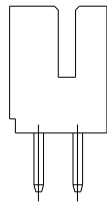
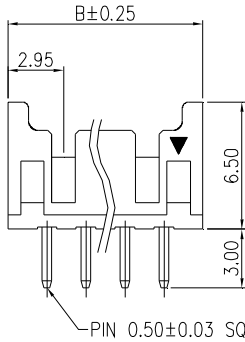
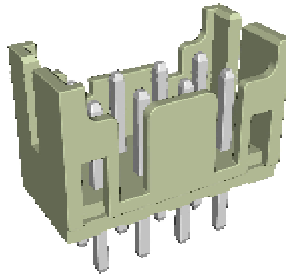
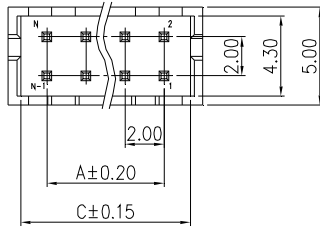

### SPECIFICATIONS

VOLTAGE RATING: 250V AC/DC  
CURRENT RATING: 1A AC/DC  
INSULATOR RESISTANCE: 1000M OHM MIN.  
TEMPERATURE RANGE: -25°C ~ +85°C

### MATERIALS

CONTACT: BRASS, TIN PLATED  
BASE: NYLON 66, UL 94V-0

| MATING CONNECTOR |               |
|------------------|---------------|
| PRODUCT          | PART NO.      |
| HOUSING          | MCb004-__02-H |
| TERMINAL         | MCb004-T      |

| PART NO.      | CONTACTS | DIMENSION |       |       |
|---------------|----------|-----------|-------|-------|
|               |          | A         | B     | C     |
| MCb004-P0502T | 2X5      | 8.00      | 11.90 | 10.70 |
| MCb004-P0602T | 2X6      | 10.00     | 13.90 | 12.70 |
| MCb004-P0702T | 2X7      | 12.00     | 15.90 | 14.70 |
| MCb004-P0802T | 2X8      | 14.00     | 17.90 | 16.70 |
| MCb004-P0902T | 2X9      | 16.00     | 19.90 | 18.70 |
| MCb004-P1002T | 2X10     | 18.00     | 21.90 | 20.70 |
| MCb004-P1102T | 2X11     | 20.00     | 23.90 | 22.70 |
| MCb004-P1202T | 2X12     | 22.00     | 25.90 | 24.70 |
| MCb004-P1302T | 2X13     | 24.00     | 27.90 | 26.70 |
| MCb004-P1402T | 2X14     | 26.00     | 29.90 | 28.70 |
| MCb004-P1502T | 2X15     | 28.00     | 31.90 | 30.70 |
| MCb004-P1602T | 2X16     | 30.00     | 33.90 | 32.70 |
| MCb004-P1702T | 2X17     | 32.00     | 35.90 | 34.70 |

## 2.00 X 2.00 mm WAFER - MCb 004 RIGHT ANGEL TYPE - Pa

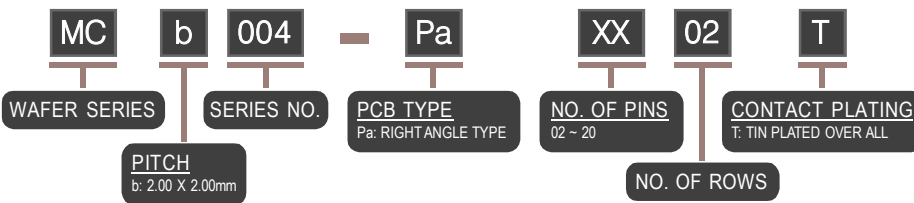
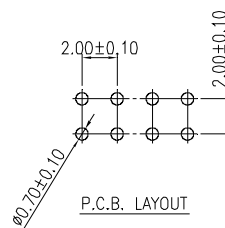
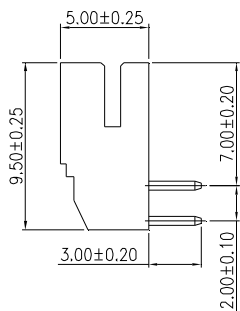
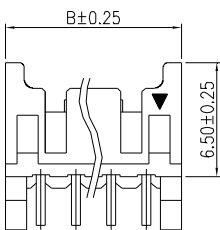
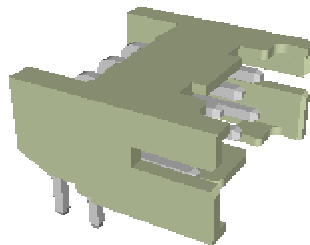
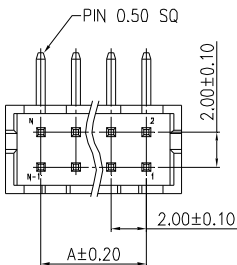

### SPECIFICATIONS

VOLTAGE RATING: 250V AC/DC  
CURRENT RATING: 1A AC/DC  
INSULATOR RESISTANCE: 1000M OHM MIN.  
TEMPERATURE RANGE: -25°C ~ +85°C

### MATERIALS

CONTACT: BRASS, TIN PLATED  
BASE: NYLON 66, UL 94V-0

| MATING CONNECTOR |               |
|------------------|---------------|
| PRODUCT          | PART NO.      |
| HOUSING          | MCb004-__02-H |
| TERMINAL         | MCb004-T      |

| PART NO.       | CONTACTS | DIMENSION |       |
|----------------|----------|-----------|-------|
|                |          | A         | B     |
| MCb004-Pa0202T | 2X2      | 2.00      | 6.00  |
| MCb004-Pa0302T | 2X3      | 4.00      | 8.00  |
| MCb004-Pa0402T | 2X4      | 6.00      | 10.00 |
| MCb004-Pa0502T | 2X5      | 8.00      | 12.00 |
| MCb004-Pa0602T | 2X6      | 10.00     | 14.00 |
| MCb004-Pa0702T | 2X7      | 12.00     | 16.00 |
| MCb004-Pa0802T | 2X8      | 14.00     | 18.00 |
| MCb004-Pa0902T | 2X9      | 16.00     | 20.00 |
| MCb004-Pa1002T | 2X10     | 18.00     | 22.00 |
| MCb004-Pa1102T | 2X11     | 20.00     | 24.00 |
| MCb004-Pa1202T | 2X12     | 22.00     | 26.00 |
| MCb004-Pa1302T | 2X13     | 24.00     | 28.00 |
| MCb004-Pa1402T | 2X14     | 26.00     | 30.00 |
| MCb004-Pa1502T | 2X15     | 28.00     | 32.00 |
| MCb004-Pa1602T | 2X16     | 30.00     | 34.00 |
| MCb004-Pa1702T | 2X17     | 32.00     | 36.00 |
| MCb004-Pa1802T | 2X18     | 34.00     | 38.00 |
| MCb004-Pa1902T | 2X19     | 36.00     | 40.00 |
| MCb004-Pa2002T | 2X20     | 38.00     | 42.00 |

NOTE : SOME SIZES, STYLES AND OPTION ARE NON-STANDARD, NON-CANCELLABLE, NON-RETURNABLE

## 2.00 X 2.00 mm WAFER - MCb 005 SURFACE MOUNT TYPE - Pt

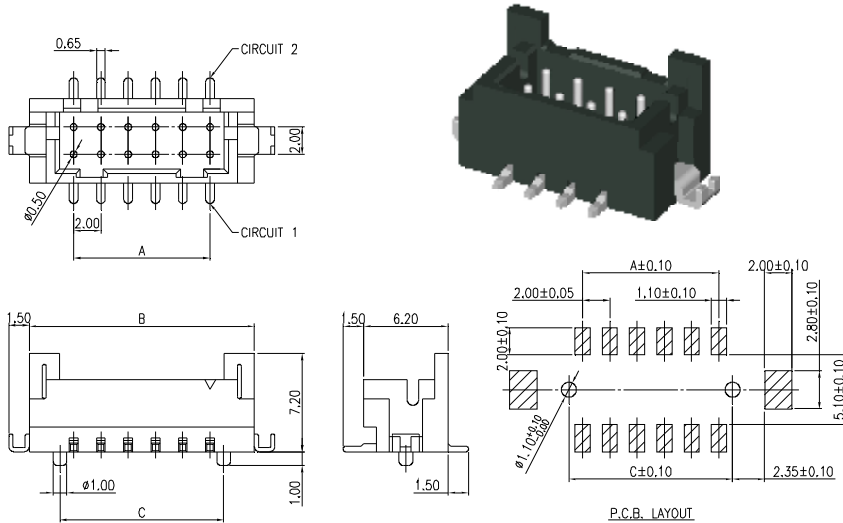

### SPECIFICATIONS

VOLTAGE RATING: 130V AC/DC  
 CURRENT RATING: 1A AC/DC  
 INSULATOR RESISTANCE: 1000M OHM MIN.  
 WITHSTAND VOLTAGE: 800V AC/MINUTE  
 CONTACT RESISTANCE: 20m OHM MAX.  
 TEMPERATURE RANGE: -25°C ~ +85°C

### MATERIALS

CONTACT: BRASS, TIN PLATED  
 BASE: NYLON 6T, UL 94V-0

### MATING CONNECTOR

| PRODUCT  | PART NO.       |
|----------|----------------|
| HOUSING  | MCb005-__-02-H |
| TERMINAL | MCb005-T       |

| PART NO.         | CONTACTS | DIMENSION |       |       |
|------------------|----------|-----------|-------|-------|
|                  |          | A         | B     | C     |
| MCb005-Pt0202T-P | 2X2      | 2.00      | 8.50  | 4.00  |
| MCb005-Pt0302T-P | 2X3      | 4.00      | 10.50 | 6.00  |
| MCb005-Pt0402T-P | 2X4      | 6.00      | 12.50 | 8.00  |
| MCb005-Pt0502T-P | 2X5      | 8.00      | 14.50 | 10.00 |
| MCb005-Pt0602T-P | 2X6      | 10.00     | 16.50 | 12.00 |
| MCb005-Pt0702T-P | 2X7      | 12.00     | 18.50 | 14.00 |
| MCb005-Pt0802T-P | 2X8      | 14.00     | 20.50 | 16.00 |
| MCb005-Pt0902T-P | 2X9      | 16.00     | 22.50 | 18.00 |
| MCb005-Pt1002T-P | 2X10     | 18.00     | 24.50 | 20.00 |
| MCb005-Pt1102T-P | 2X11     | 20.00     | 26.50 | 22.00 |
| MCb005-Pt1202T-P | 2X12     | 22.00     | 28.50 | 24.00 |
| MCb005-Pt1302T-P | 2X13     | 24.00     | 30.50 | 26.00 |
| MCb005-Pt1402T-P | 2X14     | 26.00     | 32.50 | 28.00 |
| MCb005-Pt1502T-P | 2X15     | 28.00     | 34.50 | 30.00 |
| MCb005-Pt1602T-P | 2X16     | 30.00     | 36.50 | 32.00 |
| MCb005-Pt2002T-P | 2X20     | 38.00     | 44.50 | 40.00 |

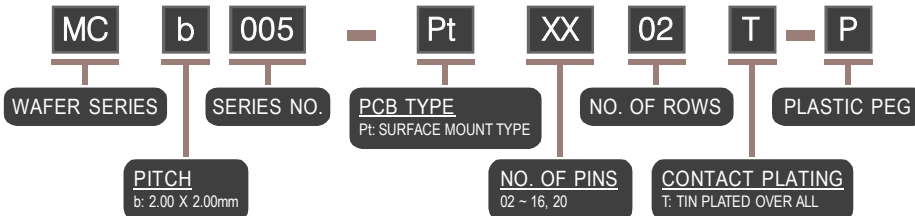

## 2.00 mm WAFER - MCb 006 STRAIGHT TYPE - P

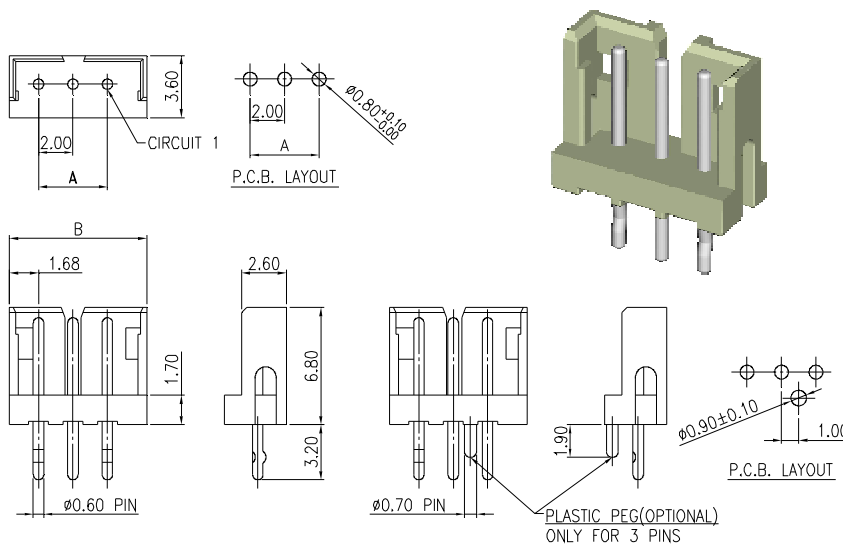

### SPECIFICATIONS

VOLTAGE RATING: 100V AC/DC  
 CURRENT RATING: 1A AC/DC  
 INSULATOR RESISTANCE: 1000M OHM MIN.  
 WITHSTAND VOLTAGE: 800V AC/MINUTE  
 CONTACT RESISTANCE: 20m OHM MAX.  
 TEMPERATURE RANGE: -25°C ~ +85°C

### MATERIALS

CONTACT: BRASS, TIN PLATED  
 BASE: NYLON 66, UL 94V-0

### MATING CONNECTOR

| PRODUCT  | PART NO.    |
|----------|-------------|
| HOUSING  | MCb006-__-H |
| TERMINAL | MCb006-T    |

| PART NO.      | CONTACTS | DIMENSION |       |
|---------------|----------|-----------|-------|
|               |          | A         | B     |
| MCb006-P02T   | 2        | 2.00      | 5.96  |
| MCb006-P03T   | 3        | 4.00      | 7.96  |
| MCb006-P03T-P | 3        | 4.00      | 7.96  |
| MCb006-P04T   | 4        | 6.00      | 9.96  |
| MCb006-P05T   | 5        | 8.00      | 11.96 |
| MCb006-P06T   | 6        | 10.00     | 13.96 |
| MCb006-P07T   | 7        | 12.00     | 15.96 |
| MCb006-P08T   | 8        | 14.00     | 17.96 |
| MCb006-P09T   | 9        | 16.00     | 19.96 |
| MCb006-P10T   | 10       | 18.00     | 21.96 |
| MCb006-P11T   | 11       | 20.00     | 23.96 |
| MCb006-P12T   | 12       | 22.00     | 25.96 |
| MCb006-P13T   | 13       | 24.00     | 27.96 |
| MCb006-P14T   | 14       | 26.00     | 29.96 |
| MCb006-P15T   | 15       | 28.00     | 31.96 |

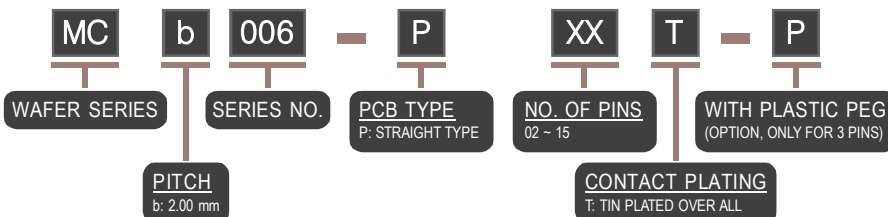

NOTE : SOME SIZES, STYLES AND OPTION ARE NON-STANDARD, NON-CANCELLABLE, NON-RETURNABLE



## 2.00 mm WAFER - MCb 006 RIGHT ANGLE TYPE - Pa

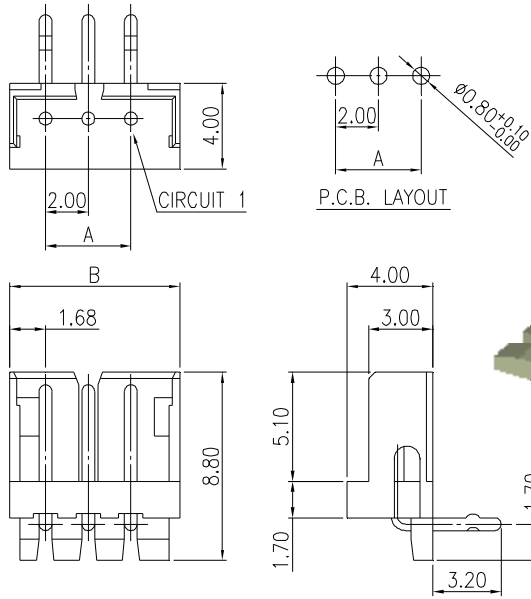

### SPECIFICATIONS

VOLTAGE RATING: 100V AC/DC  
 CURRENT RATING: 1A AC/DC  
 INSULATOR RESISTANCE: 1000M OHM MIN.  
 WITHSTAND VOLTAGE: 800V AC/MINUTE  
 CONTACT RESISTANCE: 20m OHM MAX.  
 TEMPERATURE RANGE: -25°C ~ +85°C

### MATERIALS

CONTACT: BRASS, TIN PLATED  
 BASE: NYLON 66, UL 94V-0

| MATING CONNECTOR |             |
|------------------|-------------|
| PRODUCT          | PART NO.    |
| HOUSING          | MCb006-__-H |
| TERMINAL         | MCb006-T    |

| PART NO.     | CONTACTS | DIMENSION |       |
|--------------|----------|-----------|-------|
|              |          | A         | B     |
| MCb006-Pa02T | 2        | 2.00      | 5.96  |
| MCb006-Pa03T | 3        | 4.00      | 7.96  |
| MCb006-Pa04T | 4        | 6.00      | 9.96  |
| MCb006-Pa05T | 5        | 8.00      | 11.96 |
| MCb006-Pa06T | 6        | 10.00     | 13.96 |
| MCb006-Pa07T | 7        | 12.00     | 15.96 |
| MCb006-Pa08T | 8        | 14.00     | 17.96 |
| MCb006-Pa09T | 9        | 16.00     | 19.96 |
| MCb006-Pa10T | 10       | 18.00     | 21.96 |
| MCb006-Pa11T | 11       | 20.00     | 23.96 |
| MCb006-Pa12T | 12       | 22.00     | 25.96 |
| MCb006-Pa13T | 13       | 24.00     | 27.96 |
| MCb006-Pa14T | 14       | 26.00     | 29.96 |
| MCb006-Pa15T | 15       | 28.00     | 31.96 |

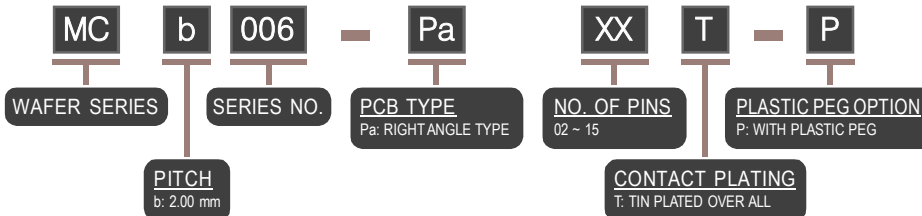

## 2.00 mm WAFER - MCb 007 STRAIGHT TYPE - P

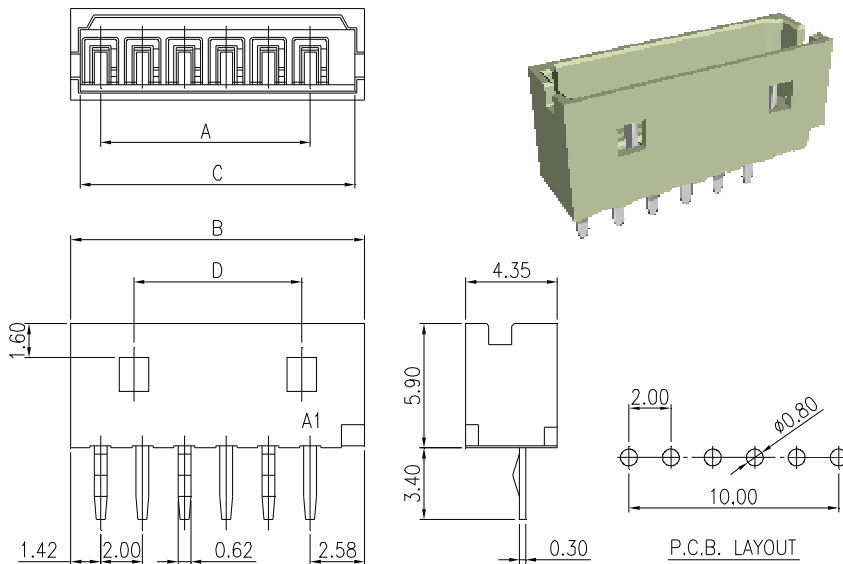

### SPECIFICATIONS

CURRENT RATING: 1A AC/DC  
 INSULATOR RESISTANCE: 1000M OHM MIN.  
 WITHSTAND VOLTAGE: 800V AC/MINUTE  
 CONTACT RESISTANCE: 20m OHM MAX.  
 TEMPERATURE RANGE: -25°C ~ +85°C

### MATERIALS

P.B.T. UL 94V-0 WITH 30% G.F

| MATING CONNECTOR |             |
|------------------|-------------|
| PRODUCT          | PART NO.    |
| HOUSING          | MCb007-__-H |
| TERMINAL         | MCb007-T    |

| PART NO.    | CONTACTS | DIMENSION |       |       |       |
|-------------|----------|-----------|-------|-------|-------|
|             |          | A         | B     | C     | D     |
| MCb007-P02T | 2        | 2.00      | 6.00  | 5.10  | -     |
| MCb007-P03T | 3        | 4.00      | 8.00  | 7.10  | -     |
| MCb007-P04T | 4        | 6.00      | 10.00 | 9.10  | 4.00  |
| MCb007-P05T | 5        | 8.00      | 12.00 | 11.10 | 6.00  |
| MCb007-P06T | 6        | 10.00     | 14.00 | 13.10 | 8.00  |
| MCb007-P07T | 7        | 12.00     | 16.00 | 15.10 | 10.00 |
| MCb007-P08T | 8        | 14.00     | 18.00 | 17.10 | 12.00 |
| MCb007-P09T | 9        | 16.00     | 20.00 | 19.10 | 14.00 |
| MCb007-P10T | 10       | 18.00     | 22.00 | 21.10 | 16.00 |
| MCb007-P11T | 11       | 20.00     | 24.00 | 23.10 | 18.00 |
| MCb007-P12T | 12       | 22.00     | 26.00 | 25.10 | 20.00 |
| MCb007-P13T | 13       | 24.00     | 28.00 | 27.10 | 22.00 |
| MCb007-P14T | 14       | 26.00     | 30.00 | 29.10 | 24.00 |
| MCb007-P15T | 15       | 28.00     | 32.00 | 31.10 | 26.00 |

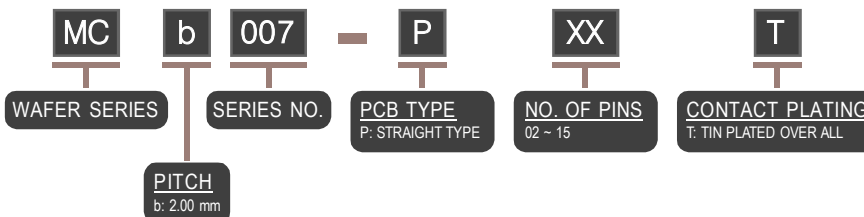

NOTE : SOME SIZES, STYLES AND OPTION ARE NON-STANDARD, NON-CANCELLABLE, NON-RETURNABLE

## 2.00 mm WAFER - MCb 007 RIGHT ANGLE TYPE - Pa

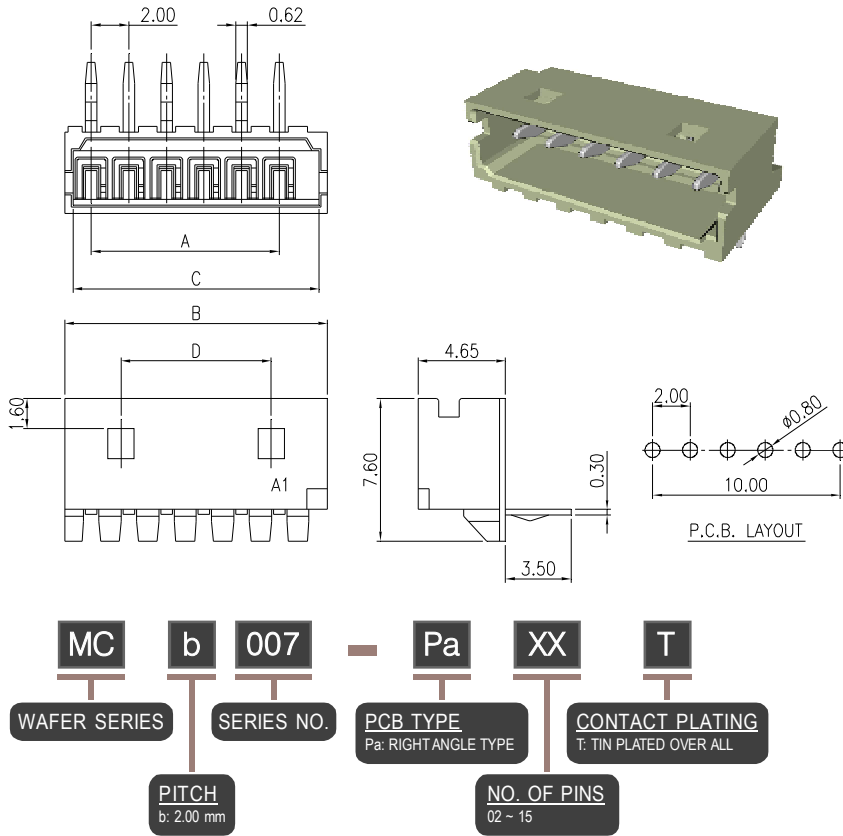

### SPECIFICATIONS

CURRENT RATING: 1A AC/DC  
 INSULATOR RESISTANCE: 1000M OHM MIN.  
 WITHSTAND VOLTAGE: 800V AC/MINUTE  
 CONTACT RESISTANCE: 20m OHM MAX.  
 TEMPERATURE RANGE: -25°C ~ +85°C

### MATERIALS

P.B.T. UL 94V-0 WITH 30% G.F

| MATING CONNECTOR |             |
|------------------|-------------|
| PRODUCT          | PART NO.    |
| HOUSING          | MCb007-__-H |
| TERMINAL         | MCb007-T    |

| PART NO.     | CONTACTS | DIMENSION |       |       |       |
|--------------|----------|-----------|-------|-------|-------|
|              |          | A         | B     | C     | D     |
| MCb007-Pa02T | 2        | 2.00      | 6.00  | 5.10  | -     |
| MCb007-Pa03T | 3        | 4.00      | 8.00  | 7.10  | -     |
| MCb007-Pa04T | 4        | 6.00      | 10.00 | 9.10  | 4.00  |
| MCb007-Pa05T | 5        | 8.00      | 12.00 | 11.10 | 6.00  |
| MCb007-Pa06T | 6        | 10.00     | 14.00 | 13.10 | 8.00  |
| MCb007-Pa07T | 7        | 12.00     | 16.00 | 15.10 | 10.00 |
| MCb007-Pa08T | 8        | 14.00     | 18.00 | 17.10 | 12.00 |
| MCb007-Pa09T | 9        | 16.00     | 20.00 | 19.10 | 14.00 |
| MCb007-Pa10T | 10       | 18.00     | 22.00 | 21.10 | 16.00 |
| MCb007-Pa11T | 11       | 20.00     | 24.00 | 23.10 | 18.00 |
| MCb007-Pa12T | 12       | 22.00     | 26.00 | 25.10 | 20.00 |
| MCb007-Pa13T | 13       | 24.00     | 28.00 | 27.10 | 22.00 |
| MCb007-Pa14T | 14       | 26.00     | 30.00 | 29.10 | 24.00 |
| MCb007-Pa15T | 15       | 28.00     | 32.00 | 31.10 | 26.00 |

## 2.00 mm WAFER - MCb 011 STRAIGHT TYPE - P

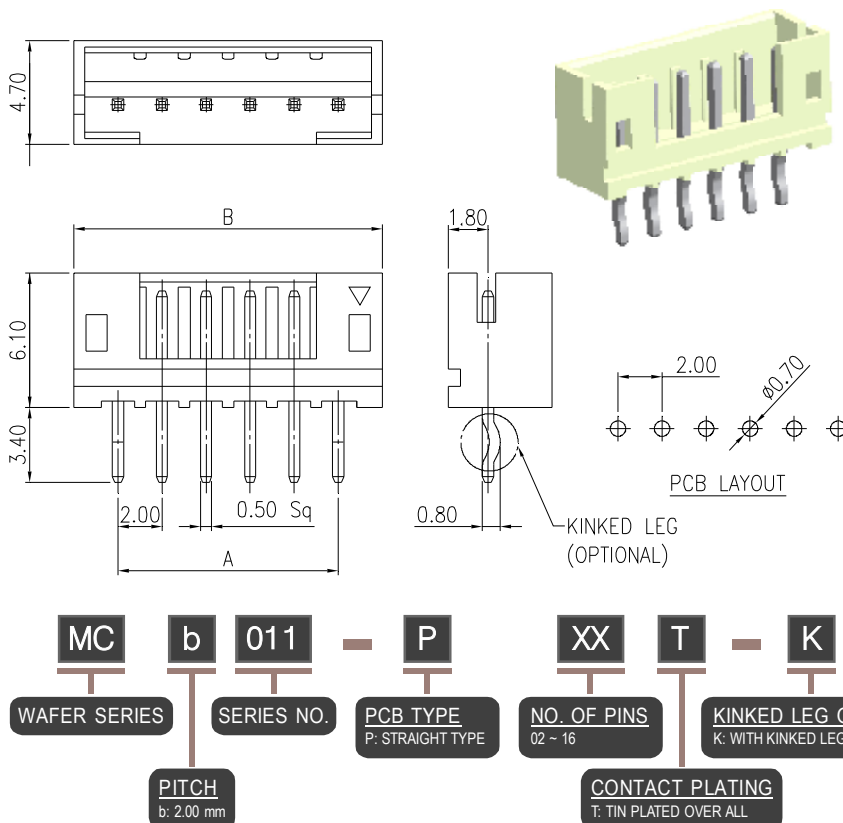

### SPECIFICATIONS

VOLTAGE RATING: 100V AC/DC  
 CURRENT RATING: 12A AC/DC  
 INSULATOR RESISTANCE: 1000M OHM MIN.  
 WITHSTAND VOLTAGE: 800V AC/MINUTE  
 CONTACT RESISTANCE: 20m OHM MAX.  
 TEMPERATURE RANGE: -25°C ~ +85°C

### MATERIALS

CONTACT: BRASS, TIN PLATED  
 BASE: NYLON 46, UL 94V-0

| MATING CONNECTOR |             |
|------------------|-------------|
| PRODUCT          | PART NO.    |
| HOUSING          | MCb001-__-H |
| TERMINAL         | MCb001-T    |

| PART NO.    | CONTACTS | DIMENSION |       |
|-------------|----------|-----------|-------|
|             |          | A         | B     |
| MCb011-P02T | 2        | 2.00      | 6.00  |
| MCb011-P03T | 3        | 4.00      | 8.00  |
| MCb011-P04T | 4        | 6.00      | 10.00 |
| MCb011-P05T | 5        | 8.00      | 12.00 |
| MCb011-P06T | 6        | 10.00     | 14.00 |
| MCb011-P07T | 7        | 12.00     | 16.00 |
| MCb011-P08T | 8        | 14.00     | 18.00 |
| MCb011-P09T | 9        | 16.00     | 20.00 |
| MCb011-P10T | 10       | 18.00     | 22.00 |
| MCb011-P11T | 11       | 20.00     | 24.00 |
| MCb011-P12T | 12       | 22.00     | 26.00 |
| MCb011-P13T | 13       | 24.00     | 28.00 |
| MCb011-P14T | 14       | 26.00     | 30.00 |
| MCb011-P15T | 15       | 28.00     | 32.00 |
| MCb011-P16T | 16       | 30.00     | 34.00 |

NOTE : SOME SIZES, STYLES AND OPTION ARE NON-STANDARD, NON-CANCELLABLE, NON-RETURNABLE

## 2.00 mm HOUSING - MCb 001

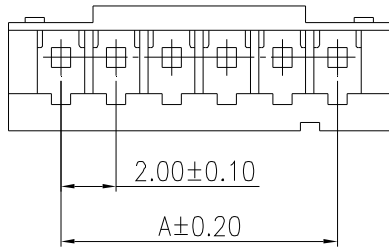

| MATING CONNECTOR |               |
|------------------|---------------|
| PRODUCT          | PART NO.      |
| WAFER            | MCb001 SERIES |
| TERMINAL         | MCb001-T      |

### SPECIFICATIONS

VOLTAGE RATING: 100V AC/DC  
 CURRENT RATING: 1A AC/DC  
 WITHSTAND VOLTAGE: 800V AC/MINUTE  
 INSULATOR RESISTANCE: 1000M OHM MIN.  
 TEMPERATURE RANGE: -25°C ~ +85°C  
 CONTACT RESISTANCE: 20m OHM MAX.

### MATERIALS

BASE: NYLON 66, UL 94V-0

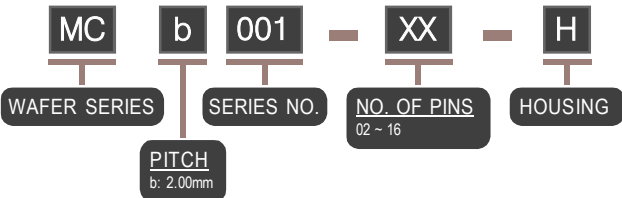
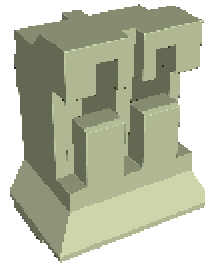
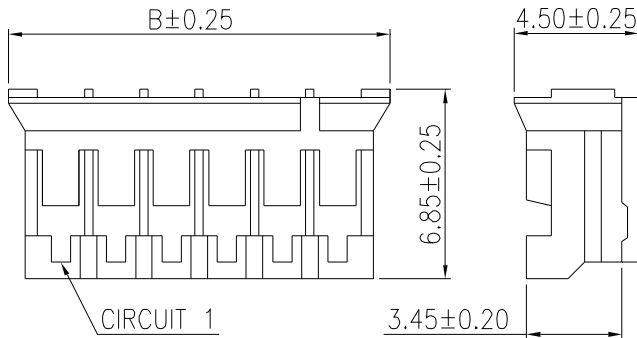

| PART NO.    | CIRCUITS | DIMENSION |       |
|-------------|----------|-----------|-------|
|             |          | A         | B     |
| MCb001-02-H | 2        | 2.00      | 5.80  |
| MCb001-03-H | 3        | 4.00      | 7.80  |
| MCb001-04-H | 4        | 6.00      | 9.80  |
| MCb001-05-H | 5        | 8.00      | 11.80 |
| MCb001-06-H | 6        | 10.00     | 13.80 |
| MCb001-07-H | 7        | 12.00     | 15.80 |
| MCb001-08-H | 8        | 14.00     | 17.80 |
| MCb001-09-H | 9        | 16.00     | 19.80 |
| MCb001-10-H | 10       | 18.00     | 21.80 |
| MCb001-11-H | 11       | 20.00     | 23.80 |
| MCb001-12-H | 12       | 22.00     | 25.80 |
| MCb001-13-H | 13       | 24.00     | 27.80 |
| MCb001-14-H | 14       | 26.00     | 29.80 |
| MCb001-15-H | 15       | 28.00     | 31.80 |
| MCb001-16-H | 16       | 30.00     | 33.80 |

## 2.00 X 2.00 mm HOUSING - MCb 002

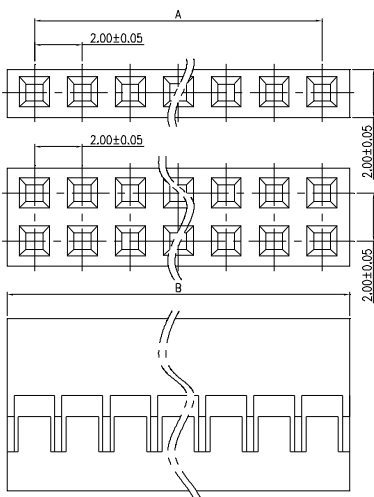

### SPECIFICATIONS

VOLTAGE RATING: 250V AC/DC  
 CURRENT RATING: 3A AC/DC  
 WITHSTAND VOLTAGE: 1000V AC/MINUTE  
 INSULATOR RESISTANCE: 1000M OHM MIN.  
 TEMPERATURE RANGE: -25°C ~ +85°C  
 (INC. TEMPERATURE RSIE IN APPLYING ELECTRICAL CURRENT)  
 CONTACT RESISTANCE: INITIAL VALUE 20m OHM MAX.

### MATERIALS

BASE: NYLON 66, UL 94V-0

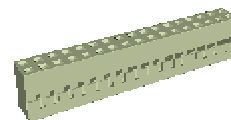

| MATING CONNECTOR |             |
|------------------|-------------|
| PRODUCT          | PART NO.    |
| HEADER           | PHb SERIES  |
| BOX HEADER       | RPHb SERIES |
| TERMINAL         | MCb002-T    |

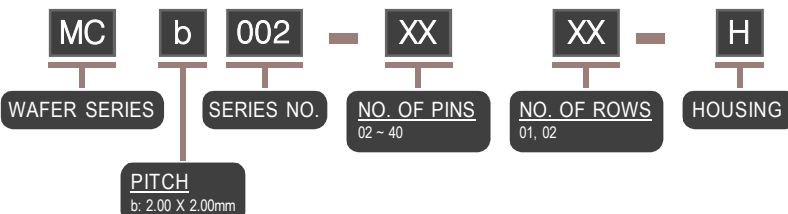

| PART NO.    | CIRCUITS | DIMENSION |       |
|-------------|----------|-----------|-------|
|             |          | A         | B     |
| MCb002-02-H | X2       | 2.00      | 4.30  |
| MCb002-03-H | X3       | 4.00      | 6.30  |
| MCb002-04-H | X4       | 6.00      | 8.30  |
| MCb002-05-H | X5       | 8.00      | 10.30 |
| MCb002-06-H | X6       | 10.00     | 12.30 |
| MCb002-07-H | X7       | 12.00     | 14.30 |
| MCb002-08-H | X8       | 14.00     | 16.30 |
| MCb002-09-H | X9       | 16.00     | 18.30 |
| MCb002-10-H | X10      | 18.00     | 20.30 |
| MCb002-11-H | X11      | 20.00     | 22.30 |
| MCb002-12-H | X12      | 22.00     | 24.30 |
| MCb002-13-H | X13      | 24.00     | 26.30 |
| MCb002-14-H | X14      | 26.00     | 28.30 |
| MCb002-15-H | X15      | 28.00     | 30.30 |
| MCb002-16-H | X16      | 30.00     | 32.30 |
| MCb002-17-H | X17      | 32.00     | 34.30 |
| MCb002-18-H | X18      | 34.00     | 36.30 |
| MCb002-19-H | X19      | 36.00     | 38.30 |
| MCb002-20-H | X20      | 38.00     | 40.30 |
| MCb002-21-H | X21      | 40.00     | 42.30 |
| MCb002-22-H | X22      | 42.00     | 44.30 |
| MCb002-23-H | X23      | 44.00     | 46.30 |
| MCb002-24-H | X24      | 46.00     | 48.30 |
| MCb002-25-H | X25      | 48.00     | 50.30 |
| MCb002-26-H | X26      | 50.00     | 52.30 |
| MCb002-27-H | X27      | 52.00     | 54.30 |
| MCb002-28-H | X28      | 54.00     | 56.30 |
| MCb002-29-H | X29      | 56.00     | 58.30 |
| MCb002-30-H | X30      | 58.00     | 60.30 |
| MCb002-31-H | X31      | 60.00     | 62.30 |
| MCb002-32-H | X32      | 62.00     | 64.30 |
| MCb002-33-H | X33      | 64.00     | 66.30 |
| MCb002-34-H | X34      | 66.00     | 68.30 |
| MCb002-35-H | X35      | 68.00     | 70.30 |
| MCb002-36-H | X36      | 70.00     | 72.30 |
| MCb002-37-H | X37      | 72.00     | 74.30 |
| MCb002-38-H | X38      | 74.00     | 76.30 |
| MCb002-39-H | X39      | 76.00     | 78.30 |
| MCb002-40-H | X40      | 78.00     | 80.30 |

NOTE : SOME SIZES, STYLES AND OPTION ARE NON-STANDARD, NON-CANCELLABLE, NON-RETURNABLE

## 2.00 X 2.00 mm HOUSING - MCb 004

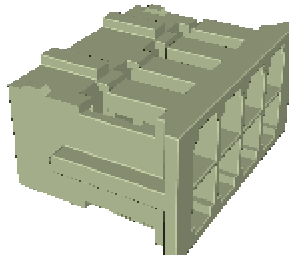
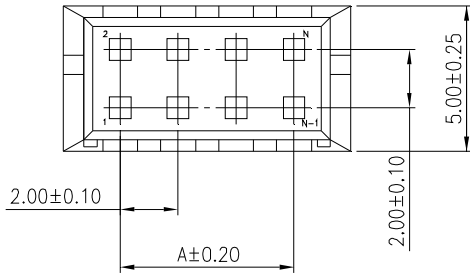

### SPECIFICATIONS

VOLTAGE RATING: 100V AC/DC  
 CURRENT RATING: 1A AC/DC  
 WITHSTAND VOLTAGE: 800V AC/MINUTE  
 INSULATOR RESISTANCE: 1000M OHM MIN.  
 TEMPERATURE RANGE: -25°C ~ +85°C  
 CONTACT RESISTANCE: 20m OHM MAX.

### MATERIALS

BASE: NYLON 66, UL 94V-0

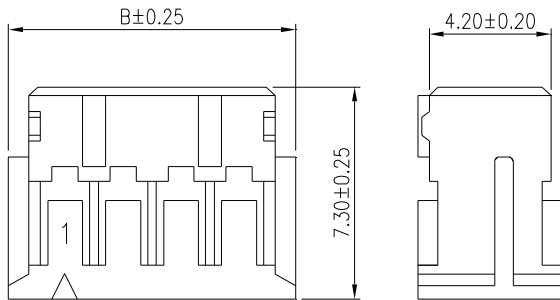

| MATING CONNECTOR |                |
|------------------|----------------|
| PRODUCT          | PART NO.       |
| WAFER            | MCb004-Pa__02T |
| TERMINAL         | MCb004-T       |

| PART NO.      | CIRCUITS | DIMENSION |       |
|---------------|----------|-----------|-------|
|               |          | A         | B     |
| MCb004-0202-H | 2X2      | 2.00      | 5.90  |
| MCb004-0302-H | 2X3      | 4.00      | 7.90  |
| MCb004-0402-H | 2X4      | 6.00      | 9.90  |
| MCb004-0502-H | 2X5      | 8.00      | 11.90 |
| MCb004-0602-H | 2X6      | 10.00     | 13.90 |
| MCb004-0702-H | 2X7      | 12.00     | 15.90 |
| MCb004-0802-H | 2X8      | 14.00     | 17.90 |
| MCb004-0902-H | 2X9      | 16.00     | 19.90 |
| MCb004-1002-H | 2X10     | 18.00     | 21.90 |
| MCb004-1102-H | 2X11     | 20.00     | 23.90 |
| MCb004-1202-H | 2X12     | 22.00     | 25.90 |
| MCb004-1302-H | 2X13     | 24.00     | 27.90 |
| MCb004-1402-H | 2X14     | 26.00     | 29.90 |
| MCb004-1502-H | 2X15     | 28.00     | 31.90 |
| MCb004-1602-H | 2X16     | 30.00     | 33.90 |
| MCb004-1702-H | 2X17     | 32.00     | 35.90 |
| MCb004-1802-H | 2X18     | 34.00     | 37.90 |
| MCb004-1902-H | 2X19     | 36.00     | 39.90 |
| MCb004-2002-H | 2X20     | 38.00     | 41.90 |

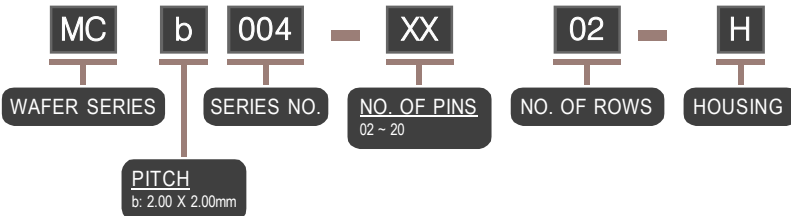

## 2.00 X 2.00 mm HOUSING - MCb 005

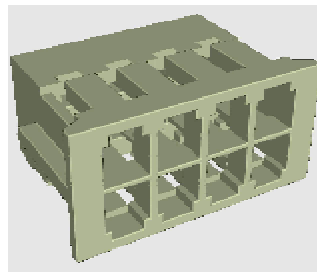
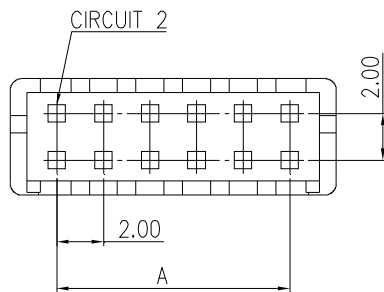

### SPECIFICATIONS

VOLTAGE RATING: 130V AC/DC  
 CURRENT RATING: 1A AC/DC  
 WITHSTAND VOLTAGE: 800V AC/MINUTE  
 INSULATOR RESISTANCE: 1000M OHM MIN.  
 TEMPERATURE RANGE: -25°C ~ +85°C  
 CONTACT RESISTANCE: 20m OHM MAX.

### MATERIALS

BASE: NYLON 66, UL 94V-0

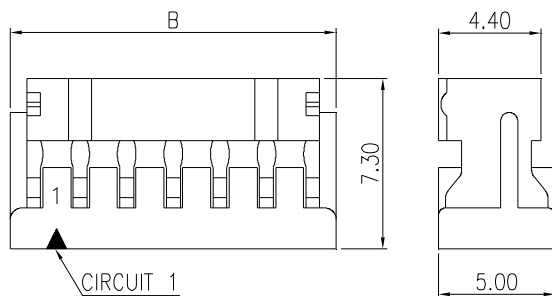

| MATING CONNECTOR |               |
|------------------|---------------|
| PRODUCT          | PART NO.      |
| WAFER            | MCb005 SERIES |
| TERMINAL         | MCb001-T      |

| PART NO.      | CIRCUITS | DIMENSION |       |
|---------------|----------|-----------|-------|
|               |          | A         | B     |
| MCb005-0202-H | 2X2      | 2.00      | 6.00  |
| MCb005-0302-H | 2X3      | 4.00      | 8.00  |
| MCb005-0402-H | 2X4      | 6.00      | 10.00 |
| MCb005-0502-H | 2X5      | 8.00      | 12.00 |
| MCb005-0602-H | 2X6      | 10.00     | 14.00 |
| MCb005-0702-H | 2X7      | 12.00     | 16.00 |
| MCb005-0802-H | 2X8      | 14.00     | 18.00 |
| MCb005-0902-H | 2X9      | 16.00     | 20.00 |
| MCb005-1002-H | 2X10     | 18.00     | 22.00 |
| MCb005-1102-H | 2X11     | 20.00     | 24.00 |
| MCb005-1202-H | 2X12     | 22.00     | 26.00 |
| MCb005-1302-H | 2X13     | 24.00     | 28.00 |
| MCb005-1402-H | 2X14     | 26.00     | 30.00 |
| MCb005-1502-H | 2X15     | 28.00     | 32.00 |
| MCb005-1602-H | 2X16     | 30.00     | 34.00 |
| MCb005-1702-H | 2X17     | 32.00     | 36.00 |
| MCb005-1802-H | 2X18     | 34.00     | 38.00 |
| MCb005-1902-H | 2X19     | 36.00     | 40.00 |
| MCb005-2002-H | 2X20     | 38.00     | 42.00 |

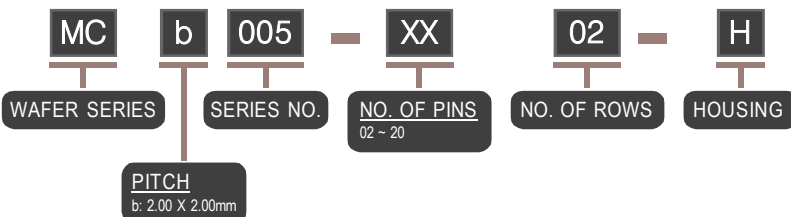

NOTE : SOME SIZES, STYLES AND OPTION ARE NON-STANDARD, NON-CANCELLABLE, NON-RETURNABLE

## 2.00 mm HOUSING - MCb 006

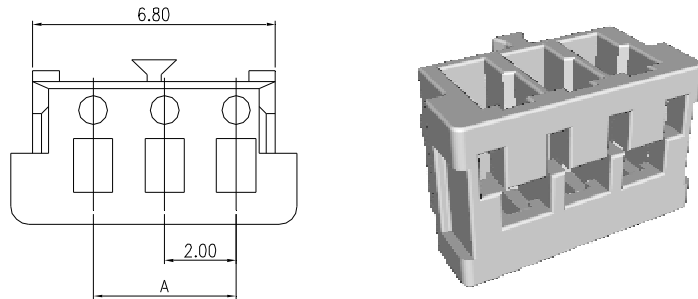

### SPECIFICATIONS

VOLTAGE RATING: 100V AC/DC  
 CURRENT RATING: 1A AC/DC  
 WITHSTAND VOLTAGE: 800V AC/MINUTE  
 INSULATOR RESISTANCE: 1000M OHM MIN.  
 TEMPERATURE RANGE: -25°C ~ +85°C  
 CONTACT RESISTANCE: 20m OHM MAX.

### MATERIALS

BASE: NYLON 66, UL 94V-0

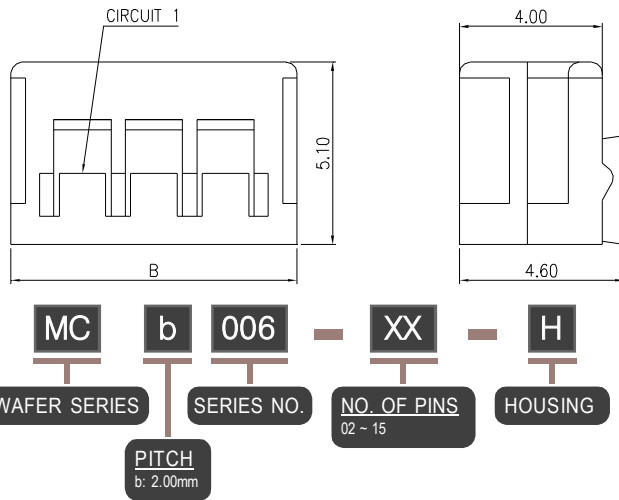

| MATING CONNECTOR |               |
|------------------|---------------|
| PRODUCT          | PART NO.      |
| WAFER            | MCb006 SERIES |
| TERMINAL         | MCb006-T      |

| PART NO.    | CIRCUITS | DIMENSION |       |
|-------------|----------|-----------|-------|
|             |          | A         | B     |
| MCb006-02-H | 2        | 2.00      | 6.00  |
| MCb006-03-H | 3        | 4.00      | 8.00  |
| MCb006-04-H | 4        | 6.00      | 10.00 |
| MCb006-05-H | 5        | 8.00      | 12.00 |
| MCb006-06-H | 6        | 10.00     | 14.00 |
| MCb006-07-H | 7        | 12.00     | 16.00 |
| MCb006-08-H | 8        | 14.00     | 18.00 |
| MCb006-09-H | 9        | 16.00     | 20.00 |
| MCb006-10-H | 10       | 18.00     | 22.00 |
| MCb006-11-H | 11       | 20.00     | 24.00 |
| MCb006-12-H | 12       | 22.00     | 26.00 |
| MCb006-13-H | 13       | 24.00     | 28.00 |
| MCb006-14-H | 14       | 26.00     | 30.00 |
| MCb006-15-H | 15       | 28.00     | 32.00 |

## 2.00 mm HOUSING - MCb 007

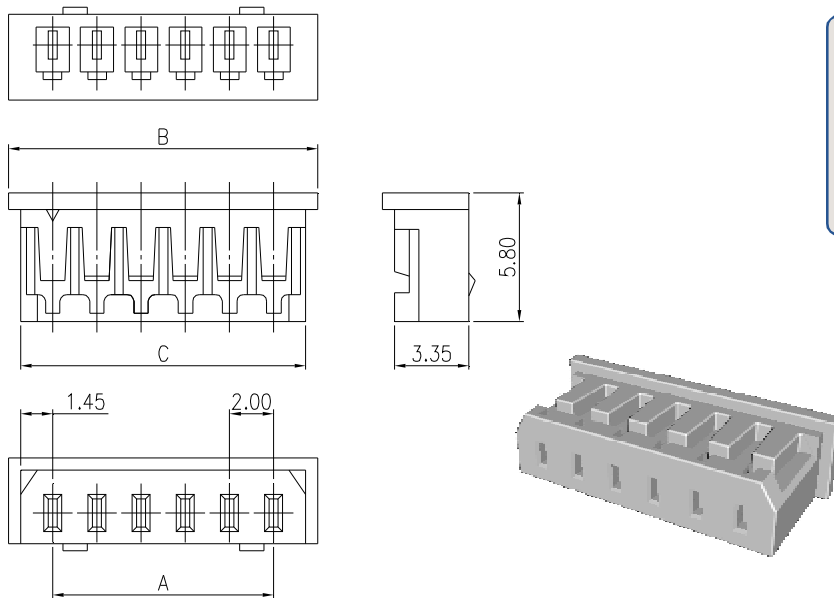

### SPECIFICATIONS

CURRENT RATING: 1A AC/DC  
 WITHSTAND VOLTAGE: 800V AC/MINUTE  
 INSULATOR RESISTANCE: 1000M OHM MIN.  
 TEMPERATURE RANGE: -25°C ~ +85°C  
 CONTACT RESISTANCE: 20m OHM MAX.

### MATERIALS

BASE: NYLON 66, UL 94V-0



| MATING CONNECTOR |               |
|------------------|---------------|
| PRODUCT          | PART NO.      |
| WAFER            | MCb007 SERIES |
| TERMINAL         | MCb007-T      |

| PART NO.    | CONTACTS | DIMENSION |       |       |
|-------------|----------|-----------|-------|-------|
|             |          | A         | B     | C     |
| MCb007-02-H | 2        | 2.00      | 6.00  | 4.90  |
| MCb007-03-H | 3        | 4.00      | 8.00  | 6.90  |
| MCb007-04-H | 4        | 6.00      | 10.00 | 8.90  |
| MCb007-05-H | 5        | 8.00      | 12.00 | 10.90 |
| MCb007-06-H | 6        | 10.00     | 14.00 | 12.90 |
| MCb007-07-H | 7        | 12.00     | 16.00 | 14.90 |
| MCb007-08-H | 8        | 14.00     | 18.00 | 16.90 |
| MCb007-09-H | 9        | 16.00     | 20.00 | 18.90 |
| MCb007-10-H | 10       | 18.00     | 22.00 | 20.90 |
| MCb007-11-H | 11       | 20.00     | 24.00 | 22.90 |
| MCb007-12-H | 12       | 22.00     | 26.00 | 24.90 |
| MCb007-13-H | 13       | 24.00     | 28.00 | 26.90 |
| MCb007-14-H | 14       | 26.00     | 30.00 | 28.90 |
| MCb007-15-H | 15       | 28.00     | 32.00 | 30.90 |

NOTE : SOME SIZES, STYLES AND OPTION ARE NON-STANDARD, NON-CANCELLABLE, NON-RETURNABLE