

**MMI**

---

**WAFER, HOUSING & TERMINAL  
PITCH: 1.00x1.00mm**

---

## TERMINAL- MCe 001

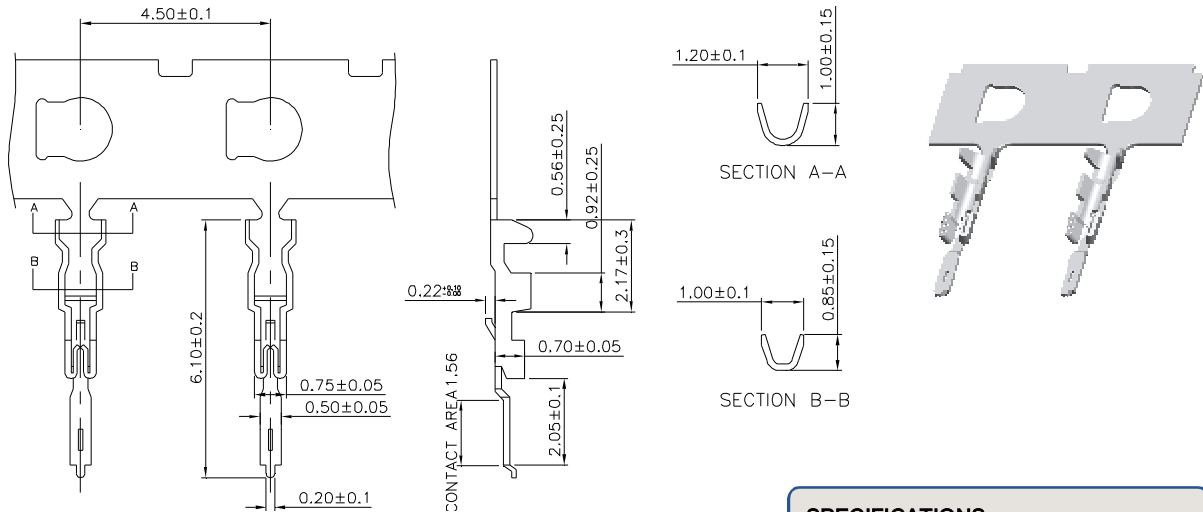

**MC**   **e**   **001**   -   **T**  
 WAFER SERIES   SERIES NO.   TERMINAL  
 MATING HOUSING PITCH  
 e: 1.00mm

**SPECIFICATIONS**  
 VOLTAGE RATING: 250V AC/DC  
 CURRENT RATING: 1A AC/DC  
 WITHSTAND VOLTAGE: 500V AC/MINUTE  
 INSULATOR RESISTANCE: 100M OHM MIN.  
 CONTACT RESISTANCE: 40m OHM MAX.  
 APPLICABLE WIRES: AWG #28 ~ #32  
 PLATING LENGTH >= 1.56mm

**MATERIALS**  
 BASE: COPPET ALLOY  
 FINISH: 0-TIN PLATED OVER NICKEL  
 1-GOLD FLASH 3u" PLATED OVER NICKEL

## TERMINAL- MCe 002

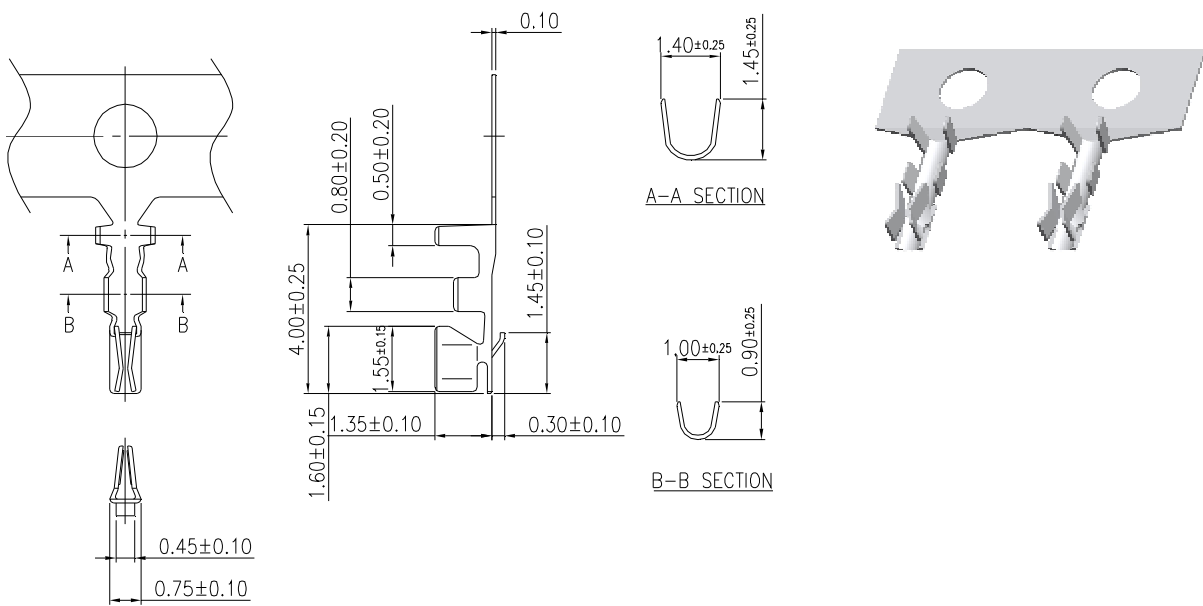

**MC**   **e**   **002**   -   **T**  
 WAFER SERIES   SERIES NO.   TERMINAL  
 MATING HOUSING PITCH  
 e: 1.00mm

WIRE RANGE: AWG #28 - #32  
 INSULATION O.D.: 0.80mm MAX.  
 MATERIAL: PHOSPHOR BRONZE  
 FINISH: TIN PLATED

NOTE : SOME SIZES, STYLES AND OPTION ARE NON-STANDARD, NON-CANCELLABLE, NON-RETURNABLE

# TERMINAL- MCE 004

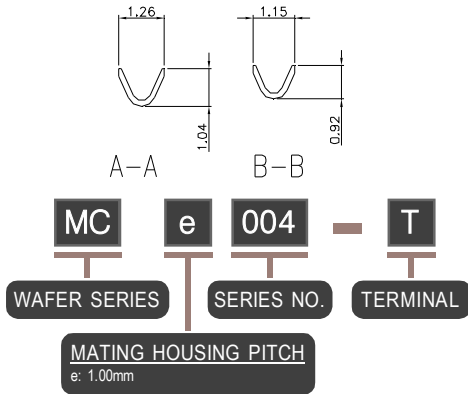
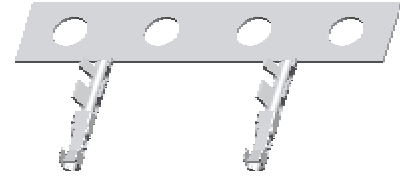
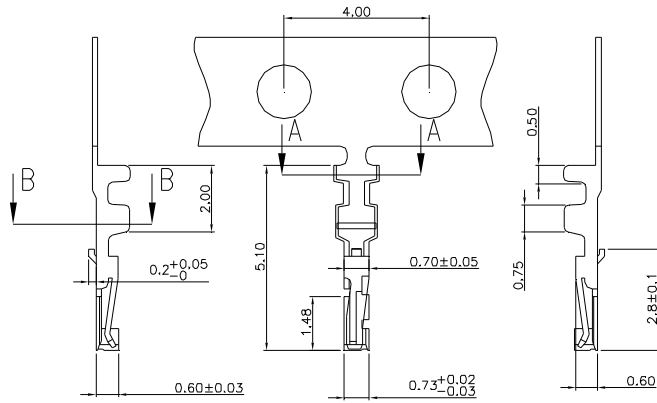

### SPECIFICATIONS

CURRENT: AWG#28 - 1A, AWG#30 - 0.5A, AWG#32 - 0.3A  
 DIELECTRIC WITHSTAND VOLTAGE: 100V AC  
 INSULATOR RESISTANCE: 500M OHM MIN.  
 CONTACT RESISTANCE: 20m OHM MAX.

### MATERIALS

BASE: NYLON, UL94V-0 PHOSPHOR BRONZE, T = 0.15mm  
 FINISH: 0 - TIN PLATED OVER NICKEL  
 1 - 3u" GOLD ON CONTACT AREA, GOLD FLASH ON OTHER AREA, BOTH OVER NICKEL.  
 2 - 3u" GOLD ON CONTACT AREA, OVER NICKEL.

**NOTE** : SOME SIZES, STYLES AND OPTION ARE NON-STANDARD, NON-CANCELLABLE, NON-RETURNABLE

[www.mmtmachrone.com](http://www.mmtmachrone.com)

USA TEL : 1-510-979-2188  
 FAX : 1-510-979-2189

TAIWAN TEL : 886-2-2755-3193  
 FAX : 886-2-2784-5109

SINGAPORE TEL : 65-6274-0566  
 FAX : 65-6274-7891

# 1.00 mm WAFER - MCE 001 RIGHT ANGLE SURFACE MOUNT TYPE - Rt

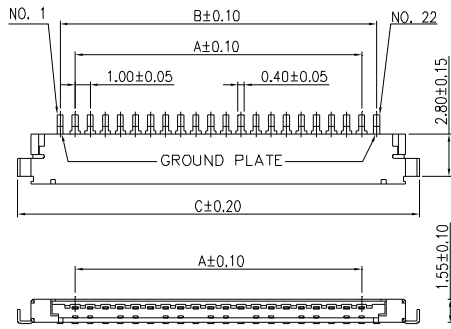

MATING CONNECTOR	
PRODUCT	PART NO.
HOUSING	MCE001-__-H
TERMINAL	MCE001-T

### SPECIFICATIONS

VOLTAGE RATING: 200V AC/DC  
 CURRENT RATING: 1A AC/DC  
 WITHSTAND VOLTAGE: 500V AC/MINUTE  
 INSULATOR RESISTANCE: 100M OHM MIN.  
 TEMPERATURE RANGE: -40°C ~ +85°C

### MATERIALS

CONTACT: PHOSPHOR BRONZE, TIN PLATED.  
 BODY: NYLON 6T, UL94V-0  
 SHELL: BRASS, TIN PLATED

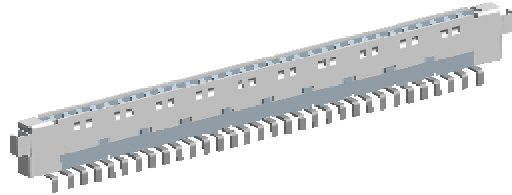
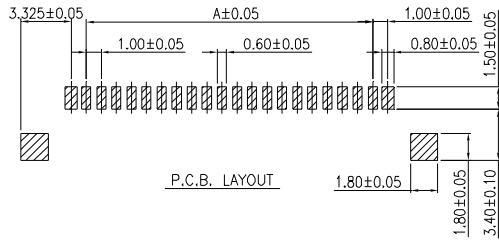

<b>MC</b>	<b>e</b>	<b>001</b>	-	<b>Rt</b>	<b>XX</b>	<b>T</b>
WAFER SERIES	PITCH e: 1.00mm	SERIES NO.		PCB TYPE Rt: RIGHT ANGLE SURFACE MOUNT TYPE	NO. OF PINS 20, 30	CONTACT PLATING T: TIN PLATED OVER ALL

PART NO.	CONTACTS	DIMENSION		
		A	B	C
MCE001-Rt20T	20	19.00	21.00	26.64
MCE001-Rt30T	30	29.00	31.00	36.65

# 1.00 mm WAFER - MCE 002 SURFACE MOUNT TYPE - Pt

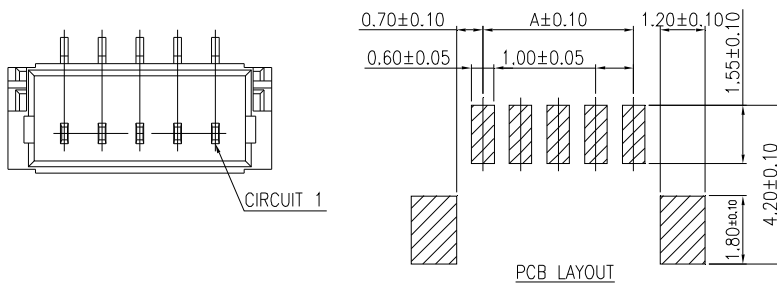

### SPECIFICATIONS

VOLTAGE RATING: 50V AC/DC  
 CURRENT RATING: 1A AC/DC  
 WITHSTAND VOLTAGE: 500V AC/MINUTE  
 INSULATOR RESISTANCE: 500M OHM MIN.  
 CONTACT RESISTANCE: 20m OHM MAX.  
 TEMPERATURE RANGE: -25°C ~ +85°C

### MATERIALS

CONTACT: BRASS, TIN PLATED  
 SOLDER TABS: BRASS, TIN PLATED  
 BASE: NYLON 6T, UL 94V-0

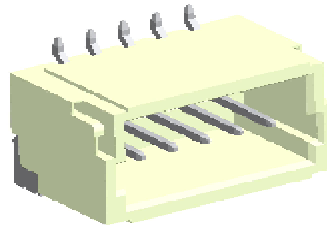
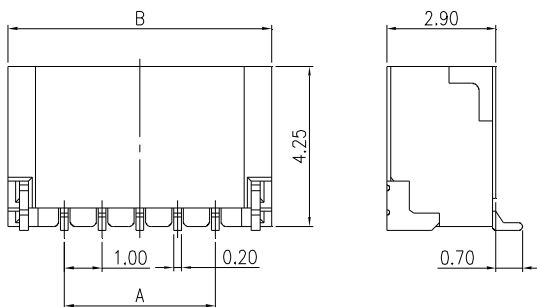

MATING CONNECTOR	
PRODUCT	PART NO.
HOUSING	MCE002 SERIES MCE003 SERIES
TERMINAL	MCE002-T

<b>MC</b>	<b>e</b>	<b>002</b>	-	<b>Pt</b>	<b>XX</b>	<b>T</b>
WAFER SERIES	PITCH e: 1.00mm	SERIES NO.		PCB TYPE Pt: SURFACE MOUNT TYPE	NO. OF PINS 02 ~ 15, 20	CONTACT PLATING T: TIN PLATED OVER ALL

PART NO.	CONTACTS	DIMENSION	
		A	B
MCE002-Pt02T	2	1.00	4.00
MCE002-Pt03T	3	2.00	5.00
MCE002-Pt04T	4	3.00	6.00
MCE002-Pt05T	5	4.00	7.00
MCE002-Pt06T	6	5.00	8.00
MCE002-Pt07T	7	6.00	9.00
MCE002-Pt08T	8	7.00	10.00
MCE002-Pt09T	9	8.00	11.00
MCE002-Pt10T	10	9.00	12.00
MCE002-Pt11T	11	10.00	13.00
MCE002-Pt12T	12	11.00	14.00
MCE002-Pt13T	13	12.00	15.00
MCE002-Pt14T	14	13.00	16.00
MCE002-Pt15T	15	14.00	17.00
MCE002-Pt20T	20	19.00	22.00

NOTE : SOME SIZES, STYLES AND OPTION ARE NON-STANDARD, NON-CANCELLABLE, NON-RETURNABLE

# 1.00 X 1.00 mm WAFER - MCe 002 SURFACE MOUNT TYPE - Pt (2 ROWS)

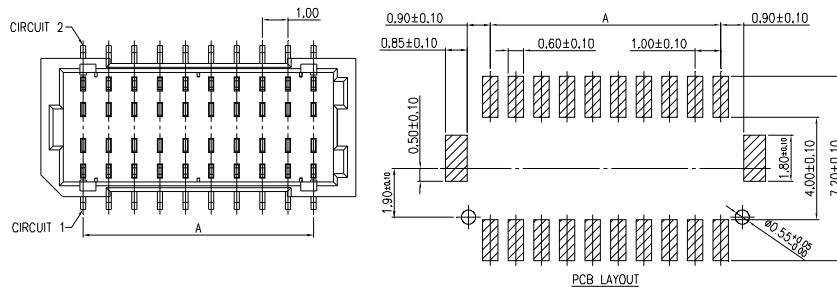

**SPECIFICATIONS**  
 VOLTAGE RATING: 50V AC/DC  
 CURRENT RATING: 1A AC/DC  
 WITHSTAND VOLTAGE: 500V AC/MINUTE  
 INSULATOR RESISTANCE: 500M OHM MIN.  
 CONTACT RESISTANCE: 20m OHM MAX.  
 TEMPERATURE RANGE: -25°C ~ +85°C

**MATERIALS**  
 CONTACT: BRASS, TIN PLATED  
 SOLDER TABS: BRASS, TIN PLATED  
 BASE: NYLON 6T, UL 94V-0

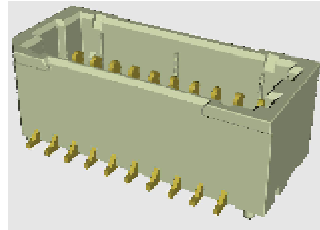
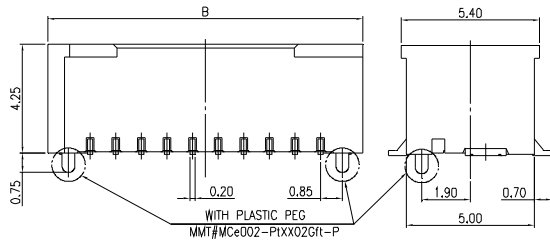

MATING CONNECTOR	
PRODUCT	PART NO.
HOUSING	MCe002-__02-H
TERMINAL	MCe002-T

PART NO.	CONTACTS	DIMENSION	
		A	B
MCe002-PT1002Gft	10	9.00	12.30
MCe002-PT1502Gft	15	14.00	17.30
MCe002-PT2002Gft	20	19.00	22.30
MCe002-PT2502Gft	25	24.00	27.30

<b>MC</b>	<b>e</b>	<b>002</b>	-	<b>Pt</b>	<b>XX</b>	<b>02</b>		<b>Gft</b>	-	<b>X</b>
<b>WAFER SERIES</b>	<b>PITCH</b> e: 1.00 X 1.00mm	<b>SERIES NO.</b>		<b>PCB TYPE</b> Pt: SURFACE MOUNT TYPE	<b>NO. OF PINS</b> 10, 15, 20, 25	<b>NO. OF ROWS</b>		<b>CONTACT PLATING</b> Gft: GOLD FLASH ON CONTACT, TIN PLATING ON SOLDER TAIL		<b>PLASTIC PEG OPTION</b> BLANK: WITHOUT PLASTIC PEG P: WITH PLASTIC PEG

# 1.00 mm WAFER - MCe 002 RIGHT ANGLE SURFACE MOUNT TYPE - Rt

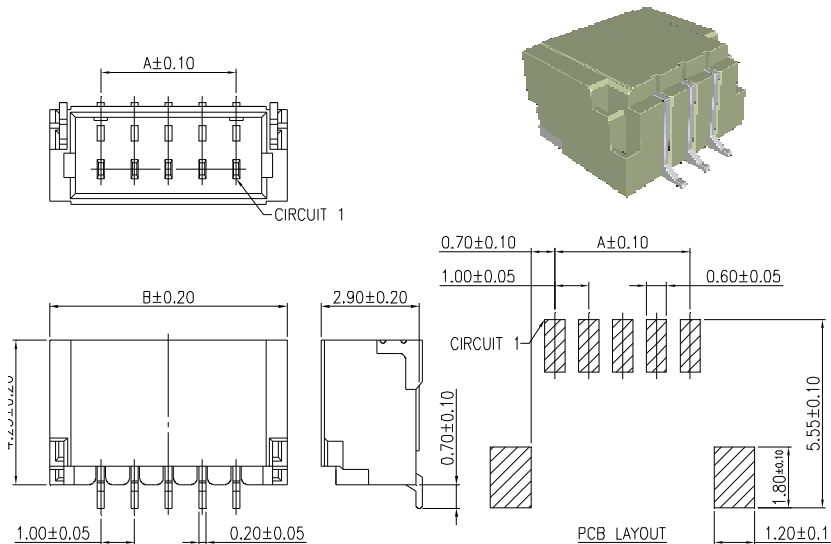

**SPECIFICATIONS**  
 VOLTAGE RATING: 50V AC/DC  
 CURRENT RATING: 1A AC/DC  
 WITHSTAND VOLTAGE: 500V AC/MINUTE  
 INSULATOR RESISTANCE: 500M OHM MIN.  
 TEMPERATURE RANGE: -25°C ~ +85°C

**MATERIALS**  
 CONTACT: BRASS, TIN PLATED.  
 BODY: NYLON 6T, UL94V-0  
 SOLDER TABS: BRASS, TIN PLATED

MATING CONNECTOR	
PRODUCT	PART NO.
HOUSING	MCe002 SERIES MCe003 SERIES
TERMINAL	MCe002-T

PART NO.	CONTACTS	DIMENSION	
		A	B
MCe002-Rt02T	2	1.00	4.00
MCe002-Rt03T	3	2.00	5.00
MCe002-Rt04T	4	3.00	6.00
MCe002-Rt05T	5	4.00	7.00
MCe002-Rt06T	6	5.00	8.00
MCe002-Rt07T	7	6.00	9.00
MCe002-Rt08T	8	7.00	10.00
MCe002-Rt09T	9	8.00	11.00
MCe002-Rt10T	10	9.00	12.00
MCe002-Rt11T	11	10.00	13.00
MCe002-Rt12T	12	11.00	14.00
MCe002-Rt13T	13	12.00	15.00
MCe002-Rt14T	14	13.00	16.00
MCe002-Rt15T	15	14.00	17.00
MCe002-Rt20T	20	19.00	22.00

<b>MC</b>	<b>e</b>	<b>002</b>	-	<b>Rt</b>	<b>XX</b>	<b>T</b>
<b>WAFER SERIES</b>	<b>PITCH</b> e: 1.00mm	<b>SERIES NO.</b>		<b>PCB TYPE</b> Rt: RIGHT ANGLE SURFACE MOUNT TYPE	<b>NO. OF PINS</b> 02 - 15, 20	<b>CONTACT PLATING</b> T: TIN PLATED OVER ALL

NOTE : SOME SIZES, STYLES AND OPTION ARE NON-STANDARD, NON-CANCELLABLE, NON-RETURNABLE

# 1.00 X 1.00 mm WAFER - MCe 002 RIGHT ANGLE SURFACE MOUNT TYPE - Rt (2 ROWS)

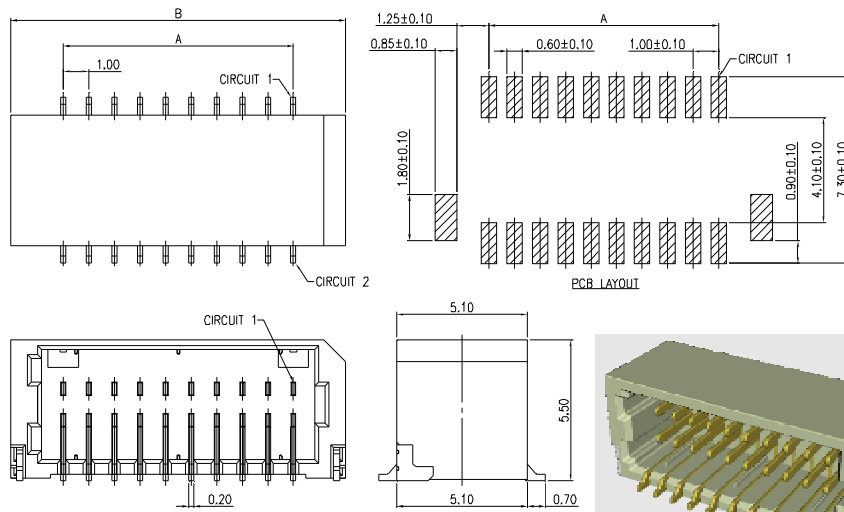

### SPECIFICATIONS

VOLTAGE RATING: 50V AC/DC  
 CURRENT RATING: 1A AC/DC  
 WITHSTAND VOLTAGE: 500V AC/MINUTE  
 INSULATOR RESISTANCE: 500M OHM MIN.  
 CONTACT RESISTANCE: 20m OHM MAX.  
 TEMPERATURE RANGE: -25°C ~ +85°C

### MATERIALS

CONTACT: BRASS, TIN PLATED  
 SOLDER TABS: BRASS, TIN PLATED  
 BASE: NYLON 6T, UL 94V-0

MATING CONNECTOR	
PRODUCT	PART NO.
HOUSING	MCe002-__02-H
TERMINAL	MCe002-T

PART NO.	CONTACTS	DIMENSION	
		A	B
MCe002-Rt1002Gft	10	9.00	12.30
MCe002-Rt1502Gft	15	14.00	17.30
MCe002-Rt2002Gft	20	19.00	22.30
MCe002-Rt2502Gft	25	24.00	27.30

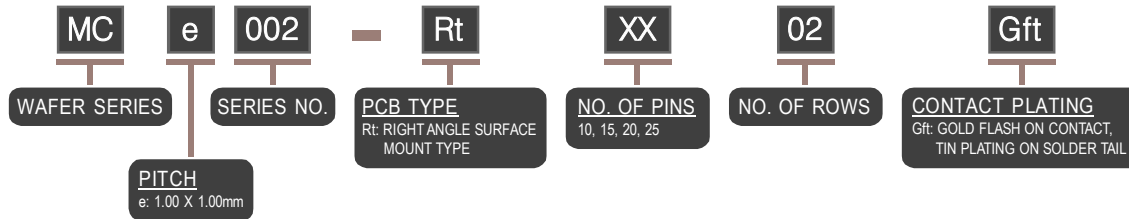

**NOTE** : SOME SIZES, STYLES AND OPTION ARE NON-STANDARD, NON-CANCELLABLE, NON-RETURNABLE  
**NOTE** : SOME SIZES, STYLES AND OPTION ARE NON-STANDARD, NON-CANCELLABLE, NON-RETURNABLE

## 1.00 mm HOUSING - MCE 001

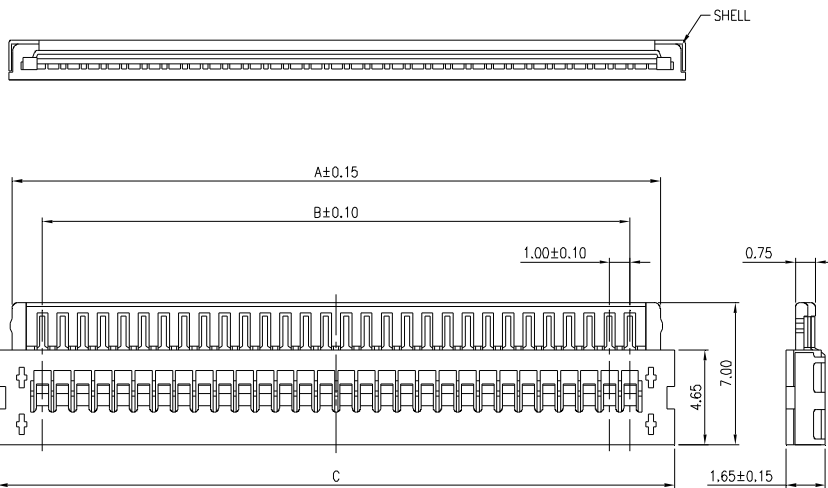

### MATERIALS

BASE: NYLON, UL 94V-0  
SHELL: COPPER ALLOY  
SHELL FINISH: TIN/LEAD OVER NICKEL

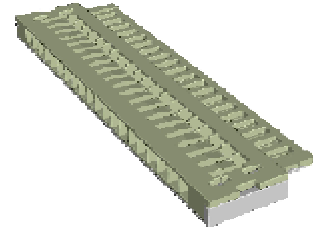

MATING CONNECTOR	
PRODUCT	PART NO.
TERMINAL	MCE001-T

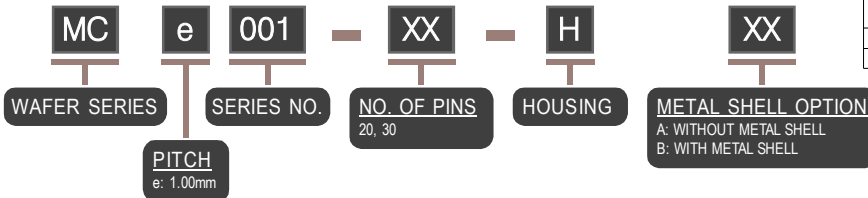

PART NO.	CIRCUITS	DIMENSION		
		A	B	C
MCE001-20-H	20	22.00	19.00	23.40
MCE001-30-H	30	32.00	29.00	33.40

## 1.00 mm HOUSING - MCE 002

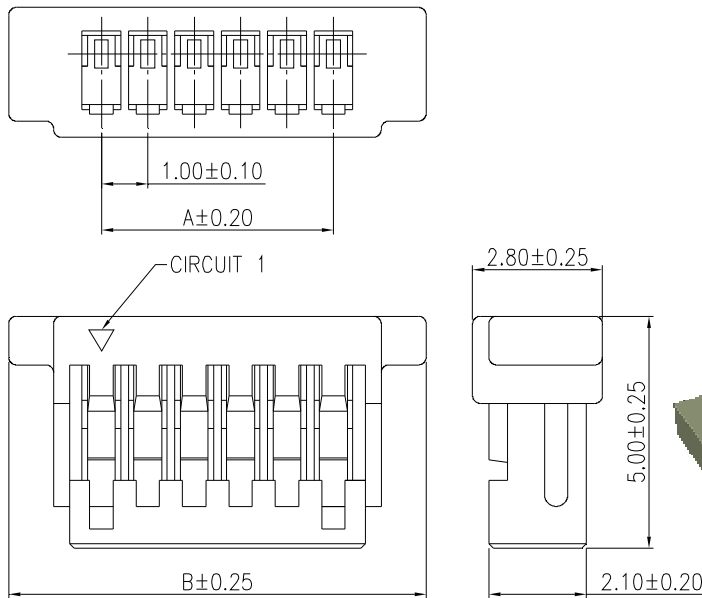

### SPECIFICATIONS

VOLTAGE RATING: 50V AC/DC  
CURRENT RATING: 1A AC/DC  
WITHSTAND VOLTAGE: 500V AC/MINUTE  
TEMPERATURE RANGE: -25°C ~ +85°C  
CONTACT RESISTANCE: 20m OHM MAX.

### MATERIALS

BASE: NYLON 66, UL 94V-0

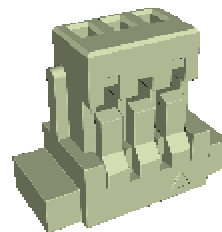

MATING CONNECTOR	
PRODUCT	PART NO.
WAFER	MCE002-Pt__T
	MCE002-Rt__T
TERMINAL	MCE002-T



PART NO.	CIRCUITS	DIMENSION	
		A	B
MCE002-02-H	2	1.00	5.00
MCE002-03-H	3	2.00	6.00
MCE002-04-H	4	3.00	7.00
MCE002-05-H	5	4.00	8.00
MCE002-06-H	6	5.00	9.00
MCE002-07-H	7	6.00	10.00
MCE002-08-H	8	7.00	11.00
MCE002-09-H	9	8.00	12.00
MCE002-10-H	10	9.00	13.00
MCE002-11-H	11	10.00	14.00
MCE002-12-H	12	11.00	15.00
MCE002-13-H	13	12.00	16.00
MCE002-14-H	14	13.00	17.00
MCE002-15-H	15	14.00	18.00
MCE002-20-H	20	19.00	23.00

NOTE : SOME SIZES, STYLES AND OPTION ARE NON-STANDARD, NON-CANCELLABLE, NON-RETURNABLE

## 1.00 X 1.00 mm HOUSING - MCE 002 (2 ROWS)

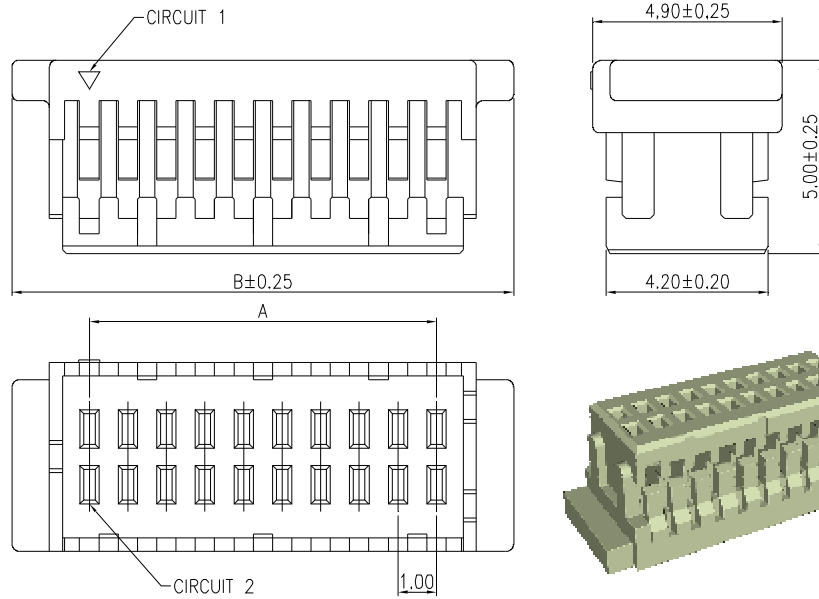

### SPECIFICATIONS

VOLTAGE RATING: 50V AC/DC  
 CURRENT RATING: 1A AC/DC  
 WITHSTAND VOLTAGE: 500V AC/MINUTE  
 TEMPERATURE RANGE: -25°C ~ +85°C  
 CONTACT RESISTANCE: 20m OHM MAX.

### MATERIALS

BASE: NYLON 66, UL 94V-0

MATING CONNECTOR	
PRODUCT	PART NO.
WAFER	MCE002-Pt__T MCE002-Rt__T
TERMINAL	MCE002-T

PART NO.	CONTACTS	DIMENSION	
		A	B
MCE002-1002-H	2X10	9.00	13.00
MCE002-1502-H	2X15	14.00	18.00
MCE002-2002-H	2X20	19.00	23.00
MCE002-2502-H	2X25	24.00	28.00

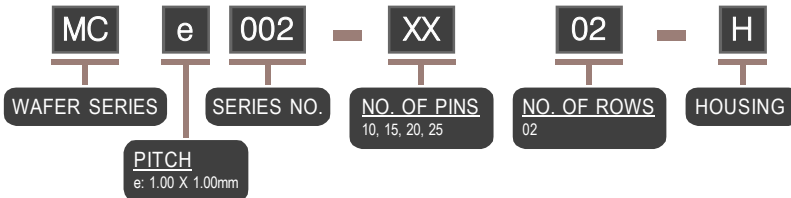

## 1.00 mm HOUSING - MCE 003

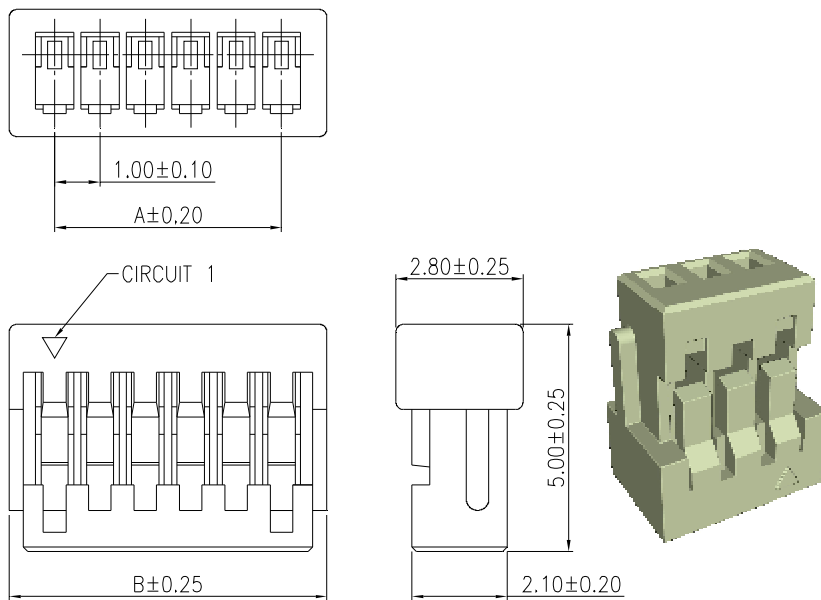

### SPECIFICATIONS

VOLTAGE RATING: 50V AC/DC  
 CURRENT RATING: 1A AC/DC  
 WITHSTAND VOLTAGE: 500V AC/MINUTE  
 TEMPERATURE RANGE: -25°C ~ +85°C  
 CONTACT RESISTANCE: 20m OHM MAX.

### MATERIALS

BASE: NYLON 66, UL 94V-0

MATING CONNECTOR	
PRODUCT	PART NO.
WAFER	MCE002-Pt__T MCE002-Rt__T
TERMINAL	MCE002-T

PART NO.	CIRCUITS	DIMENSION	
		A	B
MCE003-02-H	2	1.00	3.00
MCE003-03-H	3	2.00	4.00
MCE003-04-H	4	3.00	5.00
MCE003-05-H	5	4.00	6.00
MCE003-06-H	6	5.00	7.00
MCE003-07-H	7	6.00	8.00
MCE003-08-H	8	7.00	9.00
MCE003-09-H	9	8.00	10.00
MCE003-10-H	10	9.00	11.00
MCE003-11-H	11	10.00	12.00
MCE003-12-H	12	11.00	13.00
MCE003-13-H	13	12.00	14.00
MCE003-14-H	14	13.00	15.00
MCE003-15-H	15	14.00	16.00
MCE003-20-H	20	19.00	21.00



NOTE : SOME SIZES, STYLES AND OPTION ARE NON-STANDARD, NON-CANCELLABLE, NON-RETURNABLE



# 1.00 mm HOUSING - MCE 004

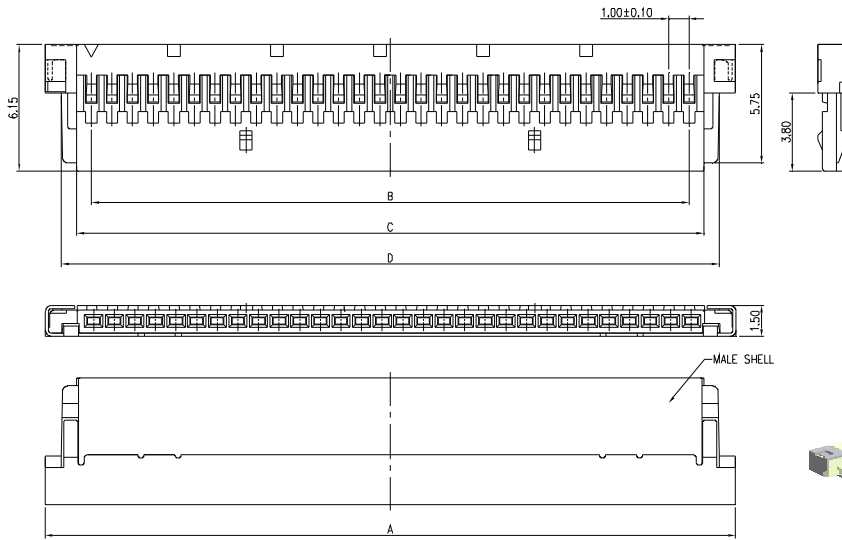

### MATERIALS

BASE: NYLON 46, UL 94V-0  
 SHELL: COPPER ALLOY  
 SHELL FINISH: TIN/LEAD OVER NICKEL

### MATING CONNECTOR

PRODUCT	PART NO.
TERMINAL	MCE004-T

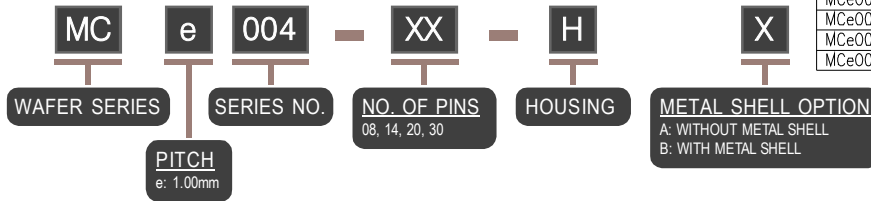
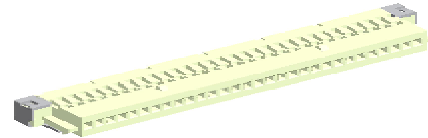

PART NO.	CIRCUITS	DIMENSION			
		A	B	C	D
MCE004-08-H_	08	11.50	7.00	8.44	8.90
MCE004-14-H_	14	17.50	13.00	14.44	11.90
MCE004-20-H_	20	23.50	19.00	20.44	21.90
MCE004-30-H_	30	33.50	29.00	30.44	31.90

**NOTE :** SOME SIZES, STYLES AND OPTION ARE NON-STANDARD, NON-CANCELLABLE, NON-RETURNABLE