

MMI

**WAFER, HOUSING & TERMINAL
PITCH: 1.50x1.50mm**

TERMINAL- MCt 001

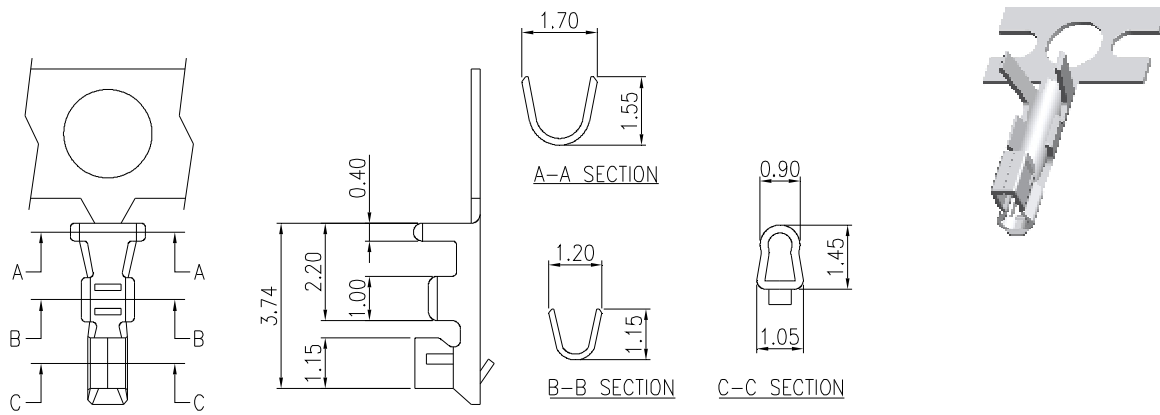

SPECIFICATIONS

VOLTAGE RATING: 250V AC/DC
 CURRENT RATING: 1A AC/DC
 WITHSTAND VOLTAGE: 1000V AC/MINUTE
 INSULATOR RESISTANCE: 1000M OHM MIN.
 TEMPERATURE RANGE: -25°C ~ +85°C
 CONTACT RESISTANCE: INITIAL VALUE 10m OHM MAX.
 AFTER ENVIRONMENT TESTING: 20m OHM MAX.
 APPLICABLE BOARD THICKNESS: 0.80 ~ 1.60mm
 APPLICABLE WIRE: AWG #26 ~ #30

MATERIALS

BASE: BRONZE
 FINISH: TIN PLATED
 THICKNESS: 0.20mm

NOTE : SOME SIZES, STYLES AND OPTION ARE NON-STANDARD, NON-CANCELLABLE, NON-RETURNABLE

1.50 mm WAFER - MCt 001 STRAIGHT TYPE - P

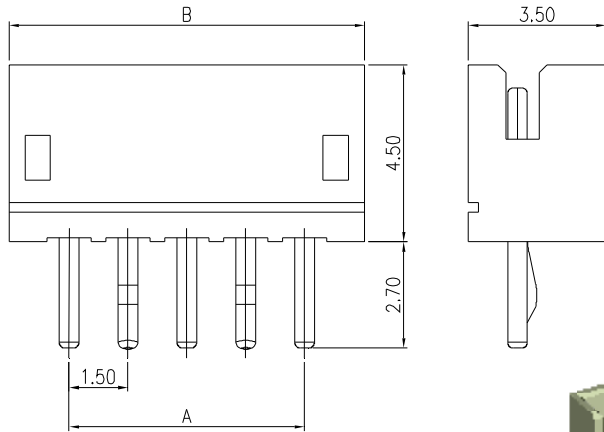

SPECIFICATIONS

VOLTAGE RATING: 250V AC/DC
 CURRENT RATING: 1A AC/DC
 WITHSTAND VOLTAGE: 1000V AC/MINUTE
 INSULATOR RESISTANCE: 1000M OHM MIN.
 TEMPERATURE RANGE: -25°C ~ +85°C
 CONTACT RESISTANCE: INITIAL VALUE 10m OHM MAX.
 AFTER ENVIRONMENT TESTING: 20m OHM MAX.
 APPLICABLE BOARD THICKNESS: 0.80 ~ 1.60mm

MATERIALS

BASE: NYLON 66, UL 94V-0
 CONTACT: BRASS, TIN PLATED

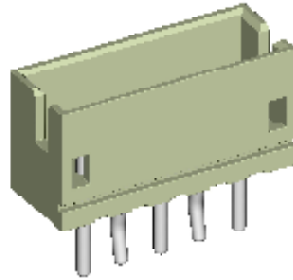

MATING CONNECTOR	
PRODUCT	PART NO.
HOUSING	MCt001-__-H
TERMINAL	MCt001-T

PART NO.	CIRCUITS	DIMENSION	
		A	B
MCt001-P02T	2	1.50	4.55
MCt001-P03T	3	3.00	6.05
MCt001-P04T	4	4.50	7.55
MCt001-P05T	5	6.00	9.05
MCt001-P06T	6	7.50	10.55
MCt001-P07T	7	9.00	12.05
MCt001-P08T	8	10.50	13.55
MCt001-P09T	9	12.00	15.05
MCt001-P10T	10	13.50	16.55
MCt001-P11T	11	15.00	18.05
MCt001-P12T	12	16.50	19.55
MCt001-P13T	13	18.00	21.05

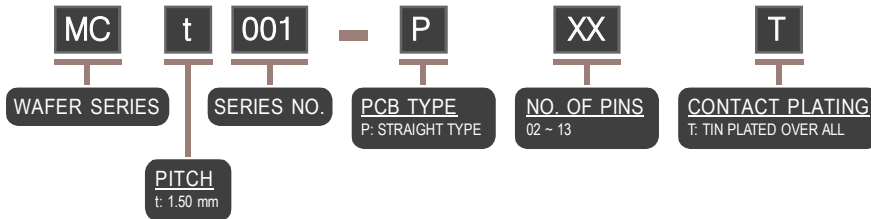

1.50 mm WAFER - MCt 001 RIGHT ANGLE TYPE - Pa

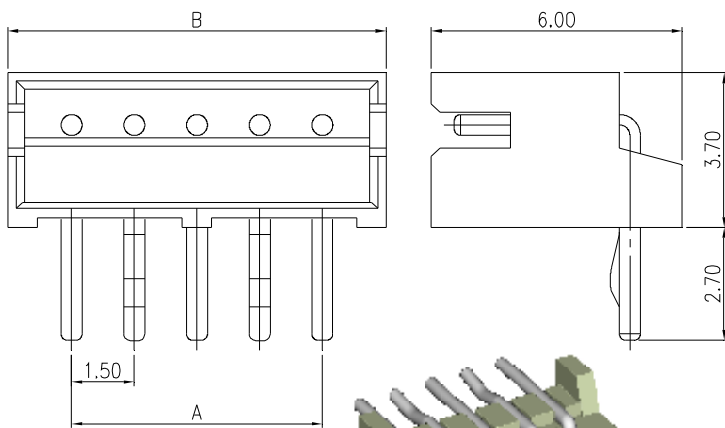

SPECIFICATIONS

VOLTAGE RATING: 250V AC/DC
 CURRENT RATING: 1A AC/DC
 WITHSTAND VOLTAGE: 1000V AC/MINUTE
 INSULATOR RESISTANCE: 1000M OHM MIN.
 TEMPERATURE RANGE: -25°C ~ +85°C
 CONTACT RESISTANCE: INITIAL VALUE 10m OHM MAX.
 AFTER ENVIRONMENT TESTING: 20m OHM MAX.
 APPLICABLE BOARD THICKNESS: 0.80 ~ 1.60mm

MATERIALS

BASE: NYLON 66, UL 94V-0
 CONTACT: BRASS, TIN PLATED

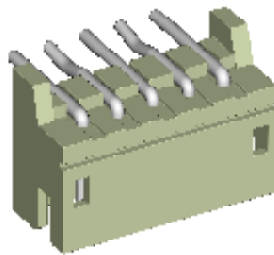

MATING CONNECTOR	
PRODUCT	PART NO.
HOUSING	MCt001-__-H
TERMINAL	MCt001-T

PART NO.	CIRCUITS	DIMENSION	
		A	B
MCt001-Pa02T	2	1.50	4.55
MCt001-Pa03T	3	3.00	6.05
MCt001-Pa04T	4	4.50	7.55
MCt001-Pa05T	5	6.00	9.05
MCt001-Pa06T	6	7.50	10.55
MCt001-Pa07T	7	9.00	12.05
MCt001-Pa08T	8	10.50	13.55
MCt001-Pa09T	9	12.00	15.05
MCt001-Pa10T	10	13.50	16.55
MCt001-Pa11T	11	15.00	18.05
MCt001-Pa12T	12	16.50	19.55
MCt001-Pa13T	13	18.00	21.05

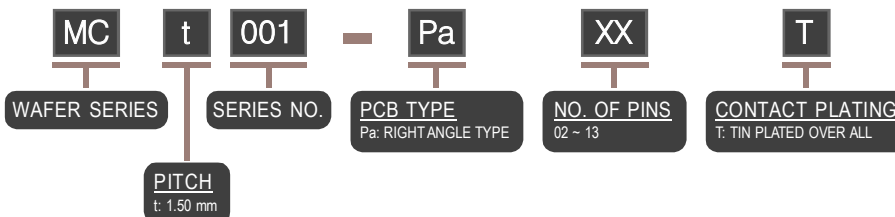

NOTE : SOME SIZES, STYLES AND OPTION ARE NON-STANDARD, NON-CANCELLABLE, NON-RETURNABLE

1.50 mm WAFER - MCt 001 RIGHT ANGLE SURFACE MOUNT TYPE - Rt

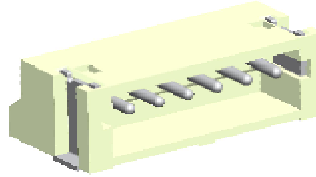
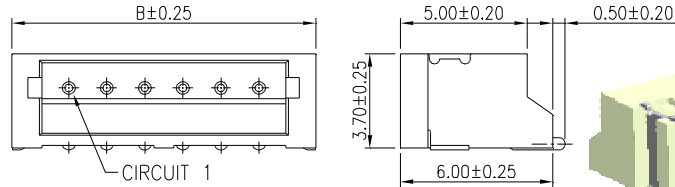
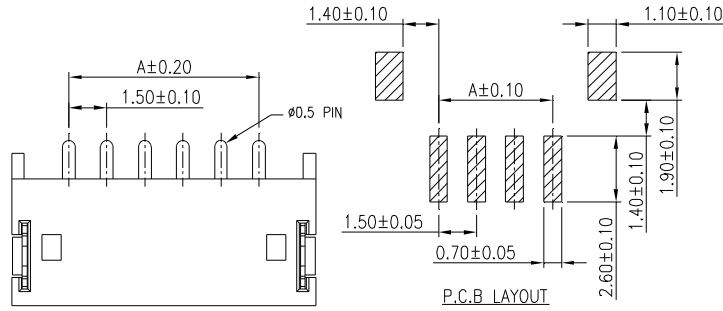

SPECIFICATIONS

VOLTAGE RATING: 100V AC/DC
 CURRENT RATING: 1A AC/DC
 WITHSTAND VOLTAGE: 500V AC/MINUTE
 INSULATOR RESISTANCE: 500M OHM MIN.
 TEMPERATURE RANGE: -25°C ~ +85°C
 CONTACT RESISTANCE: 20m OHM MAX.

MATERIALS

BASE: NYLON 6T, UL 94V-0
 CONTACT: BRASS, TIN PLATED

MATING CONNECTOR

PRODUCT	PART NO.
HOUSING	MCt001-__-H
TERMINAL	MCt001-T

PART NO.	CIRCUITS	DIMENSION	
		A	B
MCt001-Rt02T	2	1.50	6.00
MCt001-Rt03T	3	3.00	7.50
MCt001-Rt04T	4	4.50	9.00
MCt001-Rt05T	5	6.00	10.50
MCt001-Rt06T	6	7.50	12.00
MCt001-Rt07T	7	9.00	13.50
MCt001-Rt08T	8	10.50	15.00
MCt001-Rt09T	9	12.00	16.50
MCt001-Rt10T	10	13.50	18.00
MCt001-Rt11T	11	15.00	19.50
MCt001-Rt12T	12	16.50	21.00
MCt001-Rt13T	13	18.00	22.50

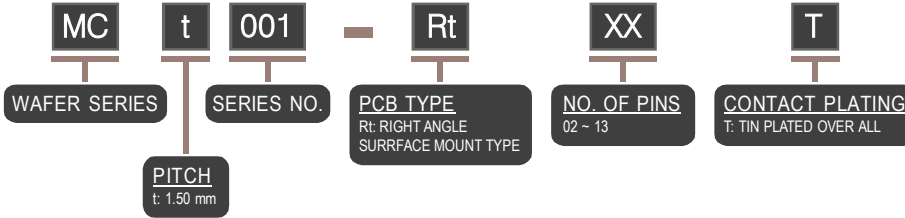

NOTE : SOME SIZES, STYLES AND OPTION ARE NON-STANDARD, NON-CANCELLABLE, NON-RETURNABLE

1.50 mm HOUSING - Mct 001

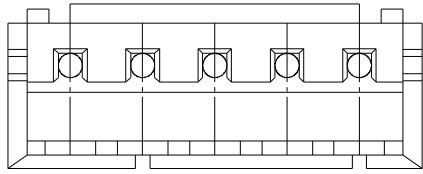

MATING CONNECTOR	
PRODUCT	PART NO.
WAFER	Mct001 SERIES
TERMINAL	Mct001-T

SPECIFICATIONS

VOLTAGE RATING: 250V AC/DC
 CURRENT RATING: 1A AC/DC
 WITHSTAND VOLTAGE: 1000V AC/MINUTE
 INSULATOR RESISTANCE: 1000M OHM MIN.
 TEMPERATURE RANGE: -25°C ~ +85°C
 CONTACT RESISTANCE: INITIAL VALUE 10m OHM MAX.
 AFTER ENVIRONMENT TESTING: 20m OHM MAX.

MATERIALS

BASE: NYLON 66, UL 94V-0

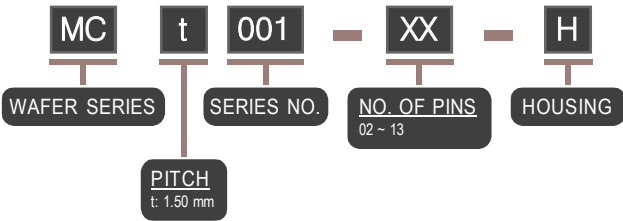
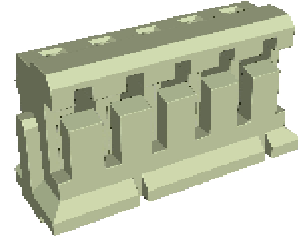
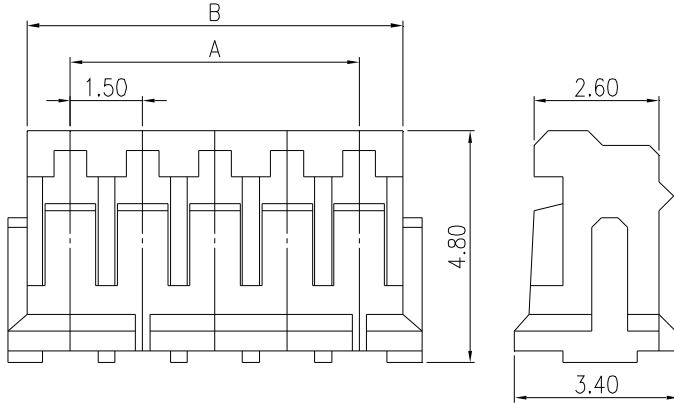

PART NO.	CIRCUITS	DIMENSION	
		A	B
Mct001-02-H	2	1.50	3.30
Mct001-03-H	3	3.00	4.80
Mct001-04-H	4	4.50	6.30
Mct001-05-H	5	6.00	7.80
Mct001-06-H	6	7.50	10.30
Mct001-07-H	7	9.00	10.80
Mct001-08-H	8	10.50	12.30
Mct001-09-H	9	12.00	13.80
Mct001-10-H	10	13.50	15.30
Mct001-11-H	11	15.00	16.80
Mct001-12-H	12	16.50	18.30
Mct001-13-H	13	18.00	19.80

NOTE : SOME SIZES, STYLES AND OPTION ARE NON-STANDARD, NON-CANCELLABLE, NON-RETURNABLE