

**MMI**

---

**WAFER, HOUSING & TERMINAL  
PITCH: 3.68x3.68mm**

---

## TERMINAL- MCw 001 (MALE)

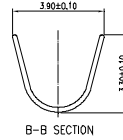
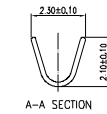
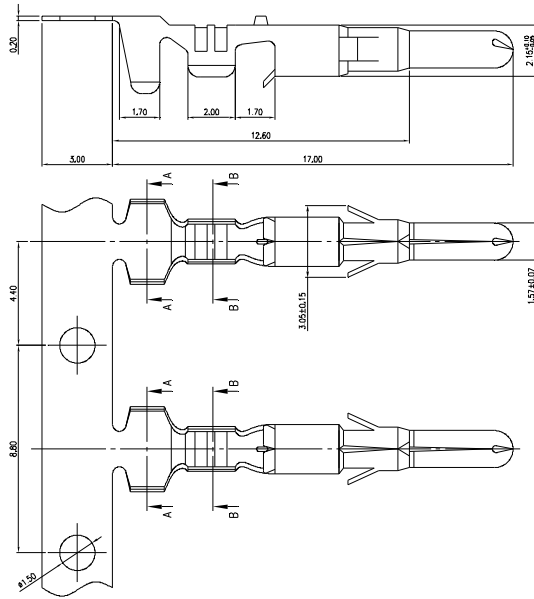

**MC**   **w**   **001**   **T**   **M**  
 WAFER SERIES   SERIES NO.   TERMINAL   GENDER  
 M: MALE  
 MATING HOUSING PITCH  
 w: 3.68 mm

### SPECIFICATIONS

VOLTAGE RATING: 300V AC/DC  
 CURRENT RATING: 9A ~ 12A AC/DC  
 WITHSTAND VOLTAGE: 1500V AC/MINUTE  
 INSULATOR RESISTANCE: 1000M OHM MIN.  
 TEMPERATURE RANGE: -25°C ~ +90°C  
 CONTACT RESISTANCE: 20m OHM MAX.  
 APPLICABLE WIRE: AWG #16 ~ #24

### MATERIALS

BASE: PHOSPHOR BRONZE  
 FINISH: TIN PLATED  
 THICKNESS: 0.20mm

## TERMINAL- MCw 001 (FEMALE)

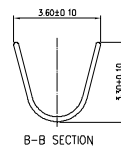
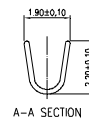
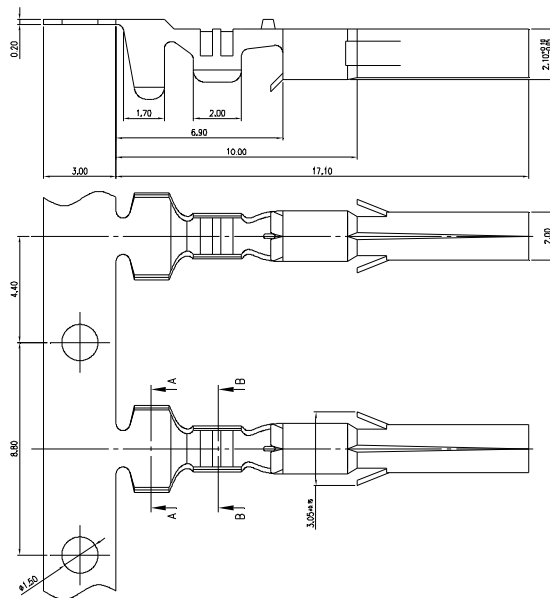

**MC**   **w**   **001**   **T**   **F**  
 WAFER SERIES   SERIES NO.   TERMINAL   GENDER  
 F: FEMALE  
 MATING HOUSING PITCH  
 w: 3.68 mm

### SPECIFICATIONS

VOLTAGE RATING: 300V AC/DC  
 CURRENT RATING: 9A ~ 12A AC/DC  
 WITHSTAND VOLTAGE: 1500V AC/MINUTE  
 INSULATOR RESISTANCE: 1000M OHM MIN.  
 TEMPERATURE RANGE: -25°C ~ +90°C  
 CONTACT RESISTANCE: 20m OHM MAX.  
 APPLICABLE WIRE: AWG #16 ~ #24

### MATERIALS

BASE: PHOSPHOR BRONZE  
 FINISH: TIN PLATED  
 THICKNESS: 0.20mm

NOTE : SOME SIZES, STYLES AND OPTION ARE NON-STANDARD, NON-CANCELLABLE, NON-RETURNABLE

### 3.68 mm HOUSING - MCw 001 (MALE)

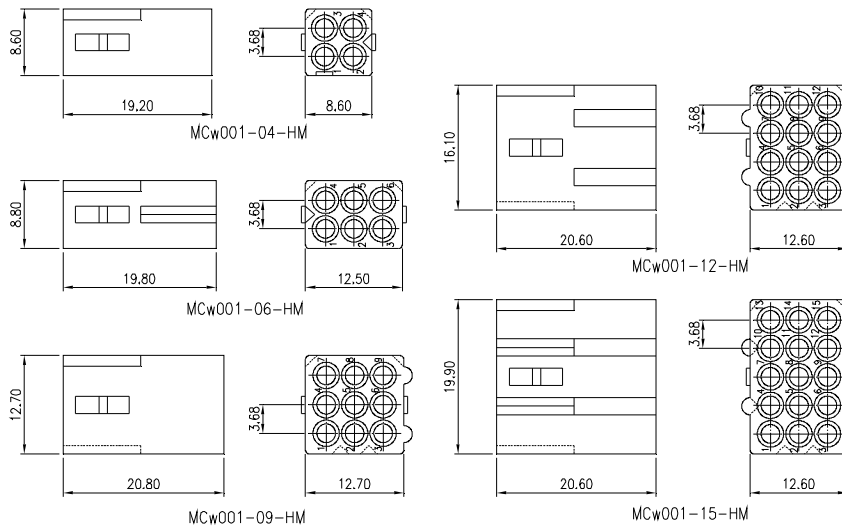

#### SPECIFICATIONS

VOLTAGE RATING: 250V AC/DC  
 CURRENT RATING: 6A AC/DC  
 WITHSTAND VOLTAGE: 1500V AC/MINUTE  
 INSULATOR RESISTANCE: 1000M OHM MIN.  
 TEMPERATURE RANGE: -25°C ~ +85°C  
 CONTACT RESISTANCE: 20m OHM MAX.

#### MATERIALS

BASE: NYLON 66, UL 94V-0

MATING CONNECTOR	
PRODUCT	PART NO.
HOUSING	MCw001-__-HF
TERMINAL	MCw001-TM

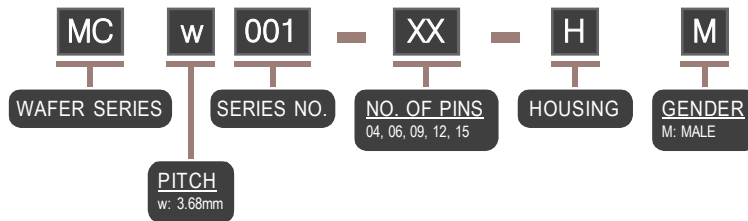
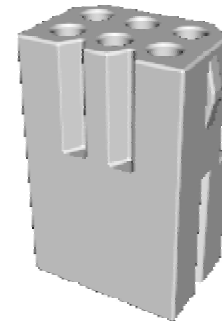

### 3.68 mm HOUSING - MCw 001 (FEMALE)

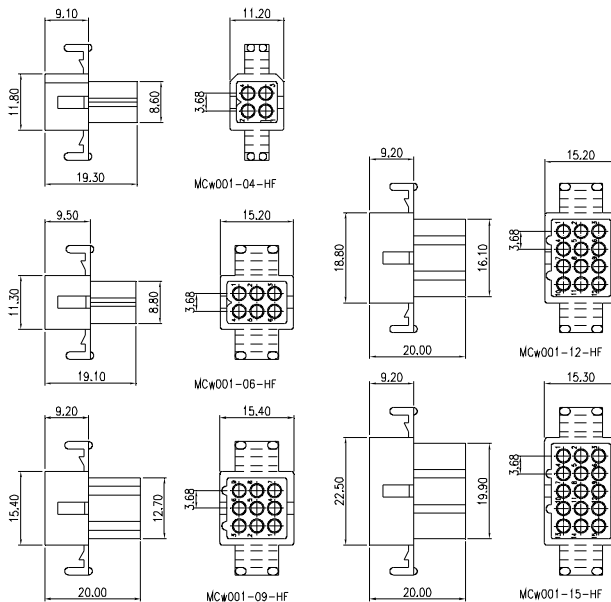

#### SPECIFICATIONS

VOLTAGE RATING: 250V AC/DC  
 CURRENT RATING: 6A AC/DC  
 WITHSTAND VOLTAGE: 1500V AC/MINUTE  
 INSULATOR RESISTANCE: 1000M OHM MIN.  
 TEMPERATURE RANGE: -25°C ~ +85°C  
 CONTACT RESISTANCE: 20m OHM MAX.

#### MATERIALS

BASE: NYLON 66, UL 94V-0

MATING CONNECTOR	
PRODUCT	PART NO.
HOUSING	MCw001-__-HM
TERMINAL	MCw001-TF

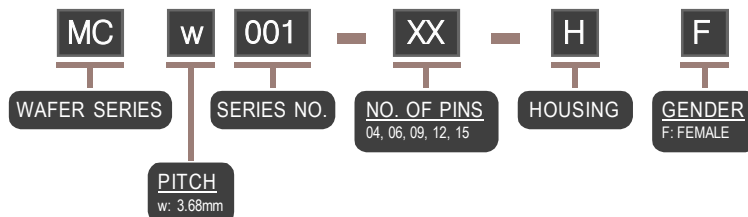
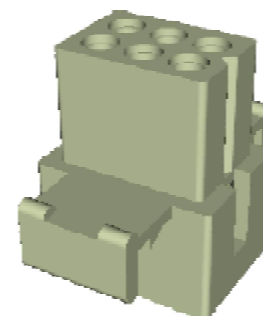

NOTE : SOME SIZES, STYLES AND OPTION ARE NON-STANDARD, NON-CANCELLABLE, NON-RETURNABLE

### 3.68 mm HOUSING - MCw 002 (MALE)

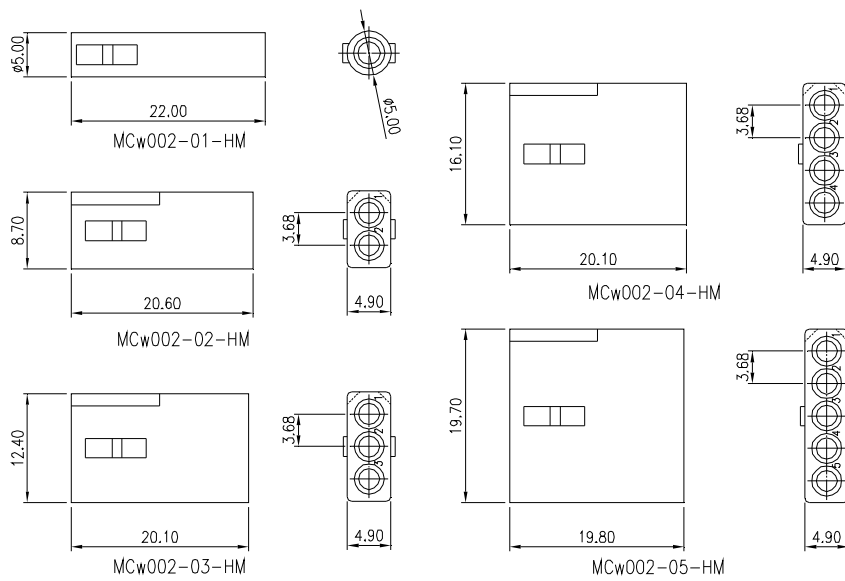

#### SPECIFICATIONS

VOLTAGE RATING: 250V AC/DC  
 CURRENT RATING: 6A AC/DC  
 WITHSTAND VOLTAGE: 1500V AC/MINUTE  
 INSULATOR RESISTANCE: 1000M OHM MIN.  
 TEMPERATURE RANGE: -25°C ~ +85°C  
 CONTACT RESISTANCE: 20m OHM MAX.

#### MATERIALS

BASE: NYLON 66, UL 94V-0

MATING CONNECTOR	
PRODUCT	PART NO.
HOUSING	MCw002-__-HF
TERMINAL	MCw001-TM

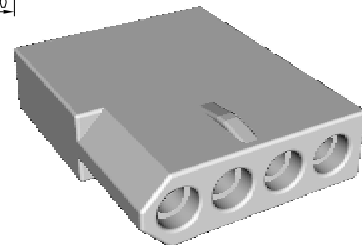
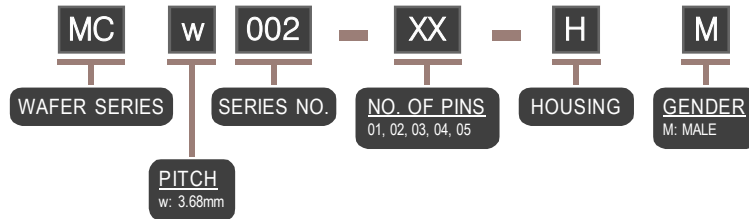

### 3.68 mm HOUSING - MCw 002 (FEMALE)

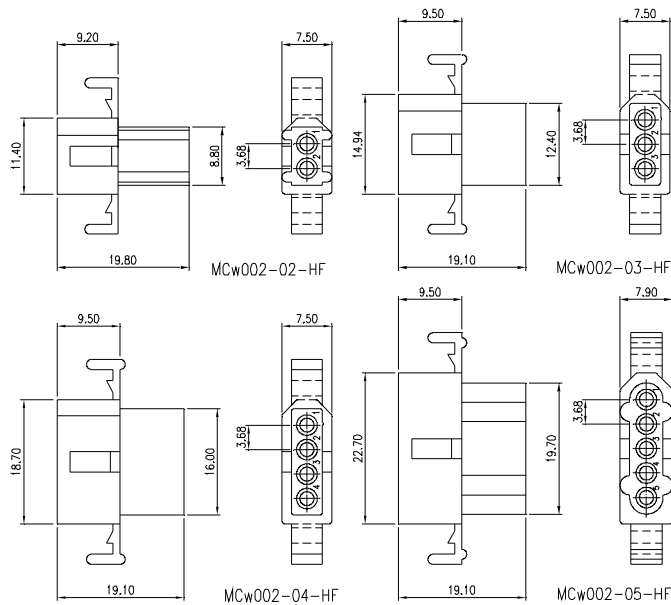

#### SPECIFICATIONS

VOLTAGE RATING: 250V AC/DC  
 CURRENT RATING: 6A AC/DC  
 WITHSTAND VOLTAGE: 1500V AC/MINUTE  
 INSULATOR RESISTANCE: 1000M OHM MIN.  
 TEMPERATURE RANGE: -25°C ~ +85°C  
 CONTACT RESISTANCE: 20m OHM MAX.

#### MATERIALS

BASE: NYLON 66, UL 94V-0

MATING CONNECTOR	
PRODUCT	PART NO.
HOUSING	MCw002-__-HM
TERMINAL	MCw001-TF

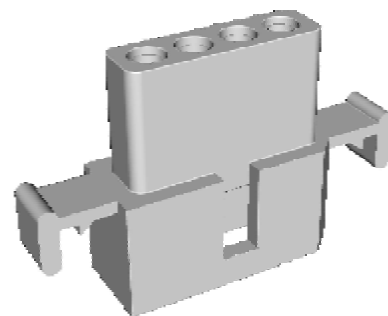
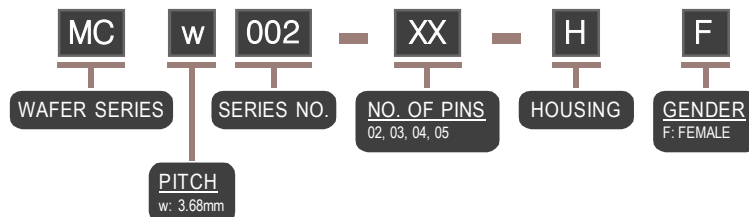

NOTE : SOME SIZES, STYLES AND OPTION ARE NON-STANDARD, NON-CANCELLABLE, NON-RETURNABLE

### 3.68 X 3.68 mm HOUSING - MCw 003 (MALE)

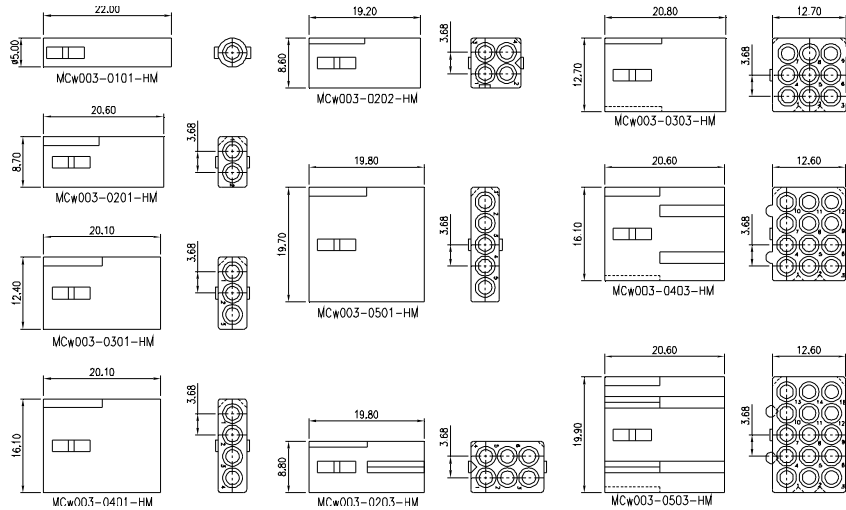

#### SPECIFICATIONS

VOLTAGE RATING: 250V AC/DC  
 CURRENT RATING: 6A AC/DC  
 WITHSTAND VOLTAGE: 1500V AC/MINUTE  
 INSULATOR RESISTANCE: 1000M OHM MIN.  
 TEMPERATURE RANGE: -25°C ~ +85°C  
 CONTACT RESISTANCE: 20m OHM MAX.

#### MATERIALS

BASE: NYLON 66, UL 94V-0

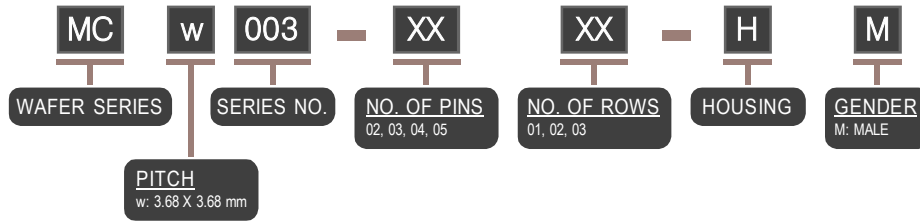
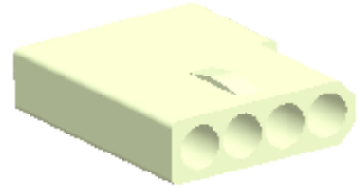

MATING CONNECTOR	
PRODUCT	PART NO.
HOUSING	MCw003-____-HF
TERMINAL	MCw001-TM

### 3.68 X 3.68 mm HOUSING - MCw 003 (FEMALE)

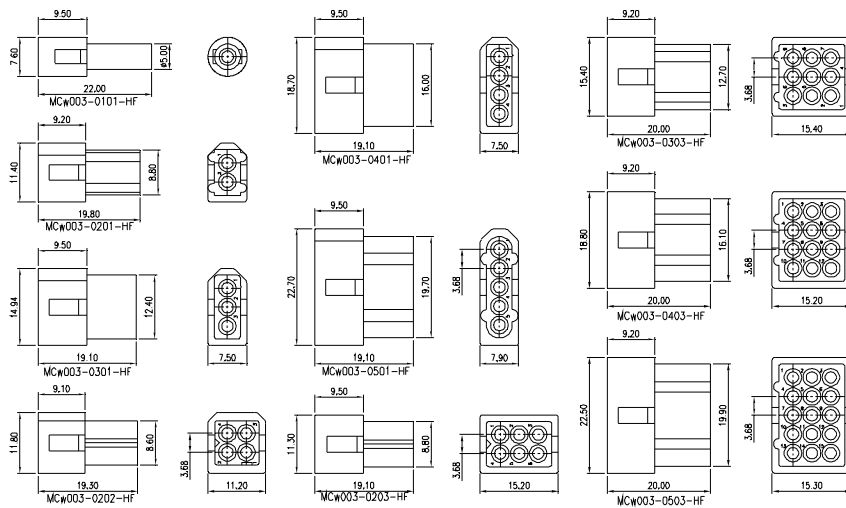

#### SPECIFICATIONS

VOLTAGE RATING: 250V AC/DC  
 CURRENT RATING: 6A AC/DC  
 WITHSTAND VOLTAGE: 1500V AC/MINUTE  
 INSULATOR RESISTANCE: 1000M OHM MIN.  
 TEMPERATURE RANGE: -25°C ~ +85°C  
 CONTACT RESISTANCE: 20m OHM MAX.

#### MATERIALS

BASE: NYLON 66, UL 94V-0

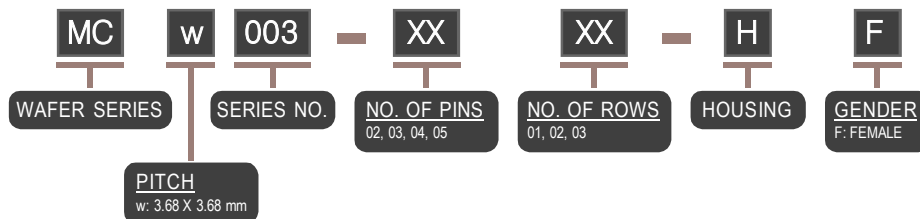
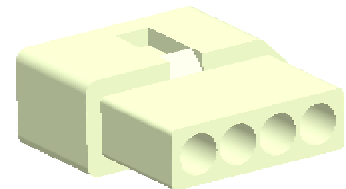

MATING CONNECTOR	
PRODUCT	PART NO.
HOUSING	MCw001-____-HF
TERMINAL	MCw001-TF

NOTE : SOME SIZES, STYLES AND OPTION ARE NON-STANDARD, NON-CANCELLABLE, NON-RETURNABLE