

MMI

**D-SUB CONNECTOR
(RIGHT ANGLE TYPE)**

DB1XX SERIES MOUNTING OPTIONS

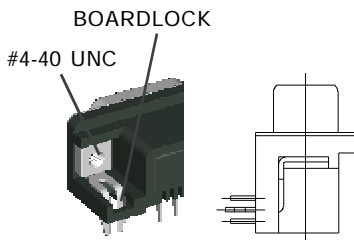

a TYPE
WITH #4-40UNC THREAD INSERT
GROUNDING BRACKET &
BOARDLOCK

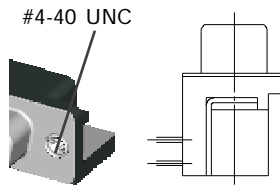

b TYPE
WITH #4-40UNC THREAD INSERT
GROUNDING BRACKET

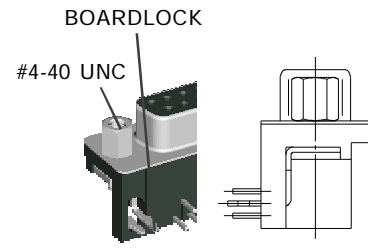

c TYPE
WITH FIXED #4-40UNC HEX NUT
GROUNDING BRACKET &
BOARDLOCK

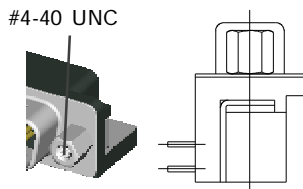

d TYPE
WITH FIXED #4-40UNC HEX NUT
GROUNDING BRACKET

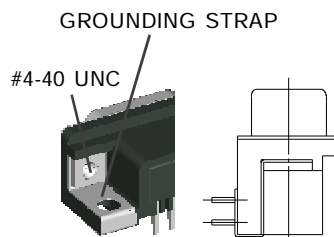

e TYPE
WITH #4-40UNC THREAD INSERT
GROUNDING STRAP

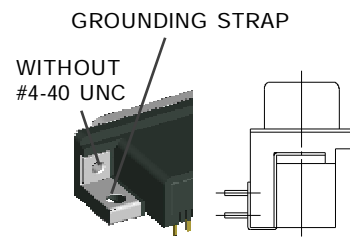

en TYPE
WITHOUT #4-40UNC THREAD INSERT
WITH GROUNDING STRAP

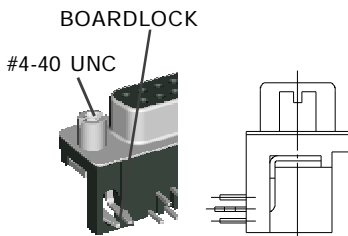

rc TYPE
WITH FIXED #4-40UNC ROUND NUT
GROUNDING BRACKET &
BOARDLOCK

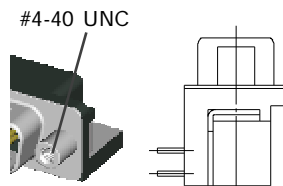

rd TYPE
WITH FIXED #4-40UNC ROUND NUT
GROUNDING BRACKET

NOTE : SOME SIZES, STYLES AND OPTION ARE NON-STANDARD, NON-CANCELLABLE, NON-RETURNABLE

D-SUB CONNECTOR PART NO. INFORMATION

DB **XXX** - **X** **X** **XX** **GX** - **X** **X**

D-SUB
CONNECTOR

GENDER

M: MALE
F: FEMALE

NO. OF CONTACT

09,15,25,37,50

PCB or TERMINAL TYPE

Pa: RIGHT ANGLE TYPE
P: STRAIGHT TYPE
W: WIRE TYPE
Sc: SOLDER CUP TYPE
Cr: CRIMP TYPE
Ste: STRADDLE MOUNT TYPE

BOARDLOCK OPTION

X: WITHOUT PRONG BOARD
2: 2 PRONG BOARD LOCK
4: 4 PRONG BOARD LOCK

CONTACT PLATING OPTION

Gf: GOLD FLASH
G30: 30u" GOLD PLATING
Gft: GOLD FLASH ON CONTACT, TIN PLATED ON SOLDER TAIL
G15t: 15u" GOLD ON CONTACT, TIN PLATED ON SOLDER TAIL
G30t: 30u" GOLD ON CONTACT, TIN PLATED ON SOLDER TAIL

SERIES NO.

1XX: RIGHT ANGLE TYPE
-100: FOOTPRINT= 8.08 mm
-120: FOOTPRINT= 14.84 mm
-121: FOOTPRINT= 8.00 mm
-131: FOOTPRINT= 1.60 mm
-132: FOOTPRINT= 1.20 mm
-160: FOOTPRINT= 5.08 mm

2XX: STRAIGHT TYPE
-200: LENTH= 4.85 mm
-210: LENTH= 5.00 mm
-250: PRESS FIT PCB TYPE

3XX: WIRE TYPE
-300: LENTH= 10.50 mm
-310: LENTH= 13.50 mm
-320: LENTH= 17.50 mm

4XX: SOLDER CUP TYPE
- 400

5XX: CRIMP TYPE
- 500

6XX: STRADDLE MOUNT TYPE
-600

9XX: MACHINE PIN TYPE
-900: FOOTPRINT= 8.00 mm
-910: FOOTPRINT= 10.20 mm
-930: FOOTPRINT= 8.19 mm
-931: FOOTPRINT= 10.39 mm

MOUNTING TYPE

FOR RIGHT ANGLE TYPE

a :WITH #4-40UNC THREAD INSERT GROUNDING BRACKET & BOARDLOCK
an: WITHOUT #4-40UNC THREAD INSERT

GROUNDING BRACKET & BOARDLOCK

b: WITH #4-40UNC THREAD INSERT GROUNDING BRACKET
c: WITH FIXED #4-40UNC HEX NUT GROUNDING BRACKET & BOARDLOCK
d: WITH FIXED #4-40UNC HEX NUT GROUNDING BRACKET
e : WITH #4-40UNC THREAD INSERT GROUNDING STRAP
en: WITHOUT #4-40UNC THREAD INSERT WITH GROUNDING STRAP
rc: WITH FIXED #4-40UNC ROUND NUT GROUNDING BRACKET & BOARDLOCK
rd: WITH FIXED #4-40UNC ROUND NUT GROUNDING BRACKET

FOR STRAIGHT TYPE

H: WITH MOUNTING HOLE ONLY
I: WITH #4-40UNC HEX NUT IN THE REAR OF THE SHELL
J: WITH #4-40UNC ROUND NUT IN THE REAR OF THE SHELL
K: WITH #4-40UNC IN THE REAR SHELL USE RIVET AS BOARDLOCK
L: WITH #4-40UNC HEX NUT IN THE FRONT OF THE SHELL
M: WITH #4-40UNC ROUND NUT IN THE FRONT OF THE SHELL
JP: WITH #4-40UNC ROUND NUT WITH PLASTIC INSERT IN THE REAR OF THE SHELL
P: WITH #4-40UNC IN THE REAR SHELL USE PRESS FIT BOARDLOCK

NOTE : SOME SIZES, STYLES AND OPTION ARE NON-STANDARD, NON-CANCELLABLE, NON-RETURNABLE

D-SUB 100 SERIES *MOUNTING TYPE 2a* RIGHT ANGLE TYPE - Pa

MALE

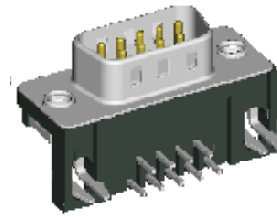
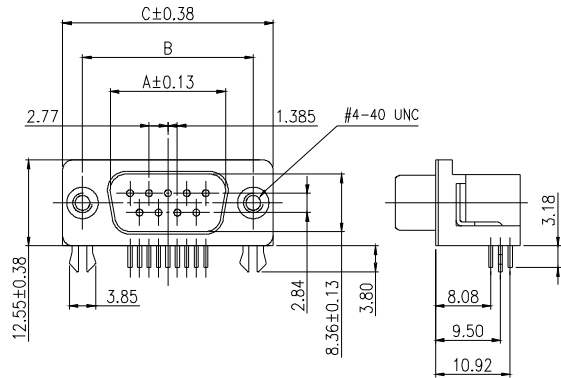

MODEL NO.	NO.OF CONTACTS (SHELL SIZE)	DIMENSION		
		A	B	C
DB100-PaM09GX-2a	9P	16.92	24.99	30.81
DB100-PaM15GX-2a	15P	25.25	33.32	39.14
DB100-PaM25GX-2a	25P	38.96	47.04	53.04
DB100-PaM37GX-2a	37P	55.42	63.50	69.32

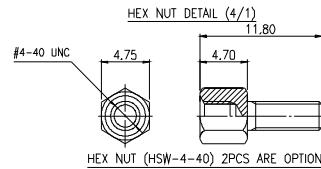
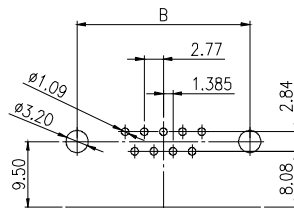
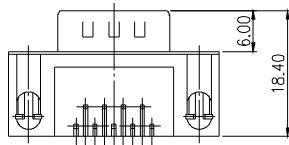

FEMALE

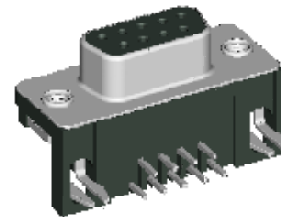
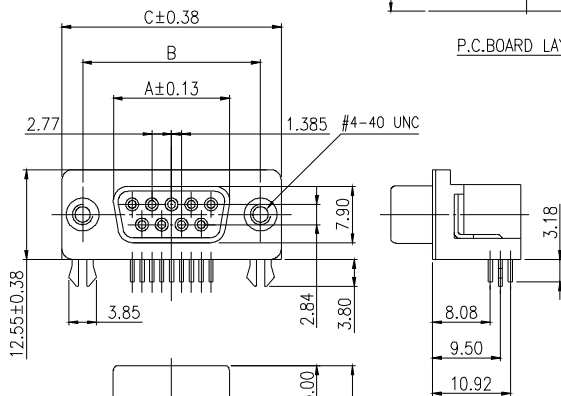

MODEL NO.	NO.OF CONTACTS (SHELL SIZE)	DIMENSION		
		A	B	C
DB100-PaF09GX-2a	9P	16.30	24.99	30.81
DB100-PaF15GX-2a	15P	24.66	33.32	39.14
DB100-PaF25GX-2a	25P	38.38	47.04	53.04
DB100-PaF37Gft-2a	37P	54.83	63.50	69.32

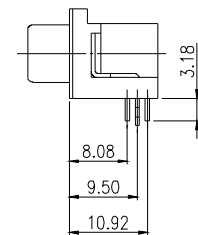
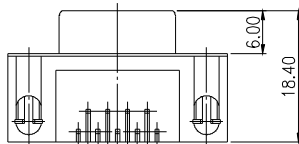

DB	100	-	Pa	X	XX	GX	-	2	a
D-SUB CONNECTOR	SERIES NO. 100: FOOTPRINT= 8.08(0.318")		GENDER M: MALE F: FEMALE		NO. OF CONTACT 09, 15, 25, 37	CONTACT PLATING OPTION Gf: GOLD FLASH G30: 30u" GOLD PLATING Gft: GOLD FLASH ON CONTACT, TIN PLATED ON SOLDER TAIL G15t: 15u" GOLD ON CONTACT, TIN PLATED ON SOLDER TAIL G30t: 30u" GOLD ON CONTACT, TIN PLATED ON SOLDER TAIL		BOARDLOCK OPTION 2: 2 PRONG BOARD LOCK	a: WITH #4-40UNC THREAD INSERT GROUNDING BRACKET & BOARDLOCK
	PCB TYPE Pa: RIGHT ANGLE TYPE								

ELECTRICAL CHARACTERISTIC
 CONTACT CURRENT RATING: 5 AMP
 CONTACT RESISTANCE: 25 M OHM MAX.
 INSULATION RESISTANCE: 5000 OHM MIN. AT 500V DC
 DIELECTRIC WITHSTANDING VOLTAGE: AC 1000V / MIN. R.M.S
 OPERATING TEMPERATURE:-55°C- +105°C

MATERIALS
 INSULATOR: P.B.T. UL 94V-0 RATED
 SHELL: COLD ROLLER STEEL, NICKEL PLATED
 CONTACTS: BRASS, GOLD/TIN PLATED OR GOLDPLATED

NOTE : SOME SIZES, STYLES AND OPTION ARE NON-STANDARD, NON-CANCELLABLE, NON-RETURNABLE

D-SUB 100 SERIES *MOUNTING TYPE b* RIGHT ANGLE TYPE - Pa

MALE

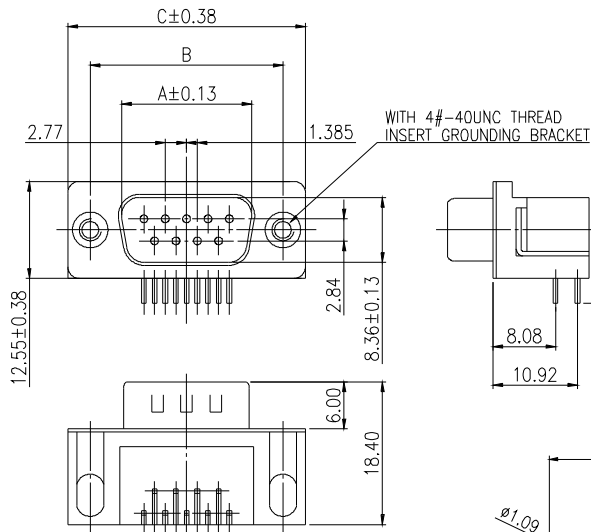

MODEL NO.	NO.OF CONTACTS (SHELL SIZE)	DIMENSION		
		A	B	C
DB100-PaM09GX-b	9P	16.92	24.99	30.81
DB100-PaM15GX-b	15P	25.25	33.32	39.14
DB100-PaM25GX-b	25P	38.96	47.04	53.04
DB100-PaM37GX-b	37P	55.42	63.50	69.32

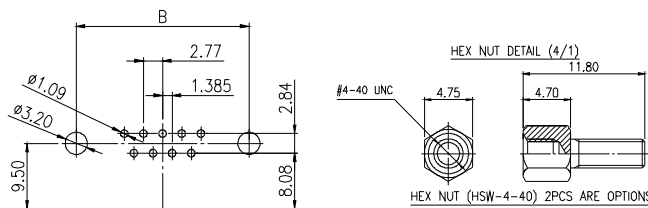

FEMALE

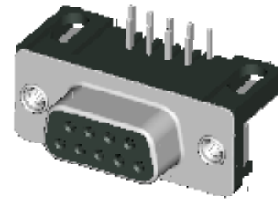
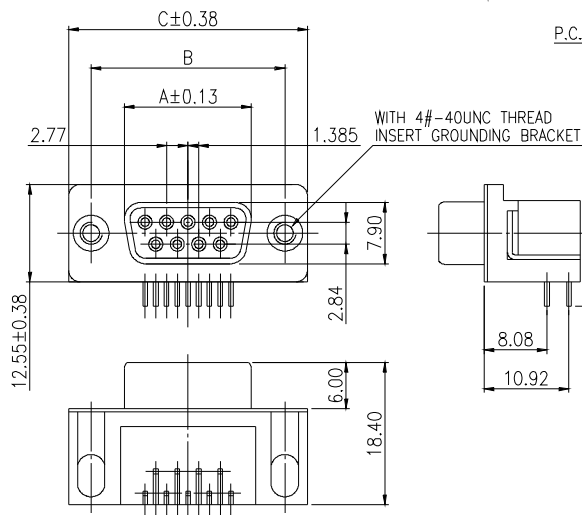

MODEL NO.	NO.OF CONTACTS (SHELL SIZE)	DIMENSION		
		A	B	C
DB100-PaF09GX-b	9P	16.30	24.99	30.81
DB100-PaF15GX-b	15P	24.66	33.32	39.14
DB100-PaF25GX-b	25P	38.38	47.04	53.04
DB100-PaF37Gft-b	37P	54.83	63.50	69.32

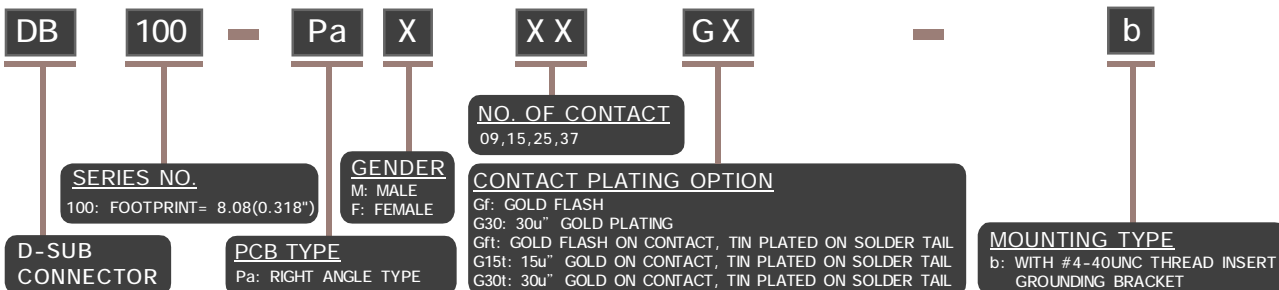

ELECTRICAL CHARACTERISTIC

CONTACT CURRENT RATING: 5 AMP
 CONTACT RESISTANCE: 25 M OHM MAX.
 INSULATION RESISTANCE: 5000 OHM MIN. AT 500V DC
 DIELECTRIC WITHSTANDING VOLTAGE: AC 1000V / MIN. R.M.S
 OPERATING TEMPERATURE:-55°C~ +105°C

MATERIALS

INSULATOR: P.B.T. UL 94V-0 RATED
 SHELL: COLD ROLLER STEEL, NICKEL PLATED
 CONTACTS: BRASS, GOLD/TIN PLATED OR GOLDPLATED

NOTE : SOME SIZES, STYLES AND OPTION ARE NON-STANDARD, NON-CANCELLABLE, NON-RETURNABLE

D-SUB 100 SERIES *MOUNTING TYPE 2C* RIGHT ANGLE TYPE - Pa

MALE

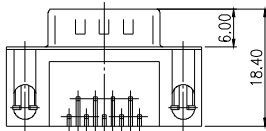
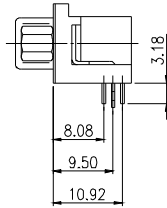
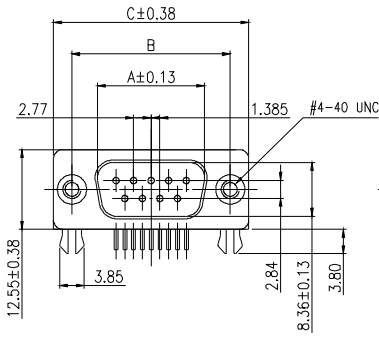

STANDARD : WITH FIXED #4-40UNC HEX NL
MMT# DB100-PaMXXGX-2C

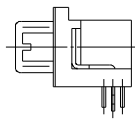

OPTION : WITH FIXED #4-40UNC ROUND NL
MMT# DB100-PaMXXGX-2RC

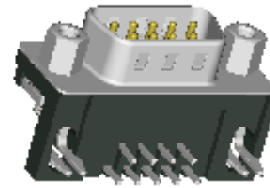

MODEL NO.	NO.OF CONTACTS (SHELL SIZE)	DIMENSION		
		A	B	C
DB100-PaM09GX-2C	9P	16.92	24.99	30.81
DB100-PaM15GX-2C	15P	25.25	33.32	39.14
DB100-PaM25GX-2C	25P	38.96	47.04	53.04
DB100-PaM37GX-2C	37P	55.42	63.50	69.32

FEMALE

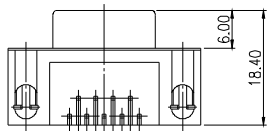
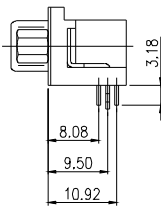
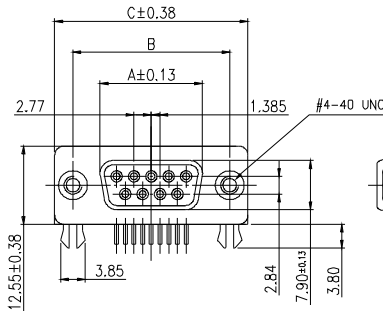

STANDARD : WITH FIXED #4-40UNC HEX NUT
MMT# DB100-PaFXXGX-2C

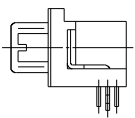

OPTION : WITH FIXED #4-40UNC ROUND NUT
MMT# DB100-PaFXXGX-2RC

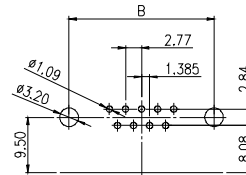

P.C.BOARD LAYOUT

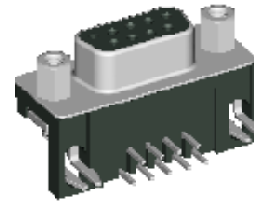

MODEL NO.	NO.OF CONTACTS (SHELL SIZE)	DIMENSION		
		A	B	C
DB100-PaF09GX-2C	9P	16.30	24.99	30.81
DB100-PaF15GX-2C	15P	24.66	33.32	39.14
DB100-PaF25GX-2C	25P	38.38	47.04	53.04
DB100-PaF37GX-2C	37P	54.83	63.50	69.32

DB	100	Pa	X	XX	GX	2	C
D-SUB CONNECTOR	SERIES NO. 100: FOOTPRINT= 8.08(0.318")	PCB TYPE Pa: RIGHT ANGLE TYPE	GENDER M: MALE F: FEMALE	NO. OF CONTACT 09, 15, 25, 37	CONTACT PLATING OPTION Gf: GOLD FLASH G30: 30u" GOLD PLATING Gf: GOLD FLASH ON CONTACT, TIN PLATED ON SOLDER TAIL G15t: 15u" GOLD ON CONTACT, TIN PLATED ON SOLDER TAIL G30t: 30u" GOLD ON CONTACT, TIN PLATED ON SOLDER TAIL	BOARDLOCK OPTION 2: 2 PRONG BOARD LOCK	MOUNTING TYPE c: WITH FIXED #4-40UNC HEX NUT GROUNDING BRACKET & BOARDLOCK

ELECTRICAL CHARACTERISTIC

CONTACT CURRENT RATING: 5 AMP
CONTACT RESISTANCE: 25 M OHM MAX.
INSULATION RESISTANCE: 5000 OHM MIN. AT 500V DC
DIELECTRIC WITHSTANDING VOLTAGE: AC 1000V / MIN. R.M.S
OPERATING TEMPERATURE:-55°C- +105°C

MATERIALS

INSULATOR: P.B.T. UL 94V-0 RATED
SHELL: COLD ROLLER STEEL, NICKEL PLATED
CONTACTS: BRASS, GOLD/TIN PLATED OR GOLDPLATED

NOTE : SOME SIZES, STYLES AND OPTION ARE NON-STANDARD, NON-CANCELLABLE, NON-RETURNABLE

D-SUB 100 SERIES *MOUNTING TYPE d* RIGHT ANGLE TYPE - Pa

MALE

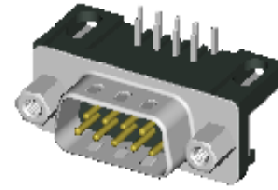
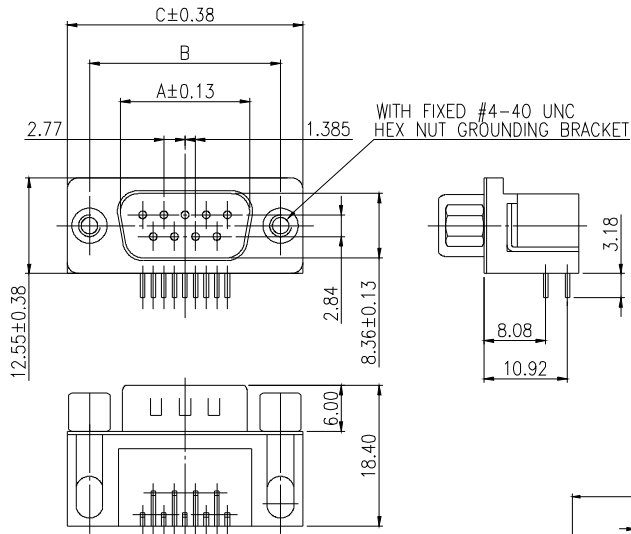

MODEL NO.	NO.OF CONTACTS (SHELL SIZE)	DIMENSION		
		A	B	C
DB100-PaM09GX-D	9P	16.92	24.99	30.81
DB100-PaM15GX-D	15P	25.25	33.32	39.14
DB100-PaM25GX-D	25P	38.96	47.04	53.04
DB100-PaM37GX-D	37P	55.42	63.50	69.32

FEMALE

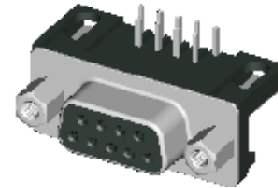
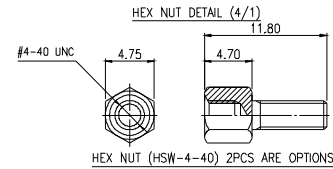
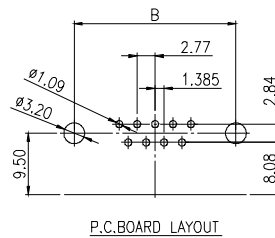
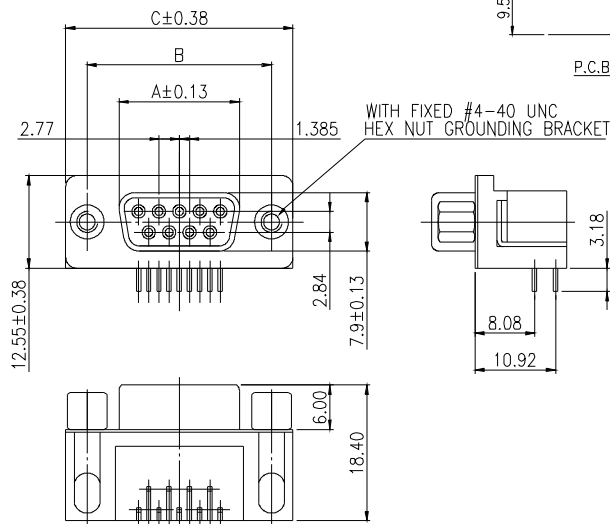

MODEL NO.	NO.OF CONTACTS (SHELL SIZE)	DIMENSION		
		A	B	C
DB100-PaF09GX-D	9P	16.30	24.99	30.81
DB100-PaF15GX-D	15P	24.66	33.32	39.14
DB100-PaF25GX-D	25P	38.38	47.04	53.04
DB100-PaF37GX-D	37P	54.83	63.50	69.32

DB	100	-	Pa	X	XX	GX	-	d
D-SUB CONNECTOR	SERIES NO. 100: FOOTPRINT= 8.08(0.318")		PCB TYPE Pa: RIGHT ANGLE TYPE	GENDER M: MALE F: FEMALE	NO. OF CONTACT 09, 15, 25, 37	CONTACT PLATING OPTION Gf: GOLD FLASH G30: 30u" GOLD PLATING Gf1: GOLD FLASH ON CONTACT, TIN PLATED ON SOLDER TAIL G15t: 15u" GOLD ON CONTACT, TIN PLATED ON SOLDER TAIL G30t: 30u" GOLD ON CONTACT, TIN PLATED ON SOLDER TAIL		MOUNTING TYPE d: WITH FIXED #4-40UNC HEX NUT GROUNDING BRACKET

ELECTRICAL CHARACTERISTIC

CONTACT CURRENT RATING: 5 AMP
 CONTACT RESISTANCE: 25 M OHM MAX.
 INSULATION RESISTANCE: 5000 OHM MIN. AT 500V DC
 DIELECTRIC WITHSTANDING VOLTAGE: AC 1000V / MIN. R.M.S
 OPERATING TEMPERATURE:-55°C~ +105°C

MATERIALS

INSULATOR: P.B.T. UL 94V-0 RATED
 SHELL: COLD ROLLER STEEL, NICKEL PLATED
 CONTACTS: BRASS, GOLD/TIN PLATED OR GOLDPLATED

NOTE : SOME SIZES, STYLES AND OPTION ARE NON-STANDARD, NON-CANCELLABLE, NON-RETURNABLE

D-SUB 100 SERIES *MOUNTING TYPE e & en* RIGHT ANGLE TYPE - Pa

MALE

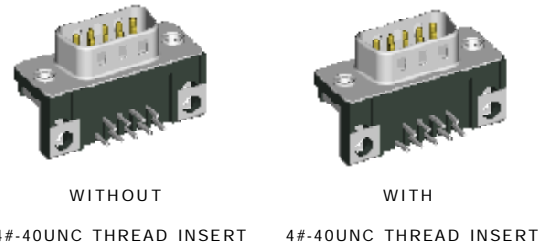
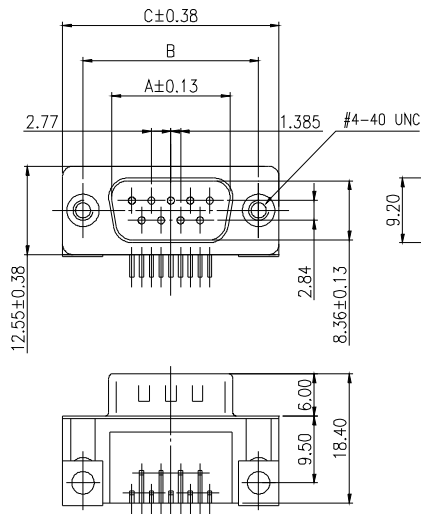

MODEL NO.	NO.OF CONTACTS (SHELL SIZE)	DIMENSION		
		A	B	C
DB100-PaM09GX-0e	9P	16.92	24.99	30.81
DB100-PaM15GX-0e	15P	25.25	33.32	39.14
DB100-PaM25GX-0e	25P	38.96	47.04	53.04
DB100-PaM37GX-0e	37P	55.42	63.50	69.32

FEMALE

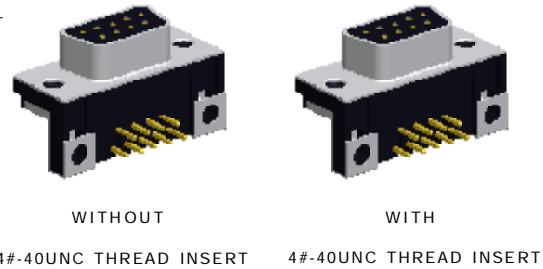
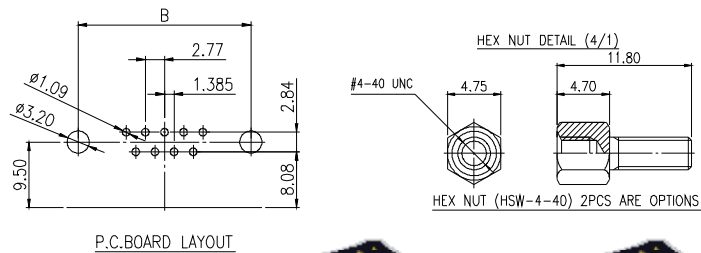
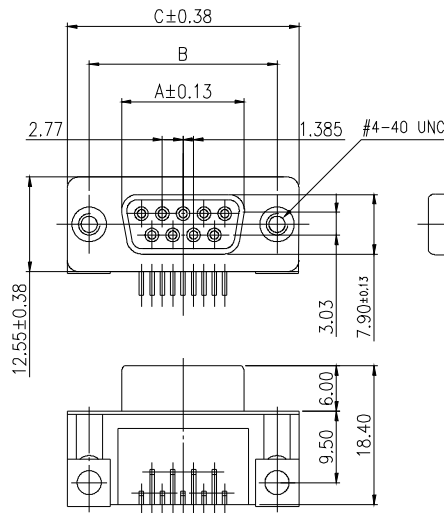

MODEL NO.	NO.OF CONTACTS (SHELL SIZE)	DIMENSION		
		A	B	C
DB100-PaF09GX-0e	9P	16.30	24.99	30.81
DB100-PaF15GX-0e	15P	24.66	33.32	39.14
DB100-PaF25GX-0e	25P	38.38	47.04	53.04
DB100-PaF37GX-0e	37P	54.83	63.50	69.32

DB **100** **Pa** **X** **XX** **GX** **e & en**

<p>D-SUB CONNECTOR</p>	<p>SERIES NO. 100: FOOTPRINT= 8.08(0.318")</p>	<p>GENDER M: MALE F: FEMALE</p>	<p>NO. OF CONTACT 09, 15, 25, 37</p>	<p>CONTACT PLATING OPTION Gf: GOLD FLASH G30: 30u" GOLD PLATING Gft: GOLD FLASH ON CONTACT, TIN PLATED ON SOLDER TAIL G15t: 15u" GOLD ON CONTACT, TIN PLATED ON SOLDER TAIL G30t: 30u" GOLD ON CONTACT, TIN PLATED ON SOLDER TAIL</p>	<p>MOUNTING TYPE e: WITH #4-40UNC THREAD INSERT GROUNDING STRAP en: WITHOUT #4-40UNC THREAD INSERT WITH GROUNDING STRAP</p>
-------------------------------	---	--	---	--	--

ELECTRICAL CHARACTERISTIC
 CONTACT CURRENT RATING: 5 AMP
 CONTACT RESISTANCE: 25 M OHM MAX.
 INSULATION RESISTANCE: 5000 OHM MIN. AT 500V DC
 DIELECTRIC WITHSTANDING VOLTAGE: AC 1000V / MIN. R.M.S
 OPERATING TEMPERATURE:-55°C- +105°C

MATERIALS
 INSULATOR: P.B.T. UL 94V-0 RATED
 SHELL: COLD ROLLER STEEL, NICKEL PLATED
 CONTACTS: BRASS, GOLD/TIN PLATED OR GOLDPLATED

NOTE : SOME SIZES, STYLES AND OPTION ARE NON-STANDARD, NON-CANCELLABLE, NON-RETURNABLE

D-SUB 100 SERIES *Mounting Type rd* RIGHT ANGLE TYPE - Pa

MALE

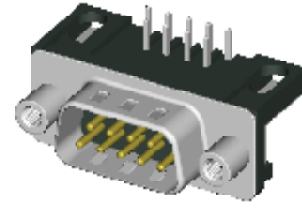
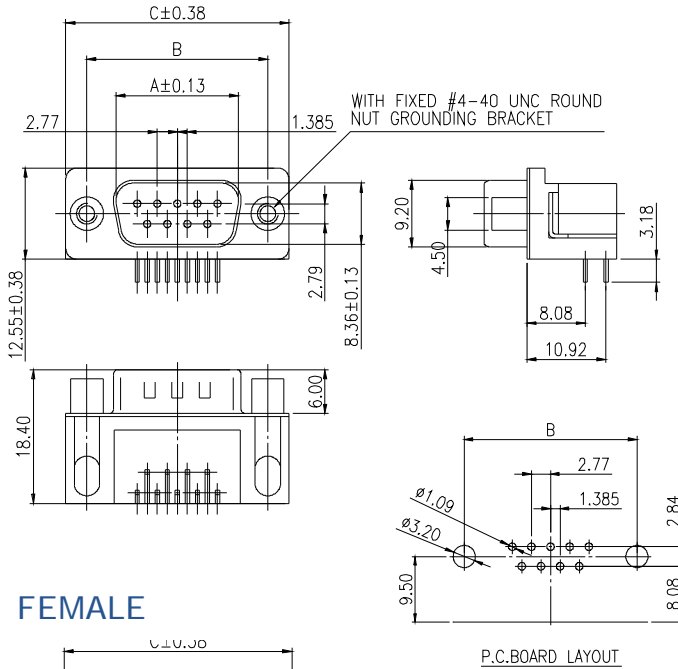

MODEL NO.	NO.OF CONTACTS (SHELL SIZE)	DIMENSION		
		A	B	C
DB100-PaM09GX-RD	9P	16.92	24.99	30.81
DB100-PaM15GX-RD	15P	25.25	33.32	39.14
DB100-PaM25GX-RD	25P	38.96	47.04	53.04
DB100-PaM37GX-RD	37P	55.42	63.50	69.32

HEX NUT DETAIL (4/1)

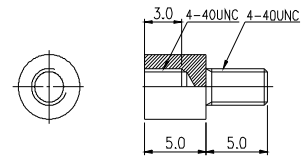

FEMALE

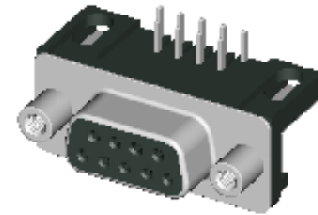
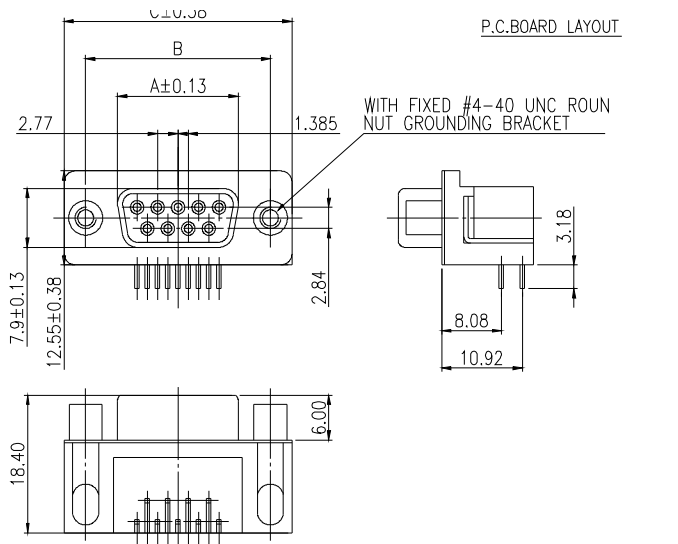

MODEL NO.	NO.OF CONTACTS (SHELL SIZE)	DIMENSION		
		A	B	C
DB100-PaF09GX-RD	9P	16.30	24.99	30.81
DB100-PaF15GX-RD	15P	24.66	33.32	39.14
DB100-PaF25GX-RD	25P	38.38	47.04	53.04
DB100-PaF37GX-RD	37P	54.83	63.50	69.32

DB	100	-	Pa	X	XX	GX	-	rd	
SERIES NO. 100: FOOTPRINT= 8.08(0.318")		GENDER M: MALE F: FEMALE		NO. OF CONTACT 09, 15, 25, 37		CONTACT PLATING OPTION Gf: GOLD FLASH G30: 30u" GOLD PLATING Gf: GOLD FLASH ON CONTACT, TIN PLATED ON SOLDER TAIL G15: 15u" GOLD ON CONTACT, TIN PLATED ON SOLDER TAIL G30: 30u" GOLD ON CONTACT, TIN PLATED ON SOLDER TAIL		MOUNTING TYPE rd: WITH FIXED #4-40UNC ROUND NUT GROUNDING BRACKET	
D-SUB CONNECTOR		PCB TYPE Pa: RIGHT ANGLE TYPE							

ELECTRICAL CHARACTERISTIC

CONTACT CURRENT RATING: 5 AMP
 CONTACT RESISTANCE: 25 M OHM MAX.
 INSULATION RESISTANCE: 5000 OHM MIN. AT 500V DC
 DIELECTRIC WITHSTANDING VOLTAGE: AC 1000V / MIN. R.M.S
 OPERATING TEMPERATURE:-55°C~ +105°C

MATERIALS

INSULATOR: P.B.T. UL 94V-0 RATED
 SHELL: COLD ROLLER STEEL, NICKEL PLATED
 CONTACTS: BRASS, GOLD/TIN PLATED OR GOLDPLATED

NOTE : SOME SIZES, STYLES AND OPTION ARE NON-STANDARD, NON-CANCELLABLE, NON-RETURNABLE

D-SUB 120 SERIES *Mounting Type 2a* RIGHT ANGLE TYPE - Pa

MALE

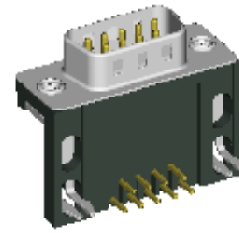
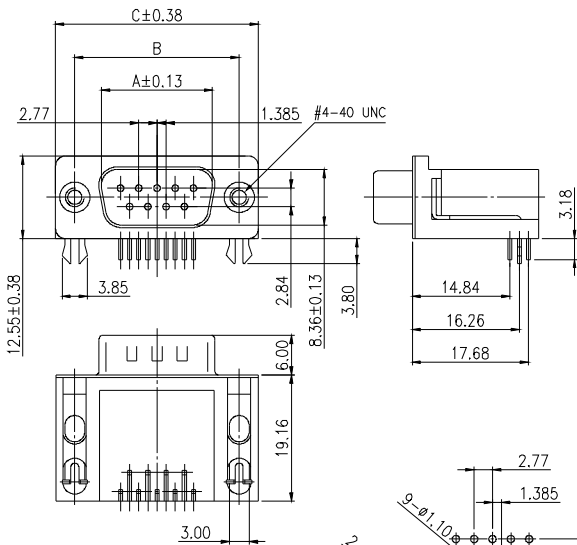

MODEL NO.	NO.OF CONTACTS (SHELL SIZE)	DIMENSION		
		A	B	C
DB120-PaM09GX-2a	9P	16.92	24.99	30.81
DB120-PaM15GX-2a	15P	25.25	33.32	39.14
DB120-PaM25GX-2a	25P	38.96	47.04	53.04
DB120-PaM37GX-2a	37P	55.42	63.50	69.32

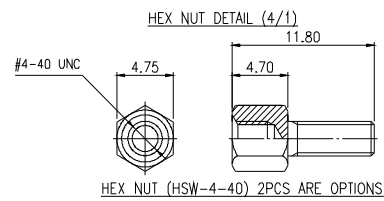

FEMALE

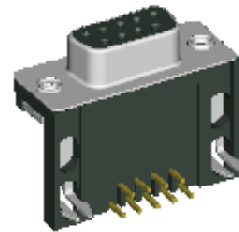
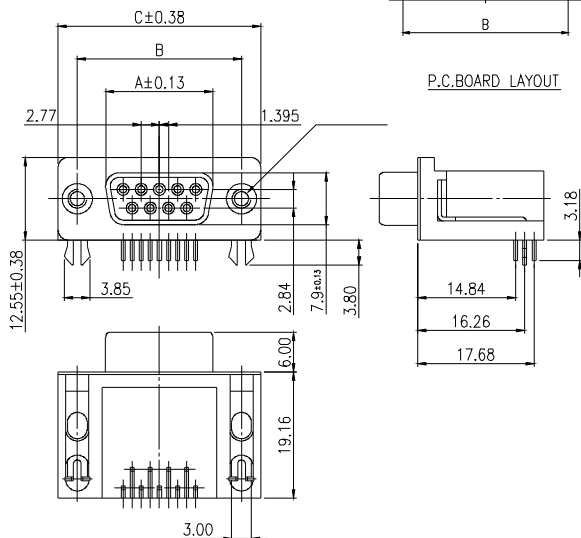

MODEL NO.	NO.OF CONTACTS (SHELL SIZE)	DIMENSION		
		A	B	C
DB120-PaF09GX-2a	9P	16.30	24.99	30.81
DB120-PaF15GX-2a	15P	24.66	33.32	39.14
DB120-PaF25GX-2a	25P	38.38	47.04	53.04
DB120-PaF37GX-2a	37P	54.83	63.50	69.32

DB	120	Pa	X	XX	GX	2	a
D-SUB CONNECTOR	SERIES NO. 120: FOOTPRINT= 14.84(0.584")	PCB TYPE Pa: RIGHT ANGLE TYPE	GENDER M: MALE F: FEMALE	NO. OF CONTACT 09, 15, 25, 37	CONTACT PLATING OPTION Gf: GOLD FLASH G30: 30u" GOLD PLATING Gf1: GOLD FLASH ON CONTACT, TIN PLATED ON SOLDER TAIL G15t: 15u" GOLD ON CONTACT, TIN PLATED ON SOLDER TAIL G30t: 30u" GOLD ON CONTACT, TIN PLATED ON SOLDER TAIL	BOARDLOCK OPTION 2: 2 PRONG BOARD LOCK	MOUNTING TYPE a: WITH #4-40UNC THREAD INSERT GROUNDING BRACKET & BOARDLOCK

ELECTRICAL CHARACTERISTIC
 CONTACT CURRENT RATING: 5 AMP
 CONTACT RESISTANCE: 25 M OHM MAX.
 INSULATION RESISTANCE: 5000 OHM MIN. AT 500V DC
 DIELECTRIC WITHSTANDING VOLTAGE: AC 1000V / MIN. R.M.S
 OPERATING TEMPERATURE:-55°C- +105°C

MATERIALS
 INSULATOR: P.B.T. UL 94V-0 RATED
 SHELL: COLD ROLLER STEEL, NICKEL PLATED
 CONTACTS: BRASS, GOLD/TIN PLATED OR GOLDPLATED

NOTE : SOME SIZES, STYLES AND OPTION ARE NON-STANDARD, NON-CANCELLABLE, NON-RETURNABLE

D-SUB 120 SERIES *MOUNTING TYPE b* RIGHT ANGLE TYPE - Pa

MALE

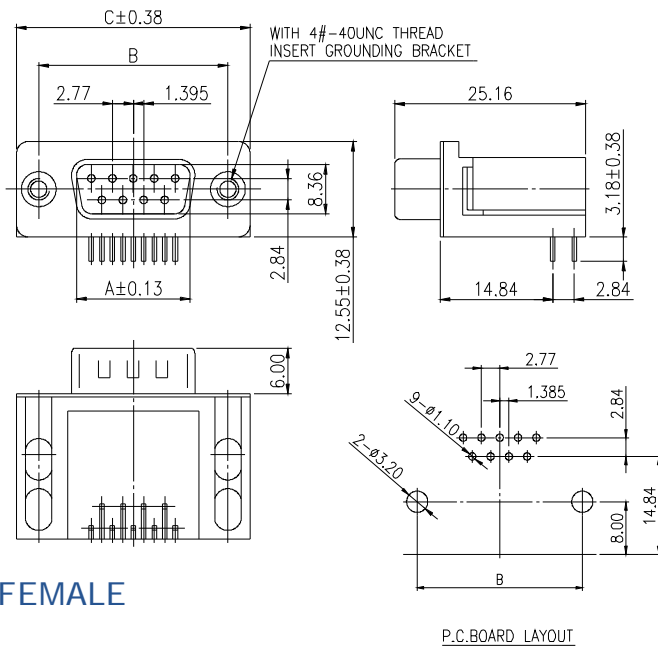

PART NO.	NO. OF CONTACT	DIMENSIONS		
		A	B	C
DB120-PaM09GX-b	9	16.30	24.99	30.81
DB120-PaM15GX-b	15	24.66	33.32	39.14
DB120-PaM25GX-b	25	38.38	47.04	53.04
DB120-PaM37GX-b	37	54.83	63.50	69.32

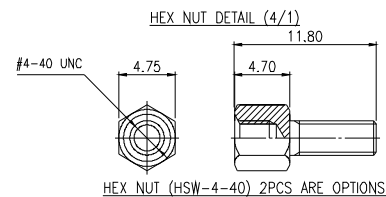

FEMALE

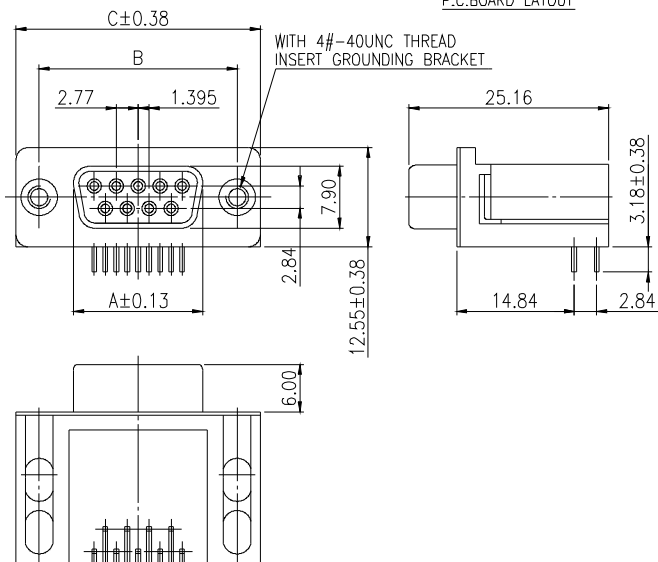

PART NO.	NO. OF CONTACT	DIMENSIONS		
		A	B	C
DB120-PaF09GX-b	9	16.30	24.99	30.81
DB120-PaF15GX-b	15	24.66	33.32	39.14
DB120-PaF25GX-b	25	38.38	47.04	53.04
DB120-PaF37GX-b	37	54.83	63.50	69.32

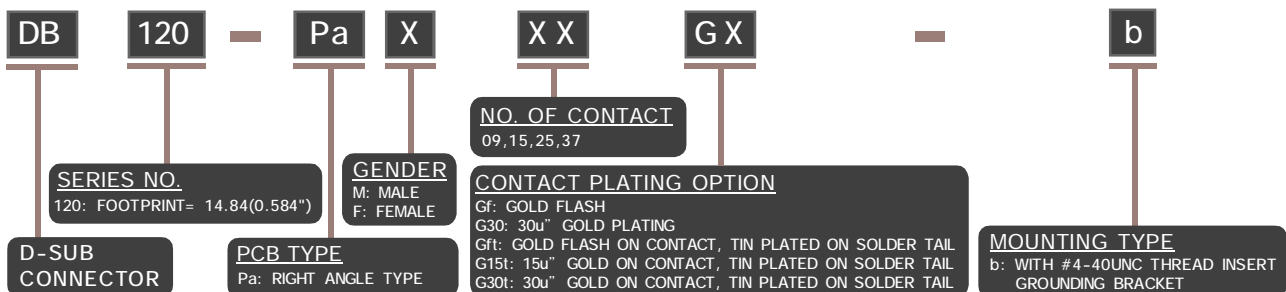

ELECTRICAL CHARACTERISTIC

CONTACT CURRENT RATING: 5 AMP
 CONTACT RESISTANCE: 25 M OHM MAX.
 INSULATION RESISTANCE: 5000 OHM MIN. AT 500V DC
 DIELECTRIC WITHSTANDING VOLTAGE: AC 1000V / MIN. R.M.S
 OPERATING TEMPERATURE:-55°C~ +105°C

MATERIALS

INSULATOR: P.B.T. UL 94V-0 RATED
 SHELL: COLD ROLLER STEEL, NICKEL PLATED
 CONTACTS: BRASS, GOLD/TIN PLATED OR GOLDPLATED

NOTE : SOME SIZES, STYLES AND OPTION ARE NON-STANDARD, NON-CANCELLABLE, NON-RETURNABLE

D-SUB 120 SERIES *Mounting Type d* RIGHT ANGLE TYPE - Pa

MALE

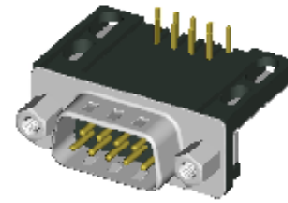
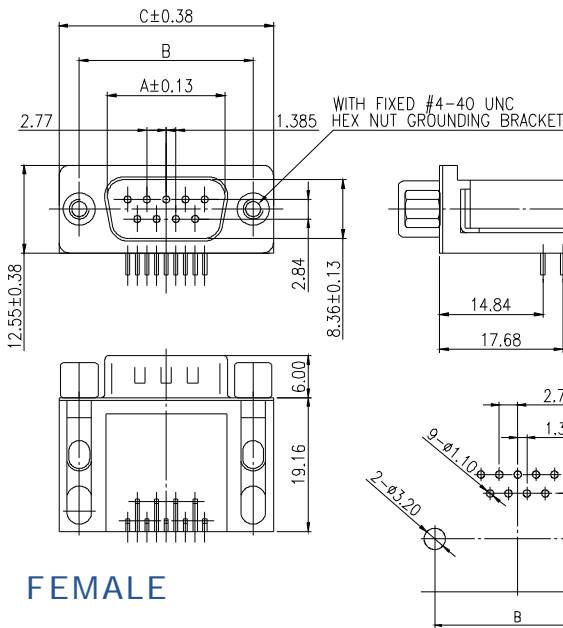

MODEL NO.	NO.OF CONTACTS (SHELL SIZE)	DIMENSION		
		A	B	C
DB120-PaM09GX-D	9P	16.92	24.99	30.81
DB120-PaM15GX-D	15P	25.25	33.32	39.14
DB120-PaM25GX-D	25P	38.96	47.04	53.04
DB120-PaM37GX-D	37P	55.42	63.50	69.32

FEMALE

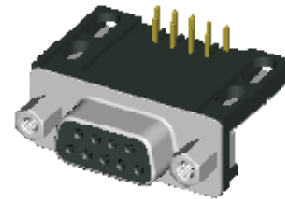
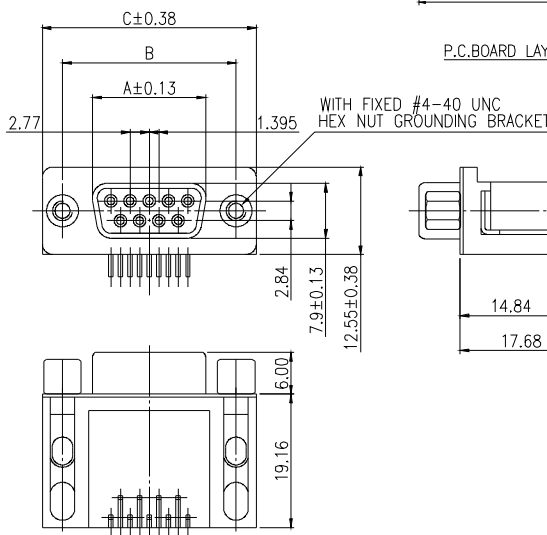

MODEL NO.	NO.OF CONTACTS (SHELL SIZE)	DIMENSION		
		A	B	C
DB120-PaF09GX-D	9P	16.30	24.99	30.81
DB120-PaF15GX-D	15P	24.66	33.32	39.14
DB120-PaF25GX-D	25P	38.38	47.04	53.04
DB120-PaF37GX-D	37P	54.83	63.50	69.32

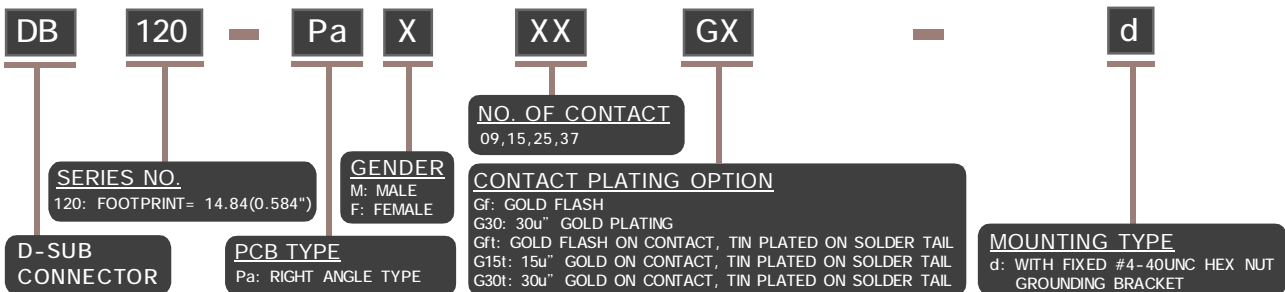

ELECTRICAL CHARACTERISTIC

CONTACT CURRENT RATING: 5 AMP
 CONTACT RESISTANCE: 25 M OHM MAX.
 INSULATION RESISTANCE: 5000 OHM MIN. AT 500V DC
 DIELECTRIC WITHSTANDING VOLTAGE: AC 1000V / MIN. R.M.S
 OPERATING TEMPERATURE: -55°C - +105°C

MATERIALS

INSULATOR: P.B.T. UL 94V-0 RATED
 SHELL: COLD ROLLER STEEL, NICKEL PLATED
 CONTACTS: BRASS, GOLD/TIN PLATED OR GOLDPLATED

NOTE : SOME SIZES, STYLES AND OPTION ARE NON-STANDARD, NON-CANCELLABLE, NON-RETURNABLE

D-SUB 120 SERIES *MOUNTING TYPE rd* RIGHT ANGLE TYPE - Pa

MALE

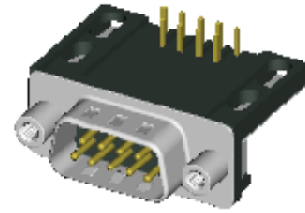
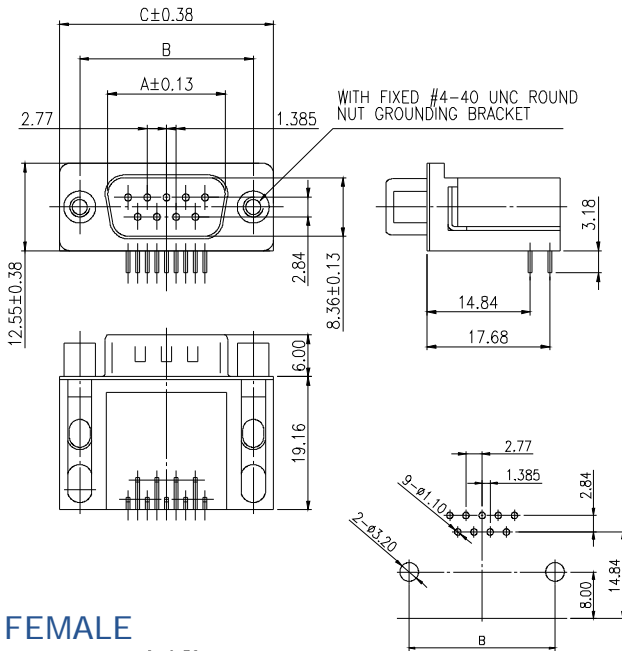

MODEL NO.	NO.OF CONTACTS (SHELL SIZE)	DIMENSION		
		A	B	C
DB120-PaM09GX-RD	9P	16.92	24.99	30.81
DB120-PaM15GX-RD	15P	25.25	33.32	39.14
DB120-PaM25GX-RD	25P	38.96	47.04	53.04
DB120-PaM37GX-RD	37P	55.42	63.50	69.32

HEX NUT DETAIL (4/1)

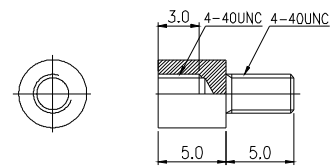

ROUND NUT (RSW-4-40) 2PCS ARE OPTIONS

FEMALE

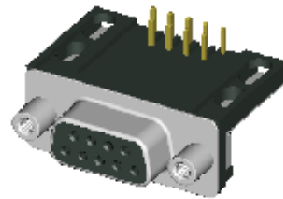
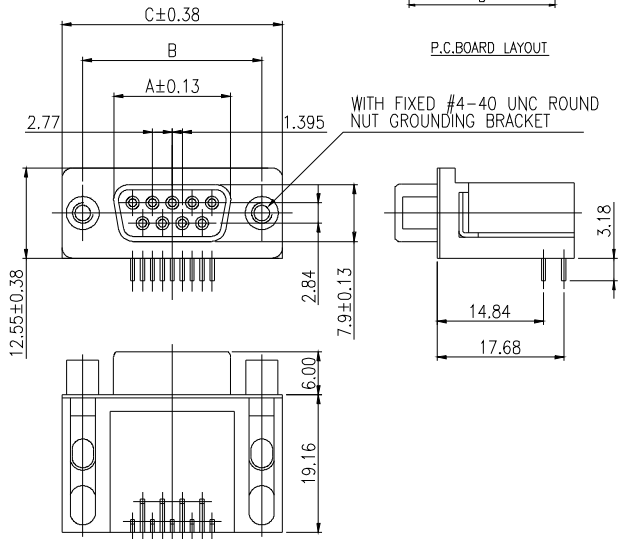

MODEL NO.	NO.OF CONTACTS (SHELL SIZE)	DIMENSION		
		A	B	C
DB120-PaF09GX-RD	9P	16.30	24.99	30.81
DB120-PaF15GX-RD	15P	24.66	33.32	39.14
DB120-PaF25GX-RD	25P	38.38	47.04	53.04
DB120-PaF37GX-RD	37P	54.83	63.50	69.32

DB	120	-	Pa	X	XX	GX	-	rd
D-SUB CONNECTOR	SERIES NO. 120: FOOTPRINT= 14.84(0.584")		GENDER M: MALE F: FEMALE		NO. OF CONTACT 09, 15, 25, 37	CONTACT PLATING OPTION Gf: GOLD FLASH G30: 30u" GOLD PLATING GfT: GOLD FLASH ON CONTACT, TIN PLATED ON SOLDER TAIL G15t: 15u" GOLD ON CONTACT, TIN PLATED ON SOLDER TAIL G30t: 30u" GOLD ON CONTACT, TIN PLATED ON SOLDER TAIL		MOUNTING TYPE rd: WITH FIXED #4-40UNC ROUND NUT GROUNDING BRACKET
	PCB TYPE Pa: RIGHT ANGLE TYPE							

ELECTRICAL CHARACTERISTIC

CONTACT CURRENT RATING: 5 AMP
 CONTACT RESISTANCE: 25 M OHM MAX.
 INSULATION RESISTANCE: 5000 OHM MIN. AT 500V DC
 DIELECTRIC WITHSTANDING VOLTAGE: AC 1000V / MIN. R.M.S
 OPERATING TEMPERATURE:-55°C~ +105°C

MATERIALS

INSULATOR: P.B.T. UL 94V-0 RATED
 SHELL: COLD ROLLER STEEL, NICKEL PLATED
 CONTACTS: BRASS, GOLD/TIN PLATED OR GOLDPLATED

NOTE : SOME SIZES, STYLES AND OPTION ARE NON-STANDARD, NON-CANCELLABLE, NON-RETURNABLE

D-SUB 121 SERIES *MOUNTING TYPE* 2a RIGHT ANGLE TYPE - Pa

MALE

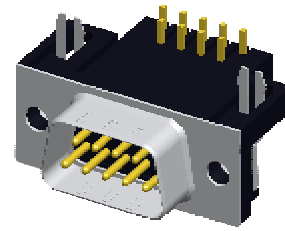
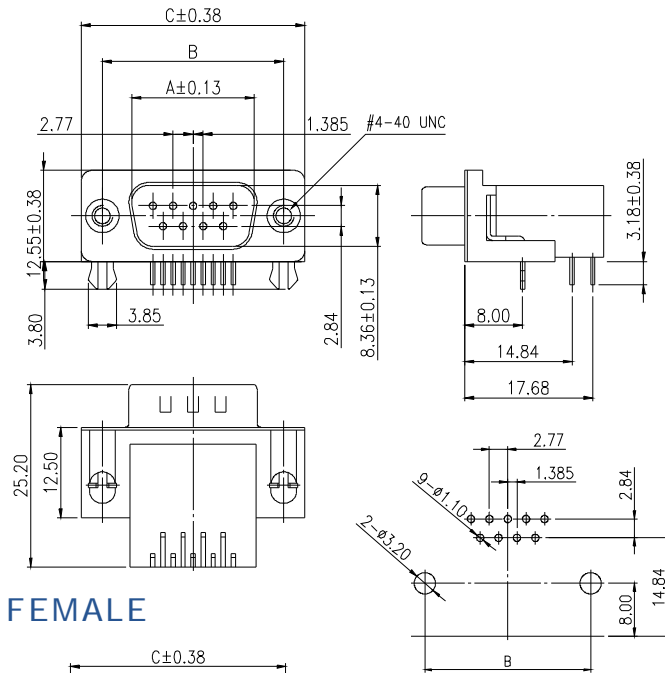

MODEL NO.	NO.OF CONTACTS (SHELL SIZE)	DIMENSION		
		A	B	C
DB121-PaM09GX-2a	9P	16.92	24.99	30.81
DB121-PaM15GX-2a	15P	25.25	33.32	39.14
DB121-PaM25GX-2a	25P	38.96	47.04	53.04
DB121-PaM37GX-2a	37P	55.42	63.50	69.32

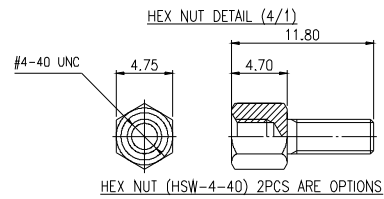

FEMALE

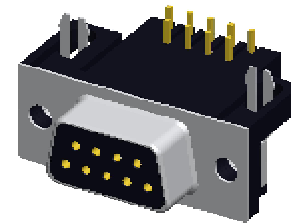
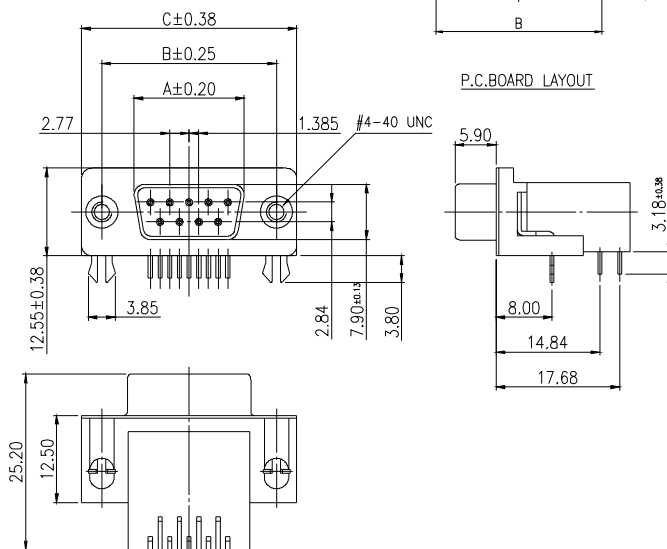

MODEL NO.	NO.OF CONTACTS (SHELL SIZE)	DIMENSION		
		A	B	C
DB121-PaF09GX-2a	9P	16.33	24.99	30.80
DB121-PaF15GX-2a	15P	24.66	33.32	39.10
DB121-PaF25GX-2a	25P	38.38	47.04	53.00
DB121-PaF37GX-2a	37P	54.84	63.50	69.32

DB	121	Pa	X	XX	GX	2	a
D-SUB CONNECTOR	SERIES NO. 121: FOOTPRINT= 8.00(0.315")	PCB TYPE Pa: RIGHT ANGLE TYPE	GENDER M: MALE F: FEMALE	NO. OF CONTACT 09,15,25,37	CONTACT PLATING OPTION Gf: GOLD FLASH G30: 30u" GOLD PLATING Gf: GOLD FLASH ON CONTACT, TIN PLATED ON SOLDER TAIL G15t: 15u" GOLD ON CONTACT, TIN PLATED ON SOLDER TAIL G30t: 30u" GOLD ON CONTACT, TIN PLATED ON SOLDER TAIL	BOARDLOCK OPTION 2: 2 PRONG BOARD LOCK	MOUNTING TYPE a: WITH #4-40UNC THREAD INSERT GROUNDING BRACKET & BOARDLOCK

ELECTRICAL CHARACTERISTIC

CONTACT CURRENT RATING: 5 AMP
 CONTACT RESISTANCE: 25 M OHM MAX.
 INSULATION RESISTANCE: 5000 OHM MIN. AT 500V DC
 DIELECTRIC WITHSTANDING VOLTAGE: AC 1000V / MIN. R.M.S
 OPERATING TEMPERATURE:-55°C- +105°C

MATERIALS

INSULATOR: P.B.T. UL 94V-0 RATED
 SHELL: COLD ROLLER STEEL, NICKEL PLATED
 CONTACTS: BRASS, GOLD/TIN PLATED OR GOLDPLATED

NOTE : SOME SIZES, STYLES AND OPTION ARE NON-STANDARD, NON-CANCELLABLE, NON-RETURNABLE

D-SUB 121 SERIES *MOUNTING TYPE b* RIGHT ANGLE TYPE - Pa

MALE

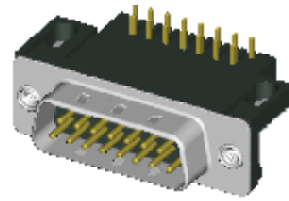
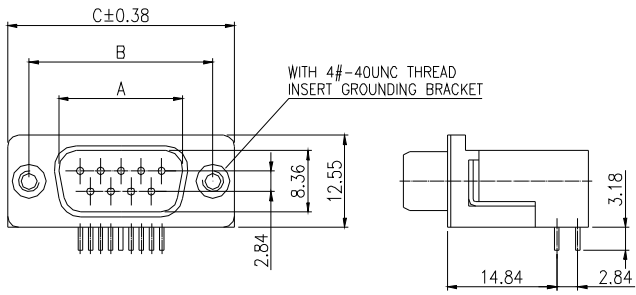

MODEL NO.	NO.OF CONTACTS (SHELL SIZE)	DIMENSION		
		A	B	C
DB121-PaM09GX-b	9P	16.92	24.99	30.81
DB121-PaM15GX-b	15P	25.25	33.32	39.14
DB121-PaM25GX-b	25P	38.96	47.04	53.04
DB121-PaM37GX-b	37P	55.42	63.50	69.32

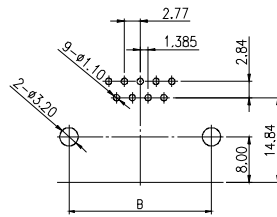
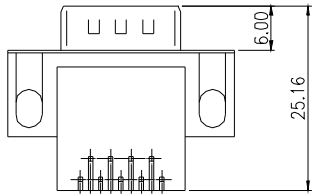

P.C. BOARD LAYOUT

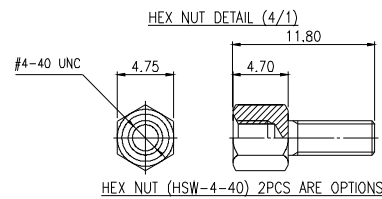

FEMALE

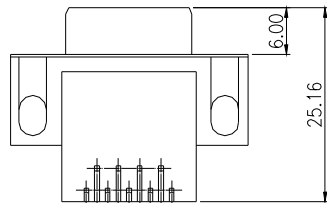
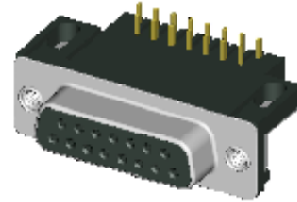
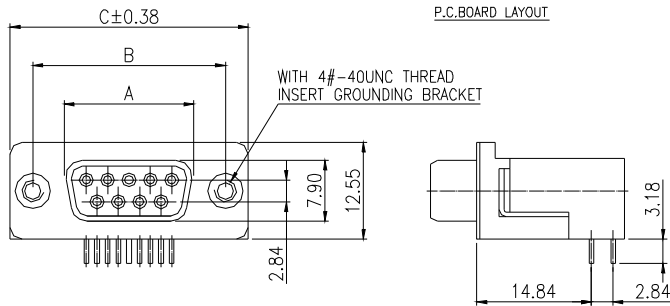

MODEL NO.	NO.OF CONTACTS (SHELL SIZE)	DIMENSION		
		A	B	C
DB121-PaF09GX-b	9P	16.30	24.99	30.81
DB121-PaF15GX-b	15P	24.66	33.32	39.14
DB121-PaF25GX-b	25P	38.38	47.04	53.04
DB121-PaF37GX-b	37P	54.83	63.50	69.32

DB **121** **-** **Pa** **X** **XX** **GX** **-** **b**

<p>D-SUB CONNECTOR</p>	<p>SERIES NO. 121: FOOTPRINT= 8.00 (0.315")</p>	<p>PCB TYPE Pa: RIGHT ANGLE TYPE</p>	<p>GENDER M: MALE F: FEMALE</p>	<p>NO. OF CONTACT 09, 15, 25, 37</p>	<p>CONTACT PLATING OPTION Gf: GOLD FLASH G30: 30u" GOLD PLATING Gft: GOLD FLASH ON CONTACT, TIN PLATED ON SOLDER TAIL G15t: 15u" GOLD ON CONTACT, TIN PLATED ON SOLDER TAIL G30t: 30u" GOLD ON CONTACT, TIN PLATED ON SOLDER TAIL</p>	<p>MOUNTING TYPE b: WITH #4-40UNC THREAD INSERT GROUNDING BRACKET</p>
-------------------------------	--	---	--	---	--	--

ELECTRICAL CHARACTERISTIC

CONTACT CURRENT RATING: 5 AMP
CONTACT RESISTANCE: 25 M OHM MAX.
INSULATION RESISTANCE: 5000 OHM MIN. AT 500V DC
DIELECTRIC WITHSTANDING VOLTAGE: AC 1000V / MIN. R.M.S
OPERATING TEMPERATURE:-55°C~ +105°C

MATERIALS

INSULATOR: P.B.T. UL 94V-0 RATED
SHELL: COLD ROLLER STEEL, NICKEL PLATED
CONTACTS: BRASS, GOLD/TIN PLATED OR GOLDPLATED

NOTE : SOME SIZES, STYLES AND OPTION ARE NON-STANDARD, NON-CANCELLABLE, NON-RETURNABLE

D-SUB 121 SERIES *MOUNTING TYPE d* RIGHT ANGLE TYPE - Pa

MALE

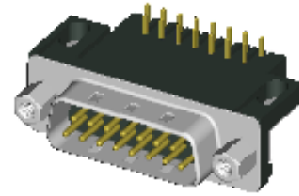
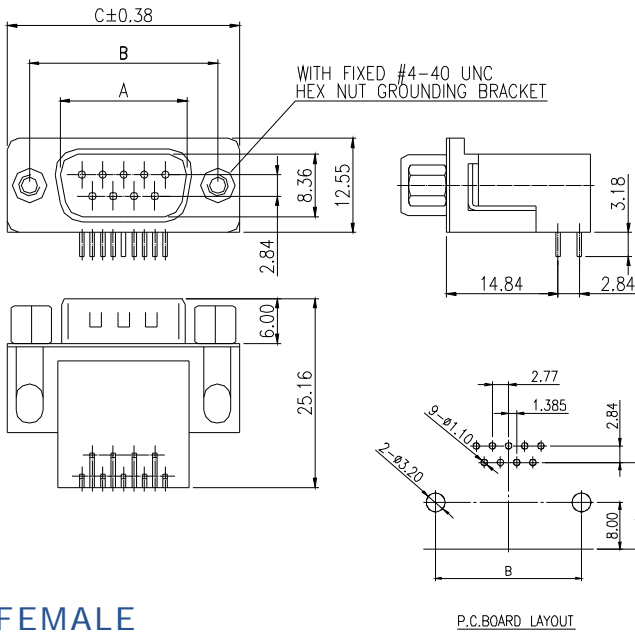

MODEL NO.	NO.OF CONTACTS (SHELL SIZE)	DIMENSION		
		A	B	C
DB121-PaM09GX-D	9P	16.92	24.99	30.81
DB121-PaM15GX-D	15P	25.25	33.32	39.14
DB121-PaM25GX-D	25P	38.96	47.04	53.04
DB121-PaM37GX-D	37P	55.42	63.50	69.32

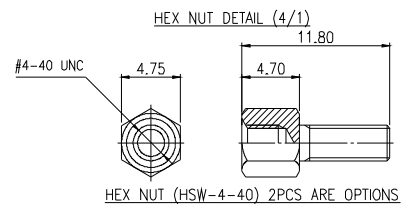

FEMALE

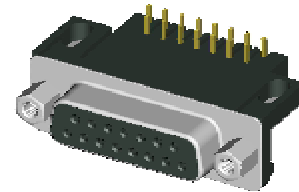
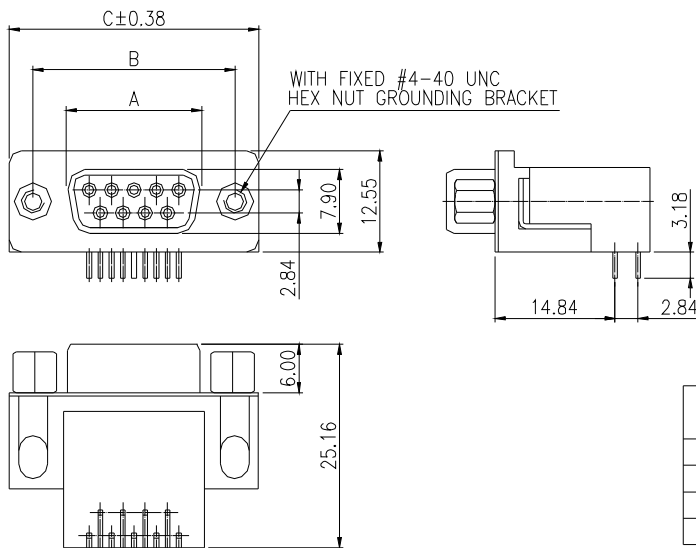

MODEL NO.	NO.OF CONTACTS (SHELL SIZE)	DIMENSION		
		A	B	C
DB121-PaF09GX-D	9P	16.30	24.99	30.81
DB121-PaF15GX-D	15P	24.66	33.32	39.14
DB121-PaF25GX-D	25P	38.38	47.04	53.04
DB121-PaF37GX-D	37P	54.83	63.50	69.32

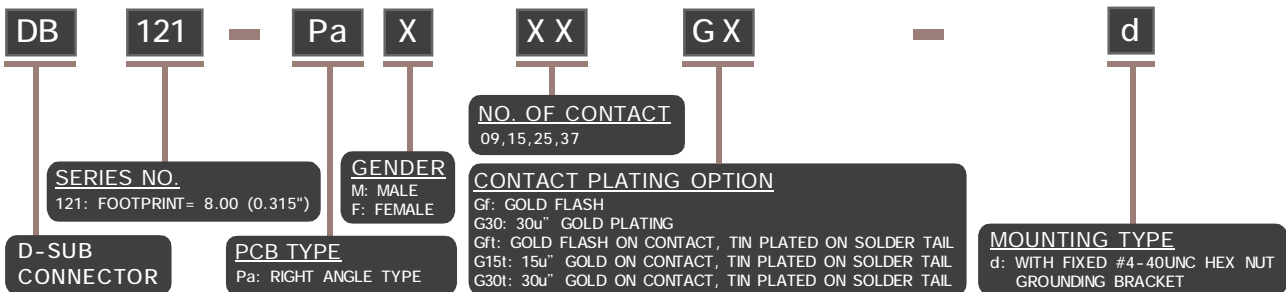

ELECTRICAL CHARACTERISTIC

CONTACT CURRENT RATING: 5 AMP
 CONTACT RESISTANCE: 25 M OHM MAX.
 INSULATION RESISTANCE: 5000 OHM MIN. AT 500V DC
 DIELECTRIC WITHSTANDING VOLTAGE: AC 1000V / MIN. R.M.S
 OPERATING TEMPERATURE: -55°C - +105°C

MATERIALS

INSULATOR: P.B.T. UL 94V-0 RATED
 SHELL: COLD ROLLER STEEL, NICKEL PLATED
 CONTACTS: BRASS, GOLD/TIN PLATED OR GOLDPLATED

NOTE : SOME SIZES, STYLES AND OPTION ARE NON-STANDARD, NON-CANCELLABLE, NON-RETURNABLE

D-SUB 121 SERIES *MOUNTING TYPE e or en* RIGHT ANGLE TYPE - Pa

MALE

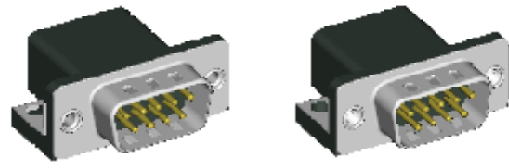
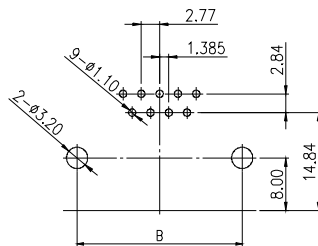
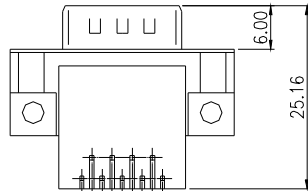
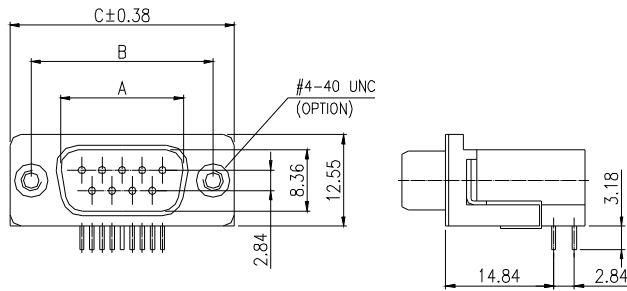

WITHOUT 4#-40UNC THREAD INSERT WITH 4#-40UNC THREAD INSERT

MODEL NO.	NO.OF CONTACTS (SHELL SIZE)	DIMENSION		
		A	B	C
DB121-PaM09GX-X	9P	16.92	24.99	30.81
DB121-PaM15GX-X	15P	25.25	33.32	39.14
DB121-PaM25GX-X	25P	38.96	47.04	53.04
DB121-PaM37GX-X	37P	55.42	63.50	69.32

FEMALE

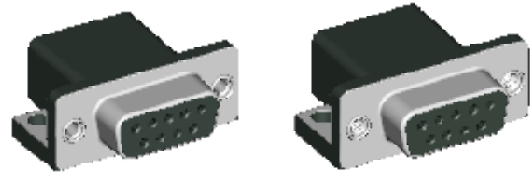
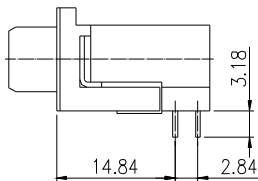
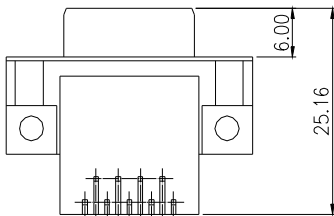
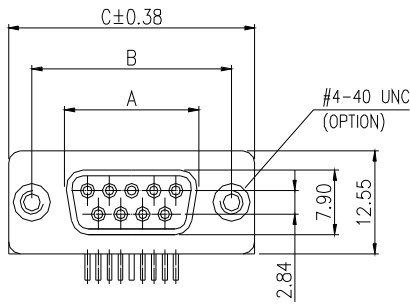

WITHOUT 4#-40UNC THREAD INSERT WITH 4#-40UNC THREAD INSERT

MODEL NO.	NO.OF CONTACTS (SHELL SIZE)	DIMENSION		
		A	B	C
DB121-PaF09GX-X	9P	16.30	24.99	30.81
DB121-PaF15GX-X	15P	24.66	33.32	39.14
DB121-PaF25GX-X	25P	38.38	47.04	53.04
DB121-PaF37GX-X	37P	54.83	63.50	69.32

DB **121** - **Pa** **X** **XX** **GX** - **e & en**

<p>SERIES NO. 121: FOOTPRINT= 8.00 (0.315")</p> <p>D-SUB CONNECTOR</p>	<p>GENDER M: MALE F: FEMALE</p> <p>PCB TYPE Pa: RIGHT ANGLE TYPE</p>	<p>NO. OF CONTACT 09, 15, 25, 37</p> <p>CONTACT PLATING OPTION Gf: GOLD FLASH G30: 30u" GOLD PLATING Gft: GOLD FLASH ON CONTACT, TIN PLATED ON SOLDER TAIL G15t: 15u" GOLD ON CONTACT, TIN PLATED ON SOLDER TAIL G30t: 30u" GOLD ON CONTACT, TIN PLATED ON SOLDER TAIL</p>	<p>MOUNTING TYPE e: WITH #4-40UNC THREAD INSERT GROUNDING STRAP en: WITHOUT #4-40UNC THREAD INSERT WITH GROUNDING STRAP</p>
--	--	--	--

ELECTRICAL CHARACTERISTIC
 CONTACT CURRENT RATING: 5 AMP
 CONTACT RESISTANCE: 25 M OHM MAX.
 INSULATION RESISTANCE: 5000 OHM MIN. AT 500V DC
 DIELECTRIC WITHSTANDING VOLTAGE: AC 1000V / MIN. R.M.S
 OPERATING TEMPERATURE:-55°C~ +105°C

MATERIALS
 INSULATOR: P.B.T. UL 94V-0 RATED
 SHELL: COLD ROLLER STEEL, NICKEL PLATED
 CONTACTS: BRASS, GOLD/TIN PLATED OR GOLDPLATED

NOTE : SOME SIZES, STYLES AND OPTION ARE NON-STANDARD, NON-CANCELLABLE, NON-RETURNABLE

D-SUB 121 SERIES *MOUNTING TYPE rd* RIGHT ANGLE TYPE - Pa

MALE

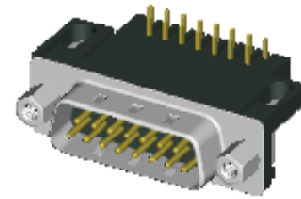
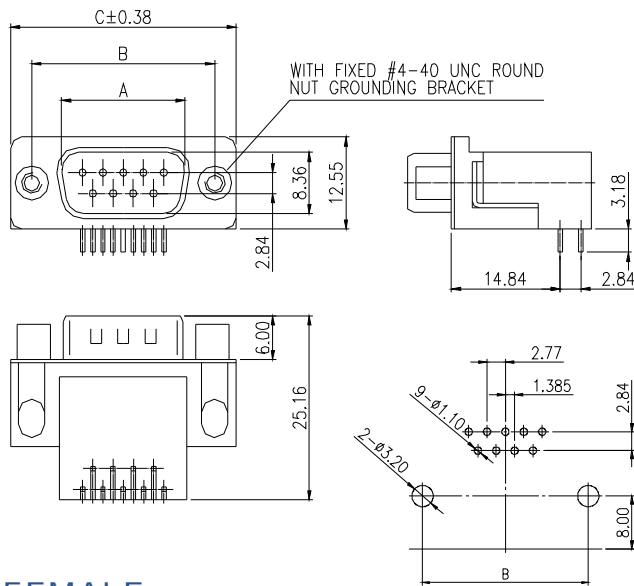

MODEL NO.	NO.OF CONTACTS (SHELL SIZE)	DIMENSION		
		A	B	C
DB121-PaM09GX-RD	9P	16.92	24.99	30.81
DB121-PaM15GX-RD	15P	25.25	33.32	39.14
DB121-PaM25GX-RD	25P	38.96	47.04	53.04
DB121-PaM37GX-RD	37P	55.42	63.50	69.32

HEX NUT DETAIL (4/1)

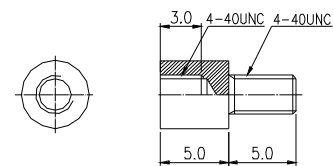

ROUND NUT (RSW-4-40) 2PCS ARE OPTIONS

P.C.BOARD LAYOUT

FEMALE

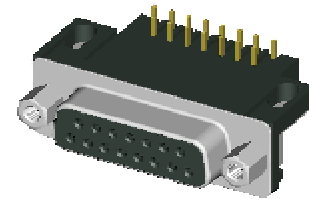
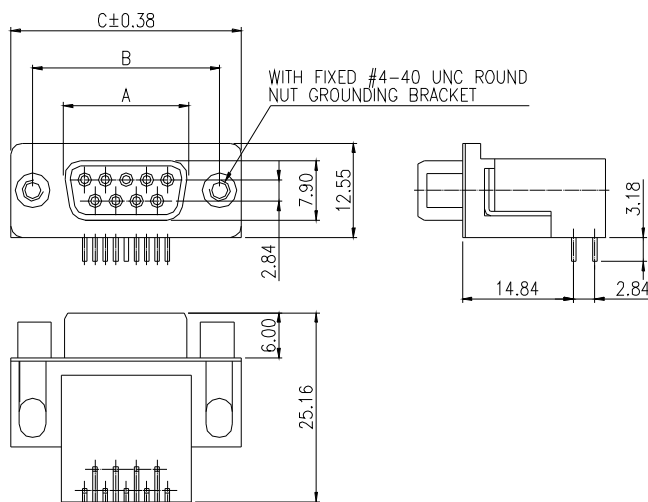

MODEL NO.	NO.OF CONTACTS (SHELL SIZE)	DIMENSION		
		A	B	C
DB121-PaF09GX-RD	9P	16.30	24.99	30.81
DB121-PaF15GX-RD	15P	24.66	33.32	39.14
DB121-PaF25GX-RD	25P	38.38	47.04	53.04
DB121-PaF37GX-RD	37P	54.83	63.50	69.32

DB	121	-	Pa	X	XX	GX	-	rd
SERIES NO. 121: FOOTPRINT= 8.00 (0.315")		GENDER M: MALE F: FEMALE		NO. OF CONTACT 09, 15, 25, 37		CONTACT PLATING OPTION Gf: GOLD FLASH G30: 30u" GOLD PLATING Gf: GOLD FLASH ON CONTACT, TIN PLATED ON SOLDER TAIL G15t: 15u" GOLD ON CONTACT, TIN PLATED ON SOLDER TAIL G30t: 30u" GOLD ON CONTACT, TIN PLATED ON SOLDER TAIL		MOUNTING TYPE d: WITH FIXED #4-40UNC ROUND NUT GROUNDING BRACKET
D-SUB CONNECTOR		PCB TYPE Pa: RIGHT ANGLE TYPE						

ELECTRICAL CHARACTERISTIC

CONTACT CURRENT RATING: 5 AMP
 CONTACT RESISTANCE: 25 M OHM MAX.
 INSULATION RESISTANCE: 5000 OHM MIN. AT 500V DC
 DIELECTRIC WITHSTANDING VOLTAGE: AC 1000V / MIN. R.M.S
 OPERATING TEMPERATURE: -55°C - +105°C

MATERIALS

INSULATOR: P.B.T. UL 94V-0 RATED
 SHELL: COLD ROLLER STEEL, NICKEL PLATED
 CONTACTS: BRASS, GOLD/TIN PLATED OR GOLDPLATED

NOTE : SOME SIZES, STYLES AND OPTION ARE NON-STANDARD, NON-CANCELLABLE, NON-RETURNABLE

D-SUB 130 SERIES *MOUNTING TYPE* 2a TYPE - Rt

MALE

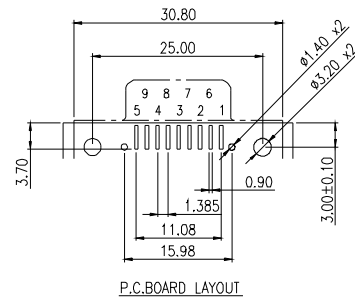
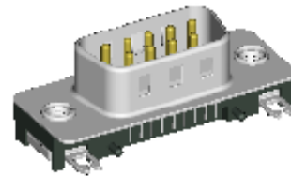
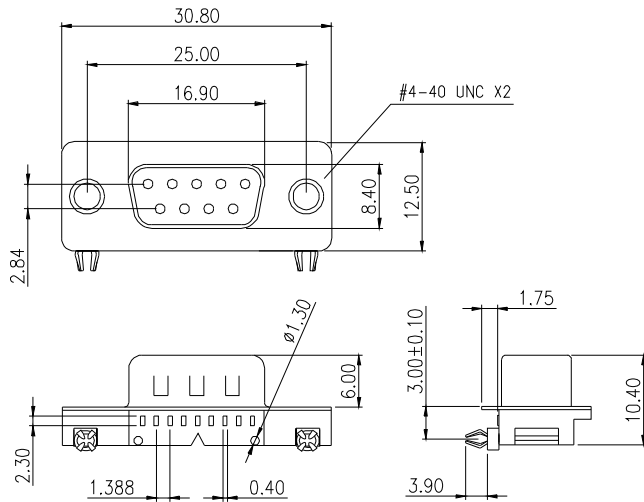

FEMALE

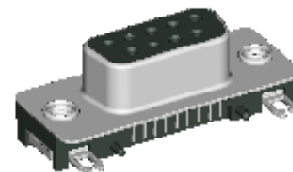
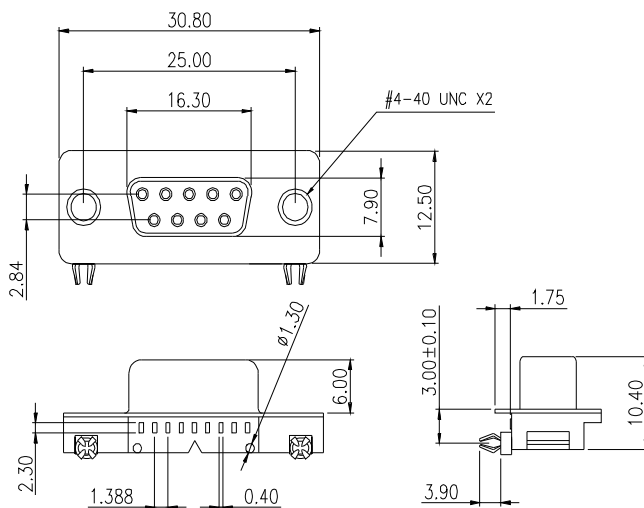

DB	130	-	Rt	X	09	GX	-	2	a
D-SUB CONNECTOR	SERIES NO.		GENDER M: MALE F: FEMALE		NO. OF CONTACT 09	CONTACT PLATING OPTION Gf: GOLD FLASH G30: 30u" GOLD PLATING Gf1: GOLD FLASH ON CONTACT, TIN PLATED ON SOLDER TAIL G15t: 15u" GOLD ON CONTACT, TIN PLATED ON SOLDER TAIL G30t: 30u" GOLD ON CONTACT, TIN PLATED ON SOLDER TAIL		BOARDLOCK OPTION 2: 2 PRONG BOARD LOCK	MOUNTING TYPE a: WITH #4-40UNC THREAD INSERT GROUNDING BRACKET & BOARDLOCK
	PCB TYPE Rt: RIGHT ANGLE SURFACE MOUNT								

ELECTRICAL CHARACTERISTIC

CONTACT CURRENT RATING: 5 AMP
 CONTACT RESISTANCE: 25 M OHM MAX.
 INSULATION RESISTANCE: 5000 OHM MIN. AT 500V DC
 DIELECTRIC WITHSTANDING VOLTAGE: AC 1000V / MIN. R.M.S
 OPERATING TEMPERATURE:-55°C~ +105°C

MATERIALS

INSULATOR: P.B.T. UL 94V-0 RATED
 SHELL: COLD ROLLER STEEL, NICKEL PLATED
 CONTACTS: BRASS, GOLD/TIN PLATED OR GOLDPLATED

NOTE : SOME SIZES, STYLES AND OPTION ARE NON-STANDARD, NON-CANCELLABLE, NON-RETURNABLE

D-SUB 131 SERIES *MOUNTING TYPE* 2a RIGHT ANGLE TYPE - Pa

MALE

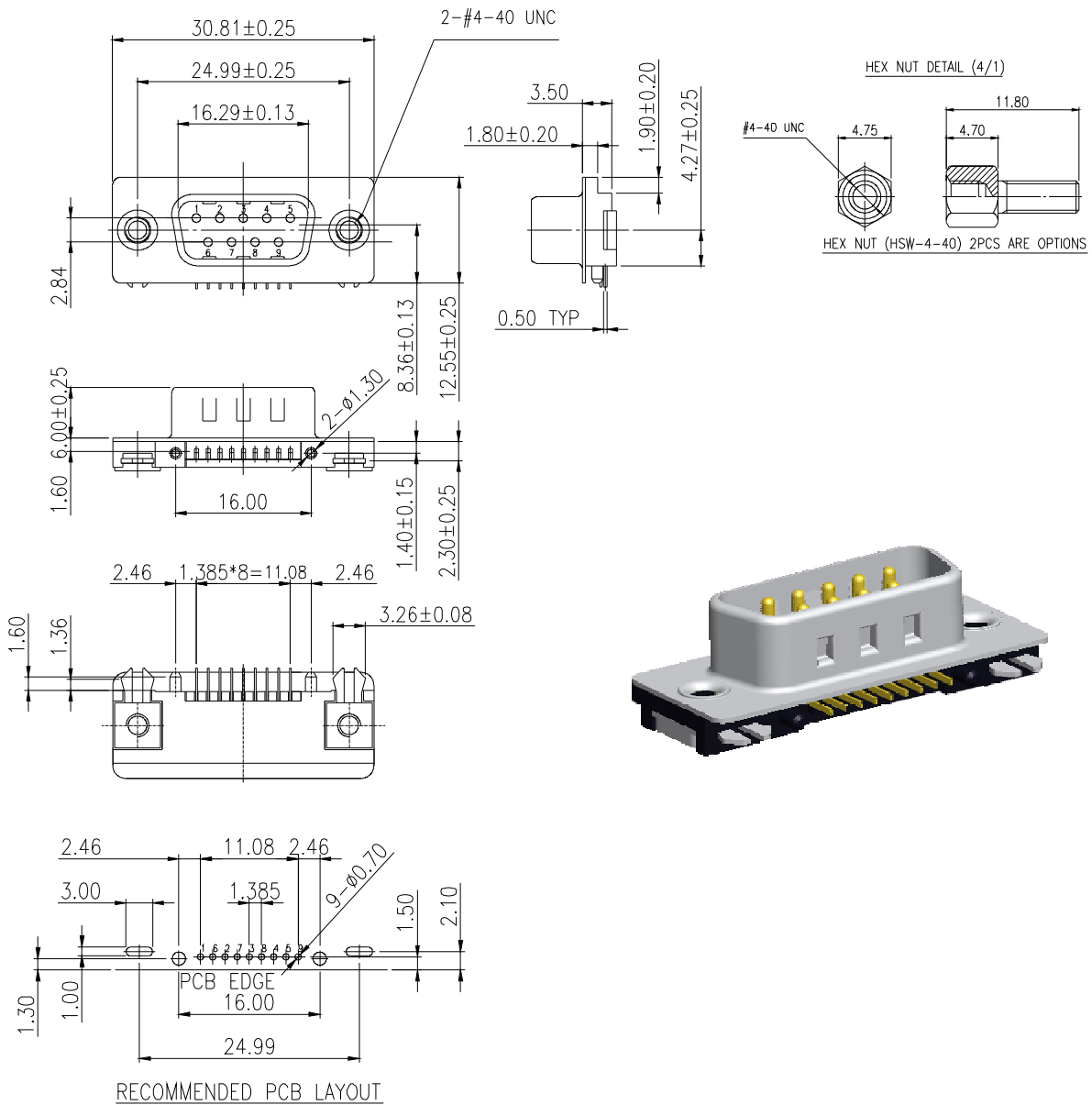

DB	131	Pa	M	09	GX	2	a
D-SUB CONNECTOR	SERIES NO. 131: FOOTPRINT= 1.60 (0.063")	PCB TYPE Pa: RIGHT ANGLE TYPE	GENDER M: MALE	NO. OF CONTACT 09	CONTACT PLATING OPTION Gf: GOLD FLASH G30: 30u" GOLD PLATING Gf1: GOLD FLASH ON CONTACT, TIN PLATED ON SOLDER TAIL G15t: 15u" GOLD ON CONTACT, TIN PLATED ON SOLDER TAIL G30t: 30u" GOLD ON CONTACT, TIN PLATED ON SOLDER TAIL	BOARDLOCK OPTION 2: 2 PRONG BOARD LOCK	MOUNTING TYPE a: WITH #4-40UNC THREAD INSERT GROUNDING BRACKET & BOARDLOCK

ELECTRICAL CHARACTERISTIC

CONTACT CURRENT RATING: 5 AMP
 CONTACT RESISTANCE: 25 M OHM MAX.
 INSULATION RESISTANCE: 5000 OHM MIN. AT 500V DC
 DIELECTRIC WITHSTANDING VOLTAGE: AC 1000V / MIN. R.M.S
 OPERATING TEMPERATURE:-55°C- +105°C

MATERIALS

INSULATOR: P.B.T. UL 94V-0 RATED
 SHELL: COLD ROLLER STEEL, NICKEL PLATED
 CONTACTS: BRASS, GOLD/TIN PLATED OR GOLDPLATED

NOTE : SOME SIZES, STYLES AND OPTION ARE NON-STANDARD, NON-CANCELLABLE, NON-RETURNABLE

D-SUB 132 SERIES *MOUNTING TYPE 2a* RIGHT ANGLE TYPE - Pa

FEMALE

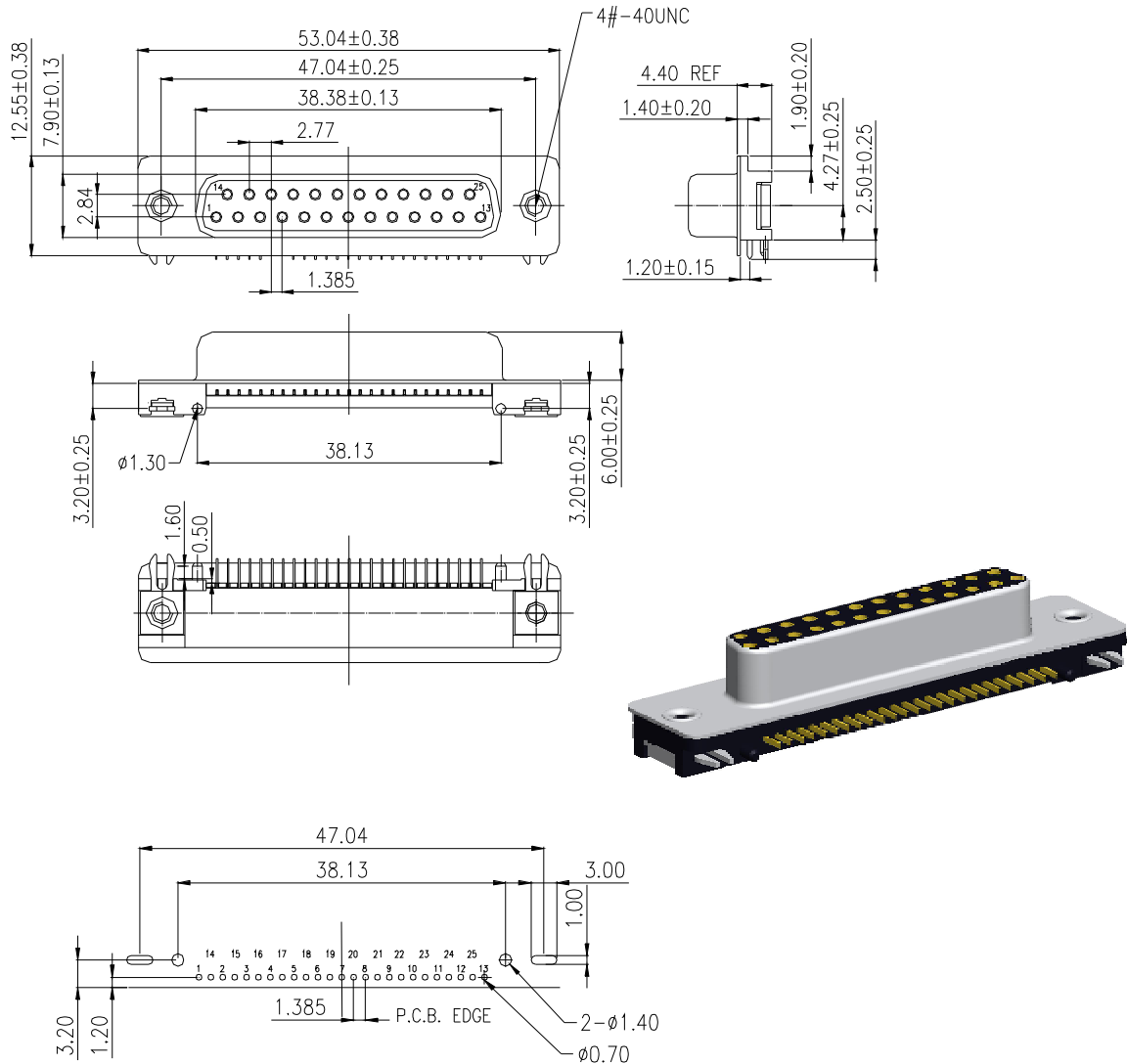

RECOMMENDED P.C.B. LAYOUT

DB	132	Pa	X	25	GX	2	a
D-SUB CONNECTOR	SERIES NO. 132: FOOTPRINT= 1.20 (0.47")	PCB TYPE Pa: RIGHT ANGLE TYPE	GENDER M: MALE F: FEMALE	NO. OF CONTACT 25	CONTACT PLATING OPTION Gf: GOLD FLASH G30: 30u" GOLD PLATING Gft: GOLD FLASH ON CONTACT, TIN PLATED ON SOLDER TAIL G15: 15u" GOLD ON CONTACT, TIN PLATED ON SOLDER TAIL G30t: 30u" GOLD ON CONTACT, TIN PLATED ON SOLDER TAIL	BOARDLOCK OPTION 2: 2 PRONG BOARD LOCK	MOUNTING TYPE a: WITH #4-40UNC THREAD INSERT GROUNDING BRACKET & BOARDLOCK

ELECTRICAL CHARACTERISTIC

CONTACT CURRENT RATING: 5 AMP
 CONTACT RESISTANCE: 25 M OHM MAX.
 INSULATION RESISTANCE: 5000 OHM MIN. AT 500V DC
 DIELECTRIC WITHSTANDING VOLTAGE: AC 1000V / MIN. R.M.S
 OPERATING TEMPERATURE:-55°C~ +105°C

MATERIALS

INSULATOR: P.B.T. UL 94V-0 RATED
 SHELL: COLD ROLLER STEEL, NICKEL PLATED
 CONTACTS: BRASS, GOLD/TIN PLATED OR GOLD PLATED

NOTE : SOME SIZES, STYLES AND OPTION ARE NON-STANDARD, NON-CANCELLABLE, NON-RETURNABLE

D-SUB 160 SERIES *MOUNTING TYPE 2a* RIGHT ANGLE TYPE - Pa

MALE

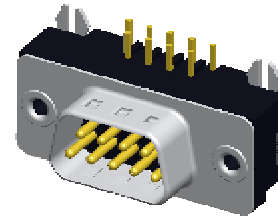
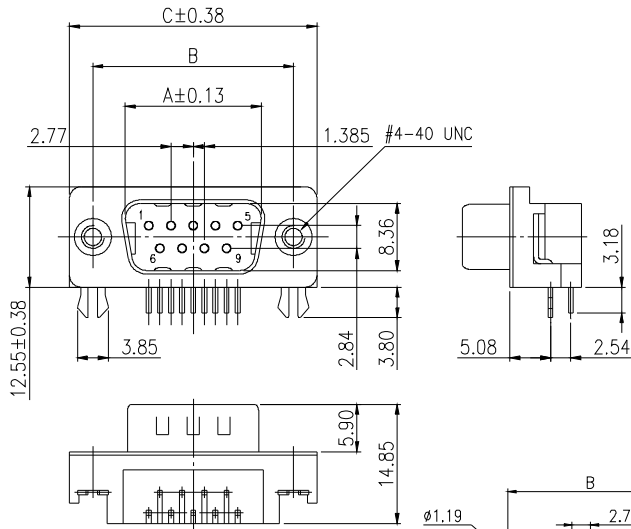

MODEL NO.	NO.OF CONTACTS (SHELL SIZE)	DIMENSION		
		A	B	C
DB160-PaM09GX-2a	9P	16.92	24.99	30.81
DB160-PaM15GX-2a	15P	25.25	33.32	39.14
DB160-PaM25GX-2a	25P	38.96	47.04	53.04

FEMALE

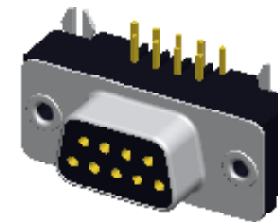
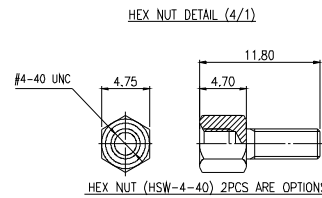
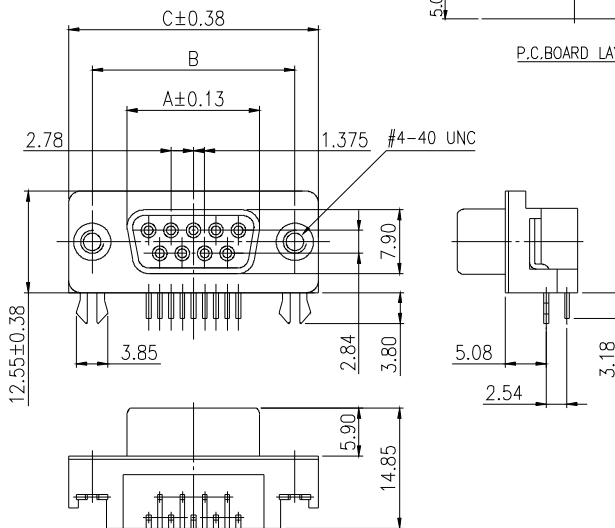

MODEL NO.	NO.OF CONTACTS (SHELL SIZE)	DIMENSION		
		A	B	C
DB160-PaF09GX-2a	9P	16.92	24.99	30.81
DB160-PaF15GX-2a	15P	25.25	33.32	39.14
DB160-PaF25GX-2a	25P	38.96	47.04	53.04

DB	160	Pa	X	XX	GX	2	a
D-SUB CONNECTOR	SERIES NO. 160: FOOTPRINT= 5.08 (0.200")	PCB TYPE Pa: RIGHT ANGLE TYPE	GENDER M: MALE F: FEMALE	NO. OF CONTACT 09, 15, 25	CONTACT PLATING OPTION Gf: GOLD FLASH G30: 30u" GOLD PLATING Gf: GOLD FLASH ON CONTACT, TIN PLATED ON SOLDER TAIL G15t: 15u" GOLD ON CONTACT, TIN PLATED ON SOLDER TAIL G30t: 30u" GOLD ON CONTACT, TIN PLATED ON SOLDER TAIL	BOARDLOCK OPTION 2: 2 PRONG BOARD LOCK	MOUNTING TYPE a: WITH #4-40UNC THREAD INSERT GROUNDING BRACKET & BOARDLOCK

ELECTRICAL CHARACTERISTIC
 CONTACT CURRENT RATING: 5 AMP
 CONTACT RESISTANCE: 25 M OHM MAX.
 INSULATION RESISTANCE: 5000 OHM MIN. AT 500V DC
 DIELECTRIC WITHSTANDING VOLTAGE: AC 1000V / MIN. R.M.S
 OPERATING TEMPERATURE:-55°C- +105°C

MATERIALS
 INSULATOR: P.B.T. UL 94V-0 RATED
 SHELL: COLD ROLLER STEEL, NICKEL PLATED
 CONTACTS: BRASS, GOLD/TIN PLATED OR GOLD PLATED

NOTE : SOME SIZES, STYLES AND OPTION ARE NON-STANDARD, NON-CANCELLABLE, NON-RETURNABLE

D-SUB 160 SERIES *MOUNTING TYPE b* RIGHT ANGLE TYPE - Pa

MALE

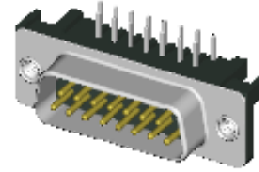
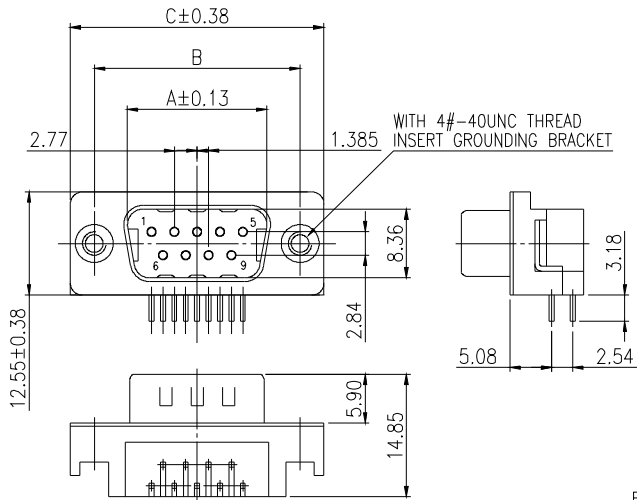

MODEL NO.	NO.OF CONTACTS (SHELL SIZE)	DIMENSION		
		A	B	C
DB160-PaM09GX-b	9P	16.92	24.99	30.81
DB160-PaM15GX-b	15P	25.25	33.32	39.14
DB160-PaM25GX-b	25P	38.96	47.04	53.04

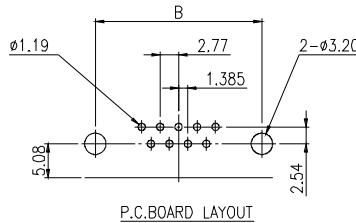

HEX NUT DETAIL (4/1)

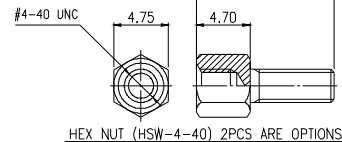

FEMALE

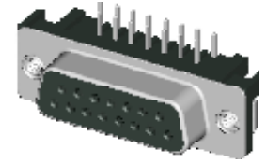
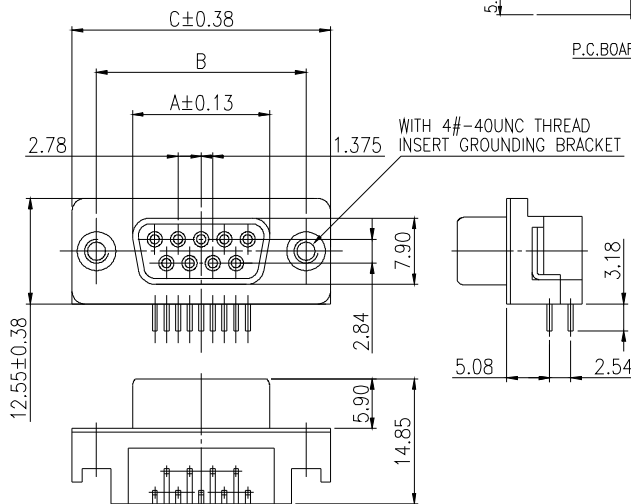

MODEL NO.	NO.OF CONTACTS (SHELL SIZE)	DIMENSION		
		A	B	C
DB160-PaF09GX-b	9P	16.92	24.99	30.81
DB160-PaF15GX-b	15P	25.25	33.32	39.14
DB160-PaF25GX-b	25P	38.96	47.04	53.04

DB	160	Pa	X	XX	GX	b
D-SUB CONNECTOR	SERIES NO. 160: FOOTPRINT = 5.08 (0.200")	PCB TYPE Pa: RIGHT ANGLE TYPE	GENDER M: MALE F: FEMALE	NO. OF CONTACT 09, 15, 25	CONTACT PLATING OPTION Gf: GOLD FLASH G30: 30u" GOLD PLATING Gf1: GOLD FLASH ON CONTACT, TIN PLATED ON SOLDER TAIL G15t: 15u" GOLD ON CONTACT, TIN PLATED ON SOLDER TAIL G30t: 30u" GOLD ON CONTACT, TIN PLATED ON SOLDER TAIL	MOUNTING TYPE b: WITH #4-40UNC THREAD INSERT GROUNDING BRACKET

ELECTRICAL CHARACTERISTIC

CONTACT CURRENT RATING: 5 AMP
 CONTACT RESISTANCE: 25 M OHM MAX.
 INSULATION RESISTANCE: 5000 OHM MIN. AT 500V DC
 DIELECTRIC WITHSTANDING VOLTAGE: AC 1000V / MIN. R.M.S
 OPERATING TEMPERATURE: -55°C ~ +105°C

MATERIALS

INSULATOR: P.B.T. UL 94V-0 RATED
 SHELL: COLD ROLLER STEEL, NICKEL PLATED
 CONTACTS: BRASS, GOLD/TIN PLATED OR GOLD PLATED

NOTE : SOME SIZES, STYLES AND OPTION ARE NON-STANDARD, NON-CANCELLABLE, NON-RETURNABLE

D-SUB 160 SERIES *MOUNTING TYPE c & 2rc* RIGHT ANGLE TYPE - Pa

MALE

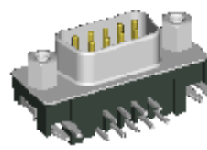
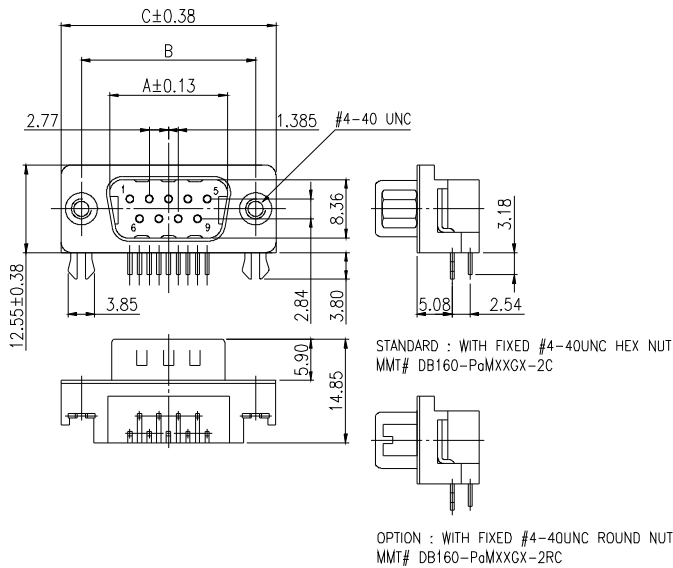

WITH
4#-40UNC HEX NUT

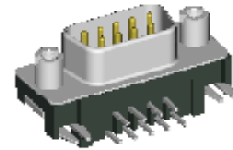

WITH
4#-40UNC ROUND NUT

MODEL NO.	NO.OF CONTACTS (SHELL SIZE)	DIMENSION		
		A	B	C
DB160-PoM09GX-2XC	9P	16.92	24.99	30.81
DB160-PoM15GX-2XC	15P	25.25	33.32	39.14
DB160-PoM25GX-2XC	25P	38.96	47.04	53.04

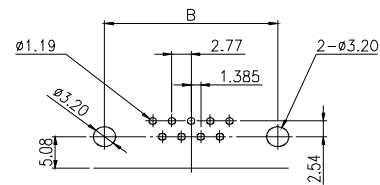

FEMALE

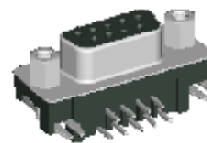
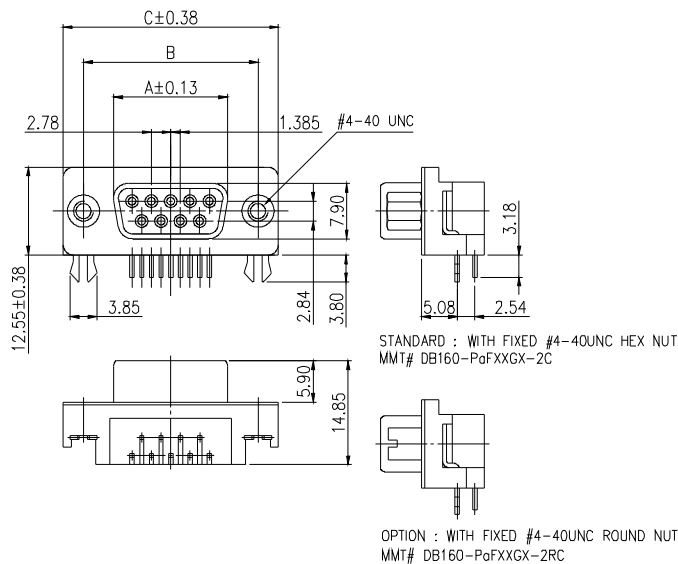

WITH
4#-40UNC HEX NUT

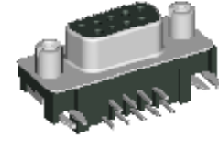

WITH
4#-40UNC ROUND NUT

MODEL NO.	NO.OF CONTACTS (SHELL SIZE)	DIMENSION		
		A	B	C
DB160-PoF09GX-2XC	9P	16.92	24.99	30.81
DB160-PoF15GX-2XC	15P	25.25	33.32	39.14
DB160-PoF25GX-2XC	25P	38.96	47.04	53.04

DB - **160** - **Pa** **X** **XX** **GX** - **2** **c & rc**

SERIES NO.

160: FOOTPRINT= 5.08 (0.200")

GENDER

M: MALE
F: FEMALE

NO. OF CONTACT

09, 15, 25

BOARDLOCK OPTION

2: 2 PRONG BOARD LOCK

CONTACT PLATING OPTION

Gf: GOLD FLASH
G30: 30u" GOLD PLATING
Gf: GOLD FLASH ON CONTACT, TIN PLATED ON SOLDER TAIL
G15t: 15u" GOLD ON CONTACT, TIN PLATED ON SOLDER TAIL
G30t: 30u" GOLD ON CONTACT, TIN PLATED ON SOLDER TAIL

MOUNTING TYPE

c: WITH FIXED #4-40UNC HEX NUT
GROUNDING BRACKET & BOARDLOCK
rc: WITH FIXED #4-40UNC ROUND NUT
GROUNDING BRACKET & BOARDLOCK

D-SUB CONNECTOR

PCB TYPE

Pa: RIGHT ANGLE TYPE

ELECTRICAL CHARACTERISTIC

CONTACT CURRENT RATING: 5 AMP
CONTACT RESISTANCE: 25 M OHM MAX.
INSULATION RESISTANCE: 5000 OHM MIN. AT 500V DC
DIELECTRIC WITHSTANDING VOLTAGE: AC 1000V / MIN. R.M.S
OPERATING TEMPERATURE:-55°C- +105°C

MATERIALS

INSULATOR: P.B.T. UL 94V-0 RATED
SHELL: COLD ROLLER STEEL, NICKEL PLATED
CONTACTS: BRASS, GOLD/TIN PLATED OR GOLD PLATED

NOTE : SOME SIZES, STYLES AND OPTION ARE NON-STANDARD, NON-CANCELLABLE, NON-RETURNABLE

D-SUB 160 SERIES *MOUNTING TYPE d* RIGHT ANGLE TYPE - Pa

MALE

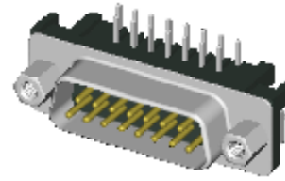
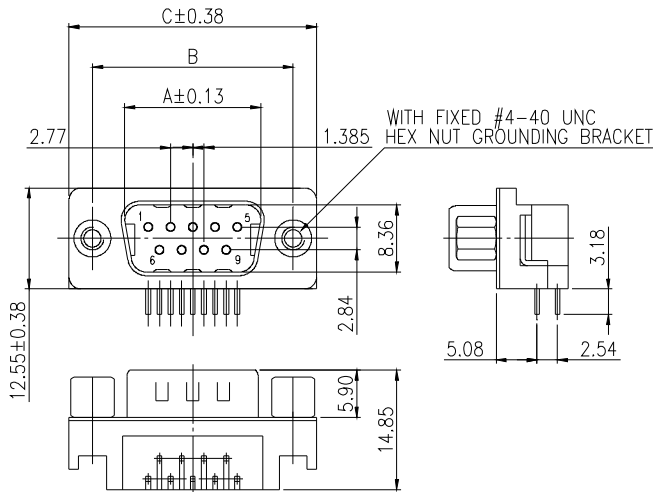

MODEL NO.	NO.OF CONTACTS (SHELL SIZE)	DIMENSION		
		A	B	C
DB160-PoM09GX-D	9P	16.92	24.99	30.81
DB160-PoM15GX-D	15P	25.25	33.32	39.14
DB160-PoM25GX-D	25P	38.96	47.04	53.04

HEX NUT DETAIL (4/1)

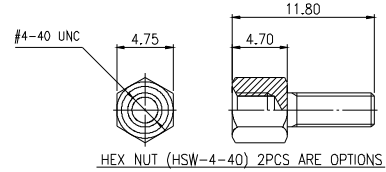
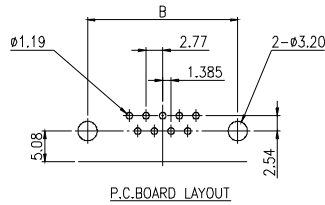

FEMALE

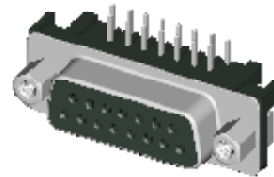
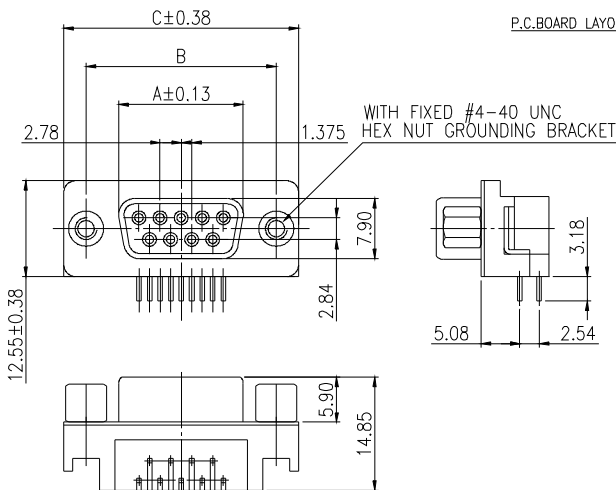

MODEL NO.	NO.OF CONTACTS (SHELL SIZE)	DIMENSION		
		A	B	C
DB160-PoF09GX-D	9P	16.92	24.99	30.81
DB160-PoF15GX-D	15P	25.25	33.32	39.14
DB160-PoF25GX-D	25P	38.96	47.04	53.04

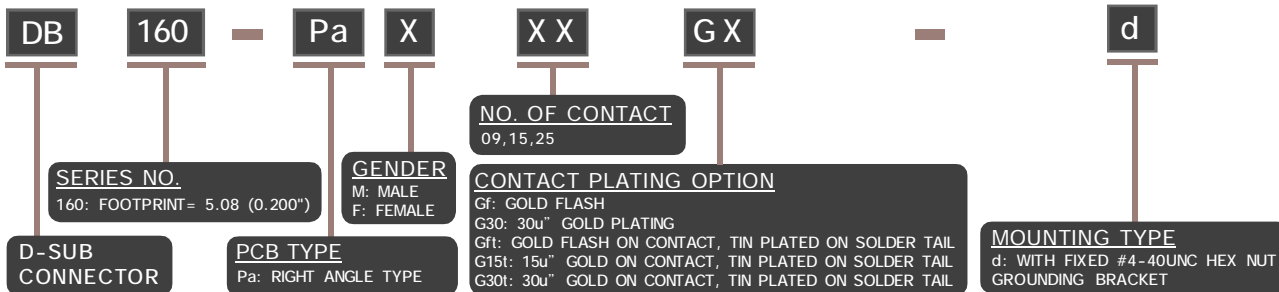

ELECTRICAL CHARACTERISTIC

CONTACT CURRENT RATING: 5 AMP
 CONTACT RESISTANCE: 25 M OHM MAX.
 INSULATION RESISTANCE: 5000 OHM MIN. AT 500V DC
 DIELECTRIC WITHSTANDING VOLTAGE: AC 1000V / MIN. R.M.S
 OPERATING TEMPERATURE:-55°C~ +105°C

MATERIALS

INSULATOR: P.B.T. UL 94V-0 RATED
 SHELL: COLD ROLLER STEEL, NICKEL PLATED
 CONTACTS: BRASS, GOLD/TIN PLATED OR GOLD PLATED

NOTE : SOME SIZES, STYLES AND OPTION ARE NON-STANDARD, NON-CANCELLABLE, NON-RETURNABLE

D-SUB 160 SERIES *MOUNTING TYPE rd* RIGHT ANGLE TYPE - Pa

MALE

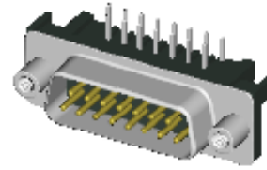
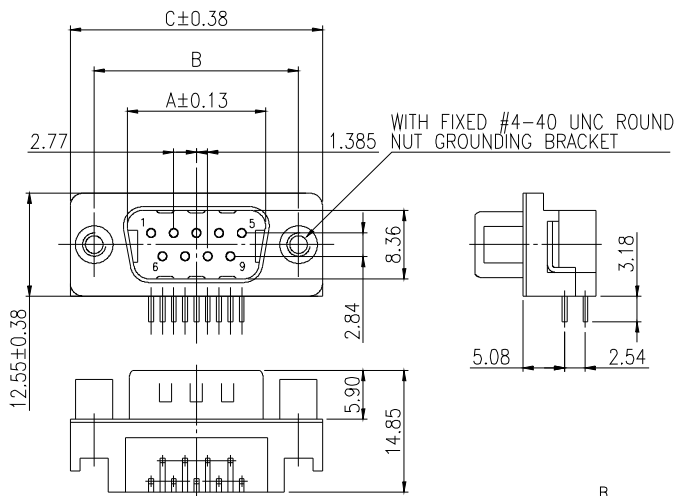

MODEL NO.	NO.OF CONTACTS (SHELL SIZE)	DIMENSION		
		A	B	C
DB160-PaM09GX-RD	9P	16.92	24.99	30.81
DB160-PaM15GX-RD	15P	25.25	33.32	39.14
DB160-PaM25GX-RD	25P	38.96	47.04	53.04

FEMALE

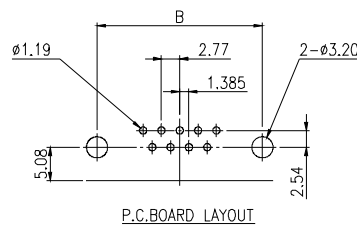
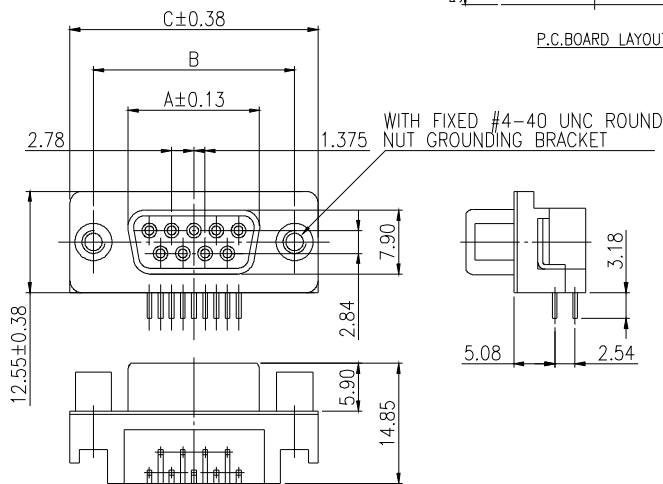

HEX NUT DETAIL (4/1)

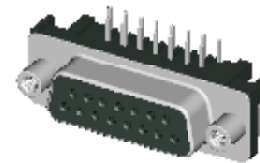
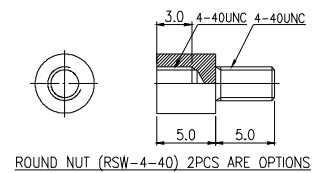

MODEL NO.	NO.OF CONTACTS (SHELL SIZE)	DIMENSION		
		A	B	C
DB160-PaF09GX-RD	9P	16.92	24.99	30.81
DB160-PaF15GX-RD	15P	25.25	33.32	39.14
DB160-PaF25GX-RD	25P	38.96	47.04	53.04

DB	160	Pa	X	XX	GX	rd
D-SUB CONNECTOR	SERIES NO. 160: FOOTPRINT = 5.08 (0.200")	PCB TYPE Pa: RIGHT ANGLE TYPE	GENDER M: MALE F: FEMALE	NO. OF CONTACT 09, 15, 25	CONTACT PLATING OPTION Gf: GOLD FLASH G30: 30u" GOLD PLATING Gf: GOLD FLASH ON CONTACT, TIN PLATED ON SOLDER TAIL G15: 15u" GOLD ON CONTACT, TIN PLATED ON SOLDER TAIL G30: 30u" GOLD ON CONTACT, TIN PLATED ON SOLDER TAIL	MOUNTING TYPE rd: WITH FIXED #4-40UNC ROUND NUT GROUNDING BRACKET

ELECTRICAL CHARACTERISTIC
 CONTACT CURRENT RATING: 5 AMP
 CONTACT RESISTANCE: 25 M OHM MAX.
 INSULATION RESISTANCE: 5000 OHM MIN. AT 500V DC
 DIELECTRIC WITHSTANDING VOLTAGE: AC 1000V / MIN. R.M.S
 OPERATING TEMPERATURE: -55°C - +105°C

MATERIALS
 INSULATOR: P.B.T. UL 94V-0 RATED
 SHELL: COLD ROLLER STEEL, NICKEL PLATED
 CONTACTS: BRASS, GOLD/TIN PLATED OR GOLD PLATED

NOTE : SOME SIZES, STYLES AND OPTION ARE NON-STANDARD, NON-CANCELLABLE, NON-RETURNABLE