

MMI

- MD -
MINI DIN JACK (2)

MINI DIN JACK - RIGHT ANGLE TYPE - Pa

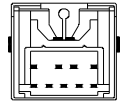
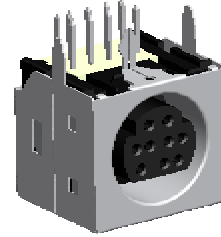
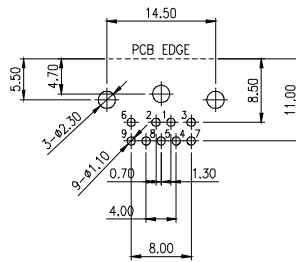
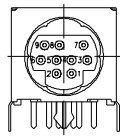

9 OF CONTACTS

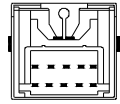
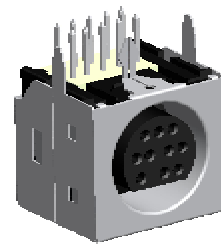
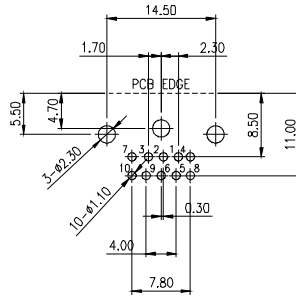
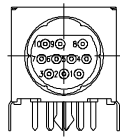

10 OF CONTACTS

MINI DIN JACK - STRAIGHT TYPE - P

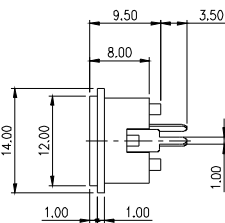
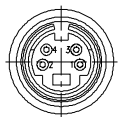

PCB LAYOUT

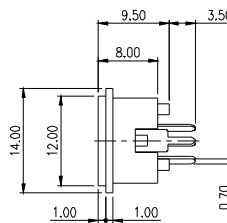
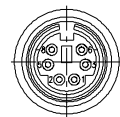

PCB LAYOUT

4 OF CONTACTS

6 OF CONTACTS

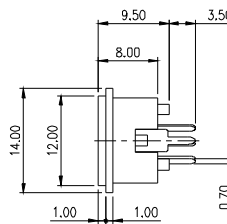
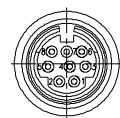

PCB LAYOUT

8 OF CONTACTS

MD

MINI DIN JACK

020

SERIES NO.

P

PCB TYPE
P: STRAIGHT TYPE

XX

NO. OF CONTACTS
04, 06, 08

Gft

CONTACT PLATING OPTION
Gft: GOLD FLASH ON CONTACT,
TIN PLATING ON SOLDER TAIL

NOTE : SOME SIZES, STYLES AND OPTION ARE NON-STANDARD, NON-CANCELLABLE, NON-RETURNABLE

www.mmtmachrone.com

USA TEL : 1-510-979-2188
FAX : 1-510-979-2189

TAIWAN TEL : 886-2-2755-3193
FAX : 886-2-2784-5109

SINGAPORE TEL : 65-6274-0566
FAX : 65-6274-7891

MINI DIN JACK - RIGHT ANGLE TYPE - Pa

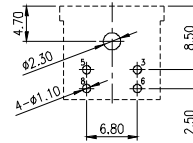
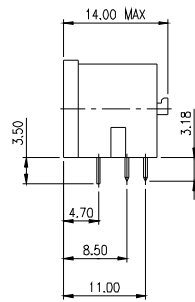
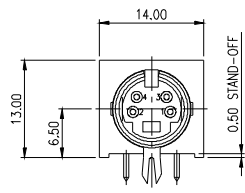

PCB LAYOUT

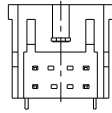

4 OF CONTACTS

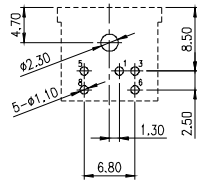
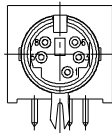
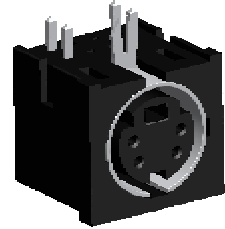

PCB LAYOUT

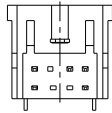

5 OF CONTACTS

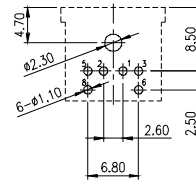
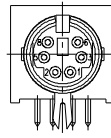
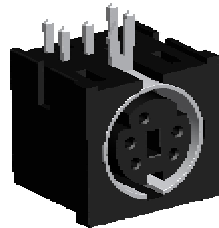

PCB LAYOUT

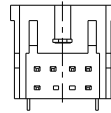

6 OF CONTACTS

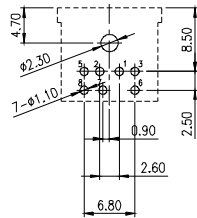
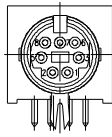
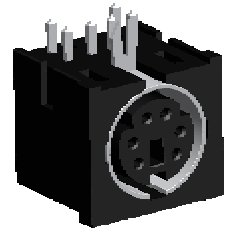

PCB LAYOUT

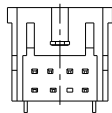

7 OF CONTACTS

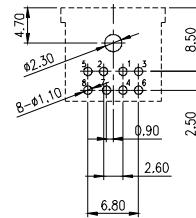
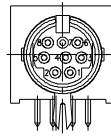
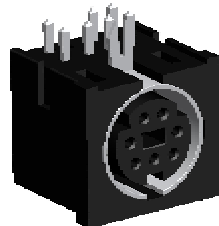

PCB LAYOUT

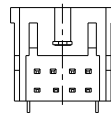

8 OF CONTACTS

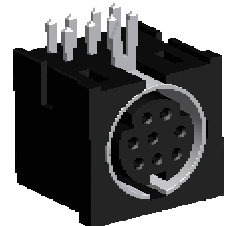

MD

MINI DIN JACK

020

SERIES NO.

Pa

PCB TYPE
Pa: RIGHT ANGLE TYPE

XX

NO. OF CONTACTS
04, 05, 06, 07, 08

Gft

CONTACT PLATING OPTION
Gft: GOLD FLASH ON CONTACT,
TIN PLATING ON SOLDER TAIL

NOTE : SOME SIZES, STYLES AND OPTION ARE NON-STANDARD, NON-CANCELLABLE, NON-RETURNABLE

www.mmtmachrone.com

USA TEL : 1-510-979-2188
FAX : 1-510-979-2189

TAIWAN TEL : 886-2-2755-3193
FAX : 886-2-2784-5109

SINGAPORE TEL : 65-6274-0566
FAX : 65-6274-7891

MINI DIN JACK - STRAIGHT TYPE - P

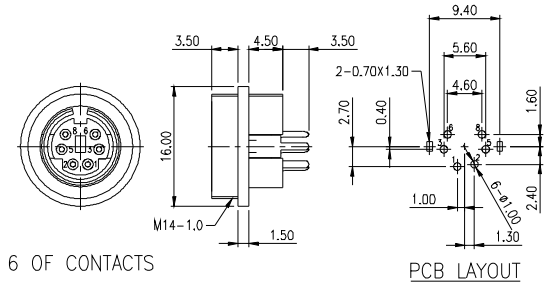
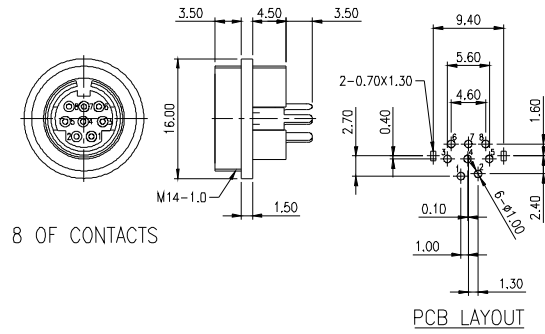
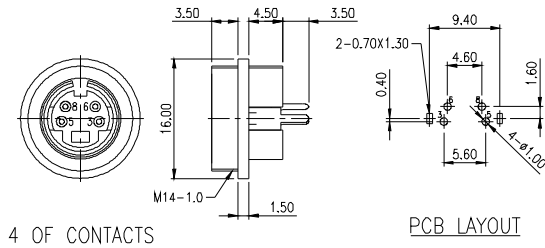

| | | | | |
|---------------|------------|------------------------------|-------------------------------|---|
| MD | 021 | P | XX | Gft |
| MINI DIN JACK | SERIES NO. | PCB TYPE P: STRAIGHT TYPE | NO. OF CONTACTS 04, 06, 08 | CONTACT PLATING OPTION Gft: GOLD FLASH ON CONTACT, TIN PLATING ON SOLDER TAIL |

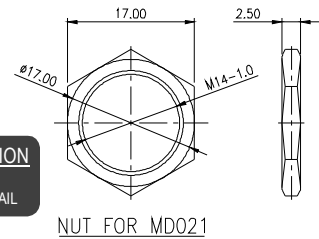

MINI DIN JACK - STRAIGHT TYPE - P

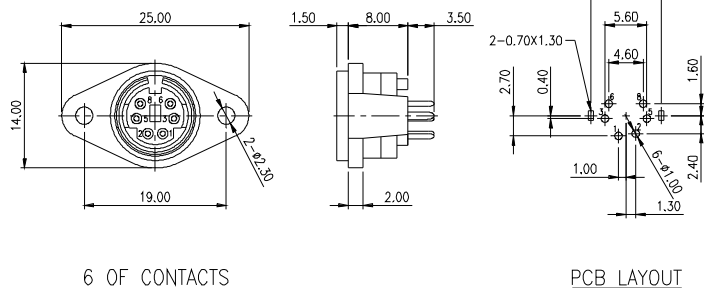
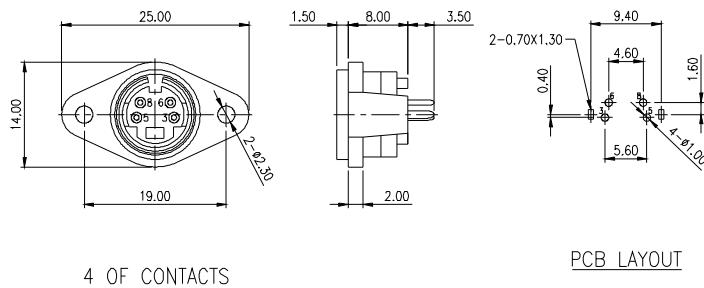

| | | | | |
|---------------|------------|------------------------------|---------------------------|---|
| MD | 024 | P | XX | Gft |
| MINI DIN JACK | SERIES NO. | PCB TYPE P: STRAIGHT TYPE | NO. OF CONTACTS 04, 06 | CONTACT PLATING OPTION Gft: GOLD FLASH ON CONTACT, TIN PLATING ON SOLDER TAIL |

NOTE : SOME SIZES, STYLES AND OPTION ARE NON-STANDARD, NON-CANCELLABLE, NON-RETURNABLE

MINI DIN JACK - RIGHT ANGLE TYPE - Pa

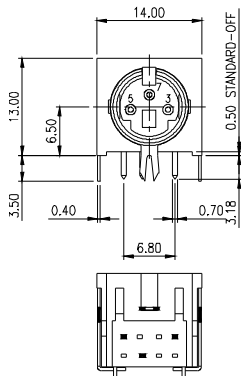

3 OF CONTACTS

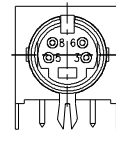
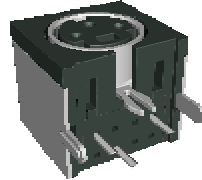
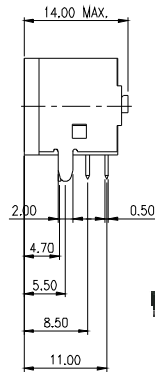

4 OF CONTACTS

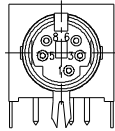
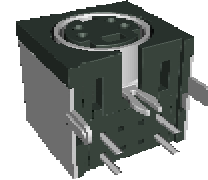
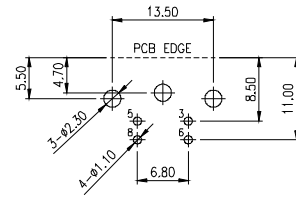

5 OF CONTACTS

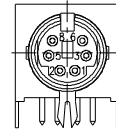
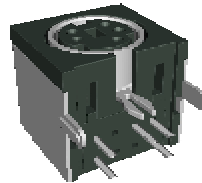
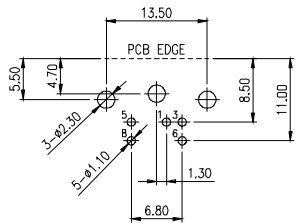

6 OF CONTACTS

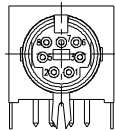
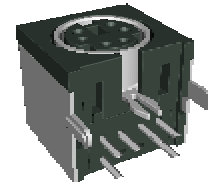
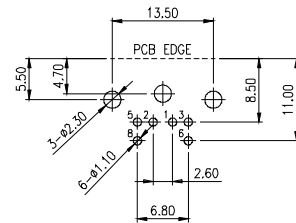

7 OF CONTACTS

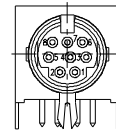
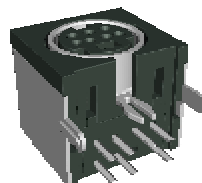
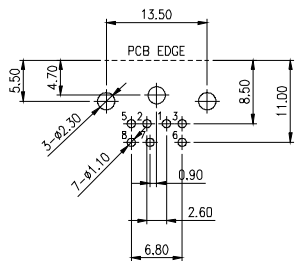

8 OF CONTACTS

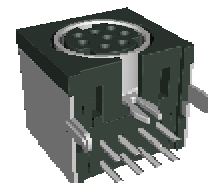
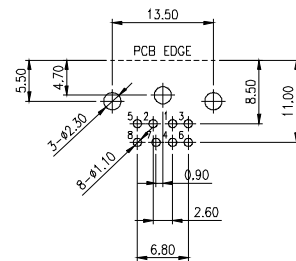

MD

MINI DIN JACK

030

SERIES NO.

Pa

PCB TYPE
Pa: RIGHT ANGLE TYPE

XX

NO. OF CONTACTS
03, 04, 05, 06, 07, 08

X

SHELL PLATING OPTION
T: TIN PLATING
N: NICKLE PLATING

Gft

CONTACT PLATING OPTION
Gf: GOLD FLASH ON CONTACT,
TIN PLATING ON SOLDER TAIL

NOTE : SOME SIZES, STYLES AND OPTION ARE NON-STANDARD, NON-CANCELLABLE, NON-RETURNABLE

MINI DIN JACK - RIGHT ANGLE TYPE - Pa

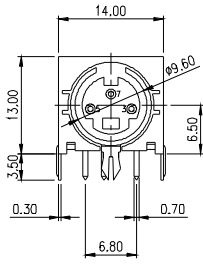

3 OF CONTACTS

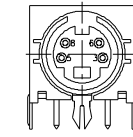
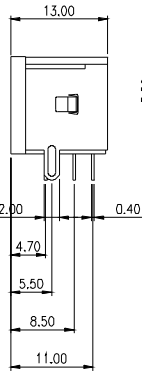

4 OF CONTACTS

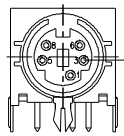
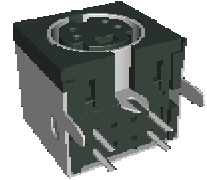
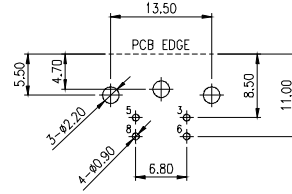

5 OF CONTACTS

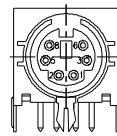
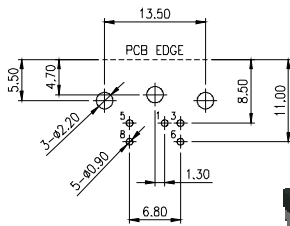

6 OF CONTACTS

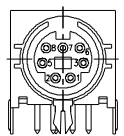
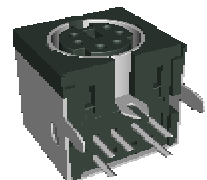
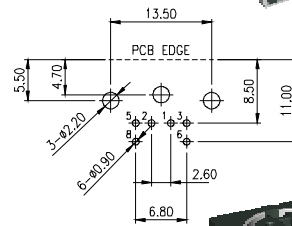

7 OF CONTACTS

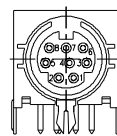
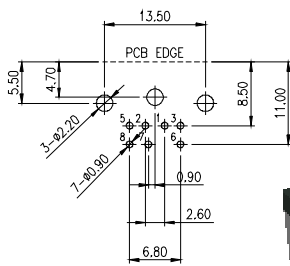

8 OF CONTACTS

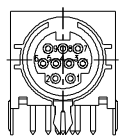
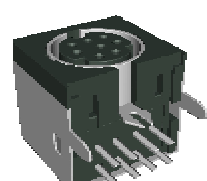
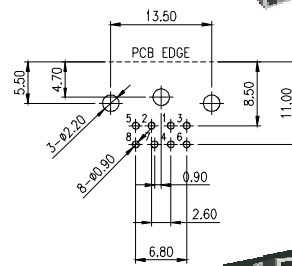

9 OF CONTACTS

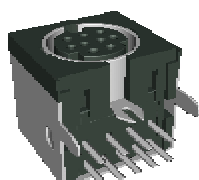
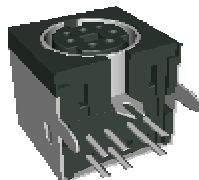
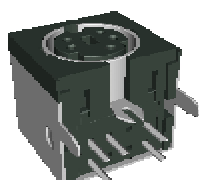
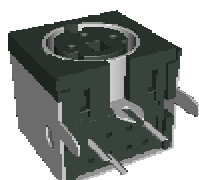
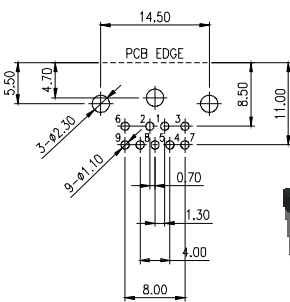

MD

MINI DIN JACK

040

SERIES NO.

Pa

PCB TYPE
Pa: RIGHT ANGLE TYPE

XX

NO. OF CONTACTS
03, 04, 05, 06, 07, 08, 09

X

SHELL PLATING OPTION
T: TIN PLATING
N: NICKLE PLATING

Gft

CONTACT PLATING OPTION
Gft: GOLD FLASH ON CONTACT,
TIN PLATING ON SOLDER TAIL

XX

COLOR OF PLASTIC
(ONLY FOR MD040-Pa06TGft)
BLANK: BLACK
06: GREEN 07: PURPLE

NOTE : SOME SIZES, STYLES AND OPTION ARE NON-STANDARD, NON-CANCELLABLE, NON-RETURNABLE

MINI DIN JACK - RIGHT ANGLE TYPE - Pa

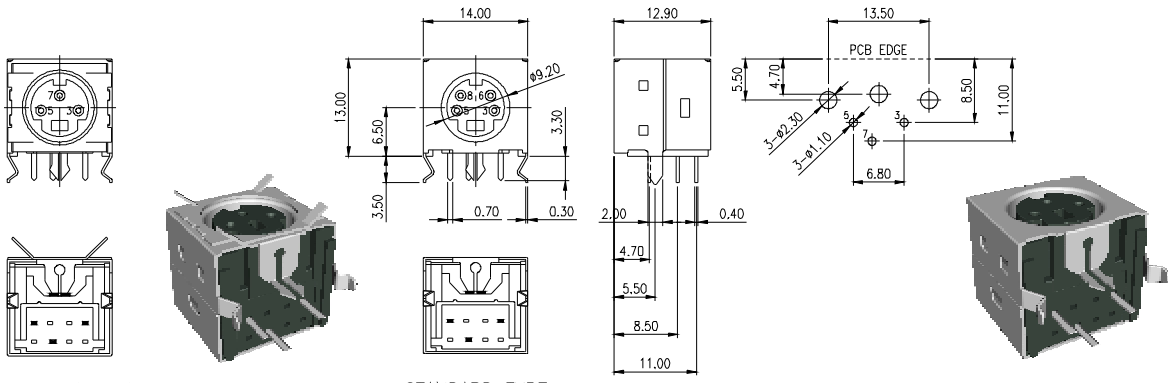

WITH GROUNDING FINGER

STANDARD TYPE
3 OF CONTACTS

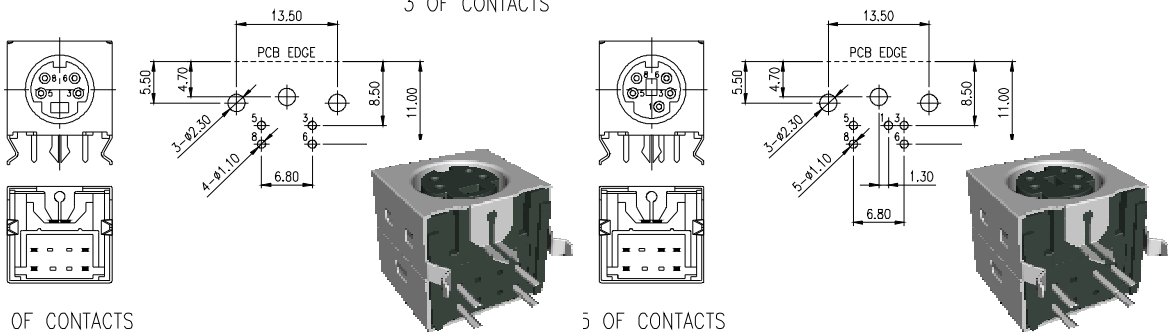

4 OF CONTACTS

5 OF CONTACTS

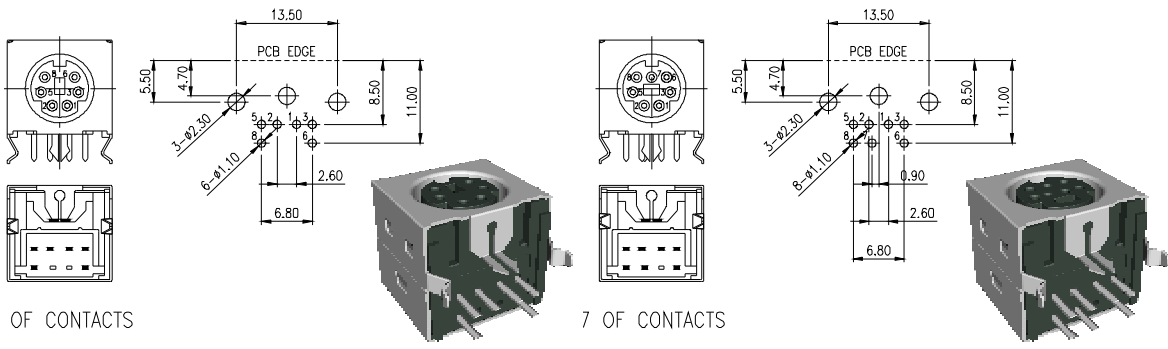

6 OF CONTACTS

7 OF CONTACTS

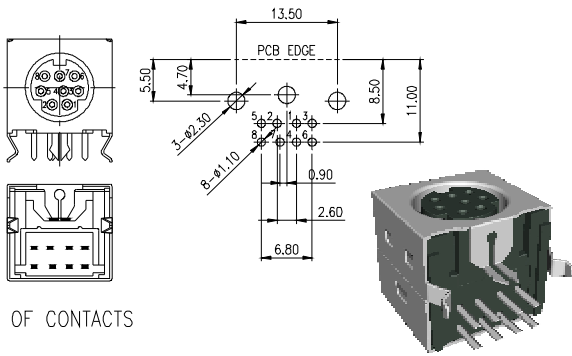

8 OF CONTACTS

| | | | | | | | |
|---------------|------------|----------------------------------|---|----------|---|------------------------------------|--|
| MD | 050 | Pa | XX | X | Gft | X | X |
| MINI DIN JACK | SERIES NO. | PCB TYPE Pa: RIGHT ANGLE TYPE | SHELL PLATING OPTION T: TIN PLATED N: NICKLE PLATED | | CONTACT PLATING OPTION Gft: GOLD FLASH ON CONTACT, TIN PLATING ON SOLDER TAIL | KINKED LEGS K: WITH KINKED LEGS | SPECIAL OPTION BLANK: STANDARD TYPE F: WITH GROUNDING FINGER |
| | | | NO. OF CONTACTS 03, 04, 05, 06, 07, 08 | | | | |

NOTE : SOME SIZES, STYLES AND OPTION ARE NON-STANDARD, NON-CANCELLABLE, NON-RETURNABLE

MINI DIN JACK - RIGHT ANGLE TYPE - Pa

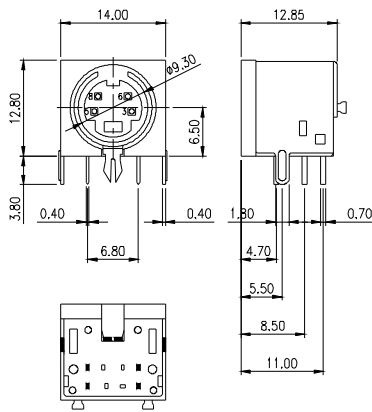

4 OF CONTACTS

PCB LAYOUT

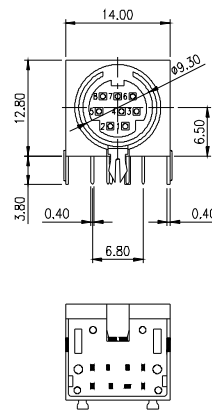

8 OF CONTACTS

PCB LAYOUT

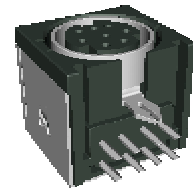
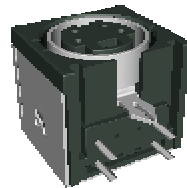

MD

MINI DIN JACK

060

SERIES NO.

Pa

PCB TYPE
Pa: RIGHT ANGLE TYPE

XX

NO. OF CONTACTS
04, 08

X

SHELL PLATING OPTION
T: TIN PLATING
N: NICKLE PLATING

Gft

CONTACT PLATING OPTION
Gft: GOLD FLASH ON CONTACT,
TIN PLATING ON SOLDER TAIL

MINI DIN JACK - RIGHT ANGLE TYPE - Pa

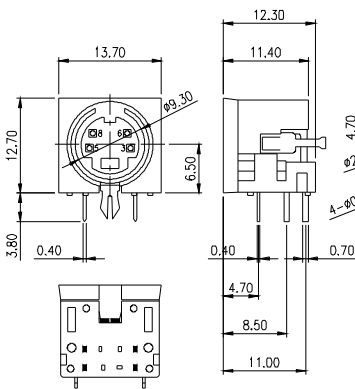

4 OF CONTACTS

PCB LAYOUT

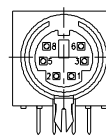

6 OF CONTACTS

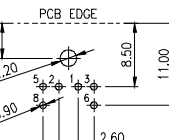

PCB LAYOUT

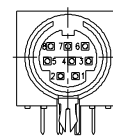

8 OF CONTACTS

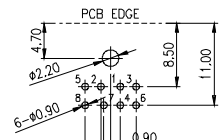

PCB LAYOUT

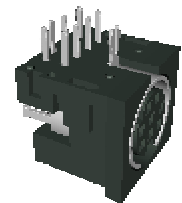
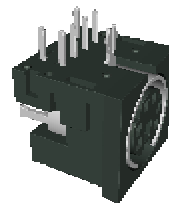
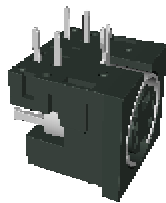

MD

MINI DIN JACK

070

SERIES NO.

Pa

PCB TYPE
Pa: RIGHT ANGLE TYPE

XX

NO. OF CONTACTS
04, 06, 08

Gft

CONTACT PLATING OPTION
Gft: GOLD FLASH ON CONTACT,
TIN PLATING ON SOLDER TAIL

NOTE : SOME SIZES, STYLES AND OPTION ARE NON-STANDARD, NON-CANCELLABLE, NON-RETURNABLE

MINI DIN JACK - RIGHT ANGLE TYPE - Pa

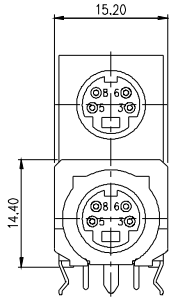

WITH GROUNDING SPRING

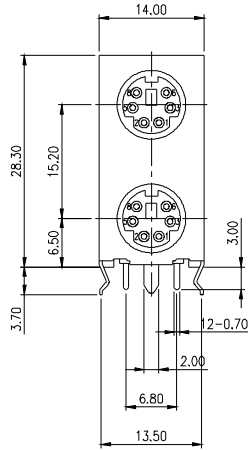

STANDARD TYPE
12 OF CONTACTS

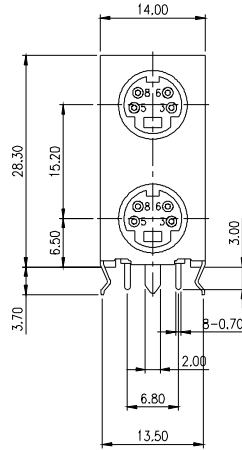

STANDARD TYPE
8 OF CONTACTS

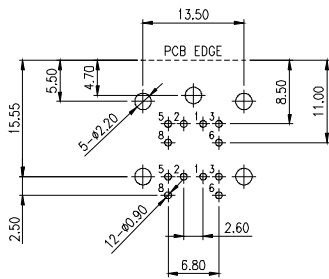
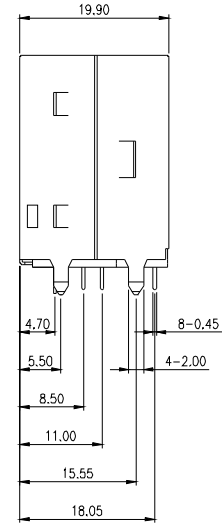

STANDARD TYPE
12 OF CONTACTS

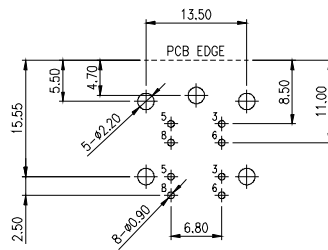
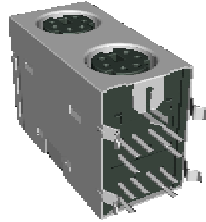

STANDARD TYPE
8 OF CONTACTS

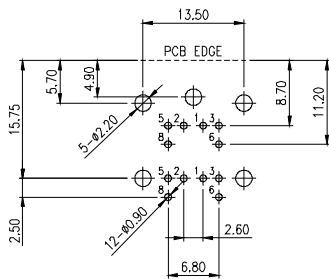
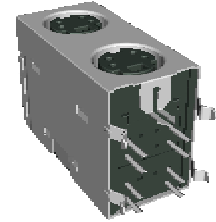

WITH GROUNDING SPRING
12 OF CONTACTS

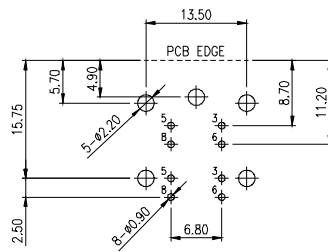
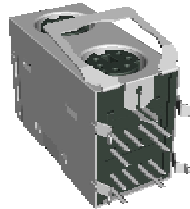

WITH GROUNDING SPRING
8 OF CONTACTS

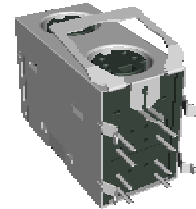

| | | | | | | |
|---------------|---|----------------------------------|--|---------------------------------|---|--|
| MD | XXX | Pa | XX | T | Gft | X |
| MINI DIN JACK | SERIES NO. 100: PLASTIC COLOR, BLACK 199: PLASTIC COLOR, GREEN & PURPLE | PCB TYPE Pa: RIGHT ANGLE TYPE | NO. OF CONTACTS 08 (ONLY FOR MD100) 12 | SHELL PLATING T: TIN PLATING | CONTACT PLATING OPTION Gft: GOLD FLASH ON CONTACT, TIN PLATING ON SOLDER TAIL | SPECIAL OPTION BLANK: STANDARD TYPE S: WITH GROUNDING SPRING |

NOTE : SOME SIZES, STYLES AND OPTION ARE NON-STANDARD, NON-CANCELLABLE, NON-RETURNABLE

MINI DIN JACK - RIGHT ANGLE TYPE - Pa

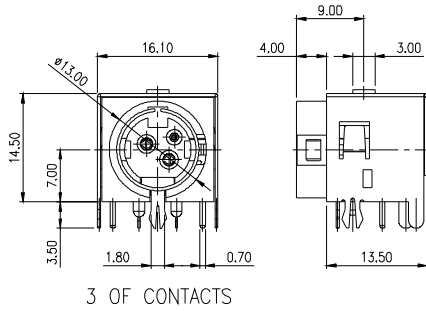

3 OF CONTACTS

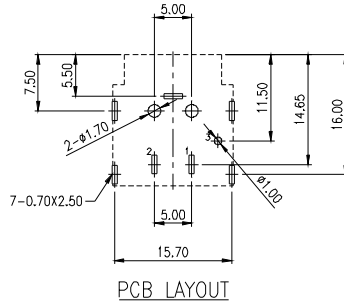

PCB LAYOUT

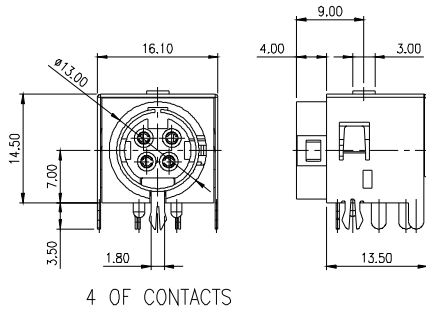
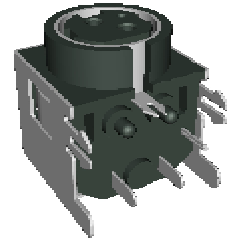

4 OF CONTACTS

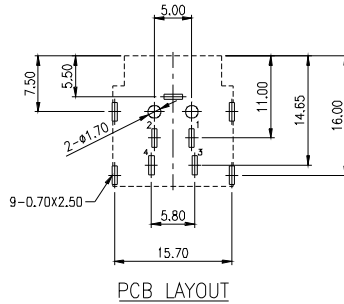

PCB LAYOUT

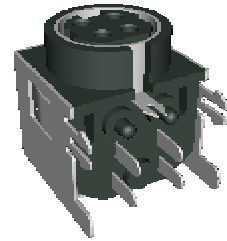

MD

200

Pa

XX

T

Gf

MINI DIN JACK

SERIES NO.

PCB TYPE
Pa: RIGHT ANGLE TYPE

NO. OF CONTACTS
03, 04

SHELL PLATING
T: TIN PLATING

CONTACT PLATING OPTION
Gf: GOLD FLASH

MINI DIN JACK - RIGHT ANGLE TYPE - Pa

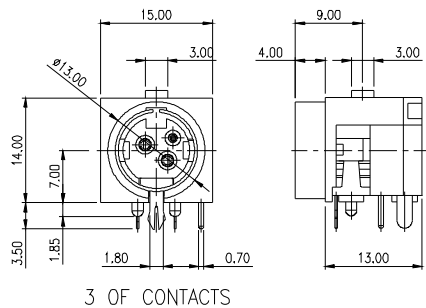

3 OF CONTACTS

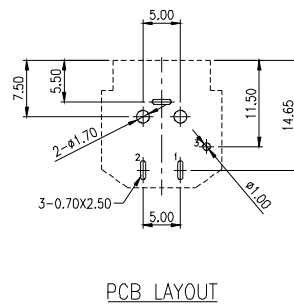

PCB LAYOUT

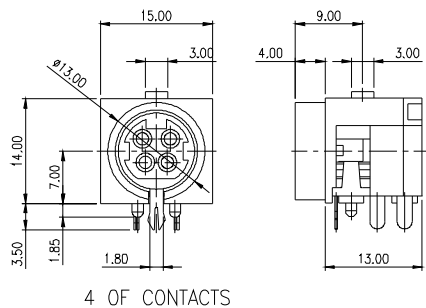
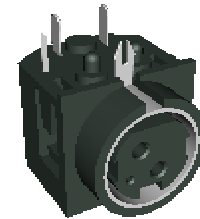

4 OF CONTACTS

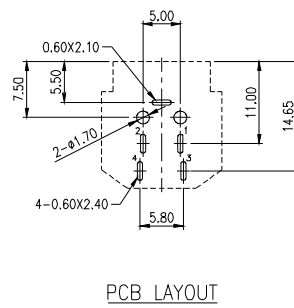

PCB LAYOUT

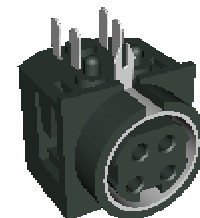

MD

201

Pa

XX

Gf

MINI DIN JACK

SERIES NO.

PCB TYPE
Pa: RIGHT ANGLE TYPE

NO. OF CONTACTS
03, 04

CONTACT PLATING OPTION
Gf: GOLD FLASH

NOTE : SOME SIZES, STYLES AND OPTION ARE NON-STANDARD, NON-CANCELLABLE, NON-RETURNABLE

www.mmtmachrone.com

USA TEL : 1-510-979-2188
FAX : 1-510-979-2189

TAIWAN TEL : 886-2-2755-3193
FAX : 886-2-2784-5109

SINGAPORE TEL : 65-6274-0566
FAX : 65-6274-7891

STACK MINI DIN & RCA JACK - RIGHT ANGLE TYPE - Pa

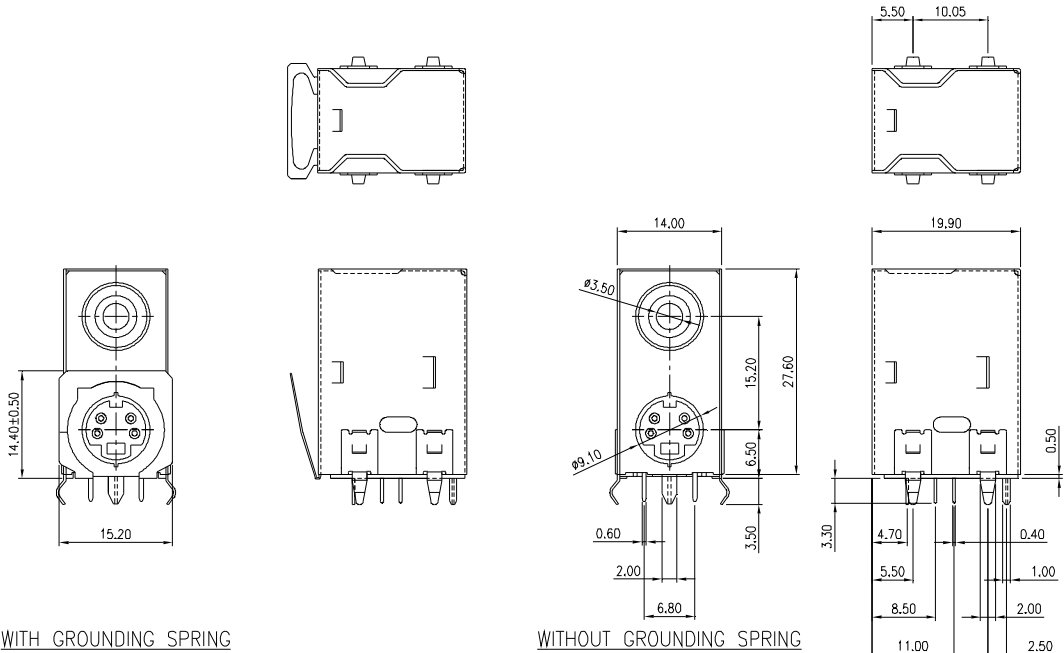

WITH GROUNDING SPRING

WITHOUT GROUNDING SPRING

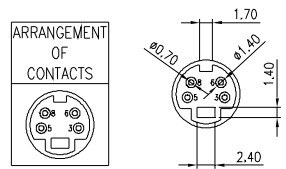

4 OF CONTACTS

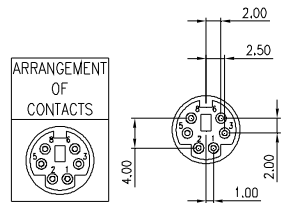

6 OF CONTACTS

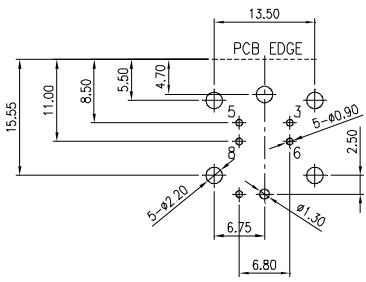

PCB LAYOUT (BOTTOM VIEW)

TABLE 1:

| PART NO. | RCA INSERT RING COLOR |
|---------------------|-----------------------|
| SMR001-Pa__01TGft-- | BLACK |
| SMR001-Pa__02TGft-- | BLUE |
| SMR001-Pa__03TGft-- | RED |
| SMR001-Pa__04TGft-- | YELLOW |
| SMR001-Pa__05TGft-- | WHITE |
| SMR001-Pa__06TGft-- | GREEN |
| SMR001-Pa__07TGft-- | PURPLE |
| SMR001-Pa__08TGft-- | ORANGE |

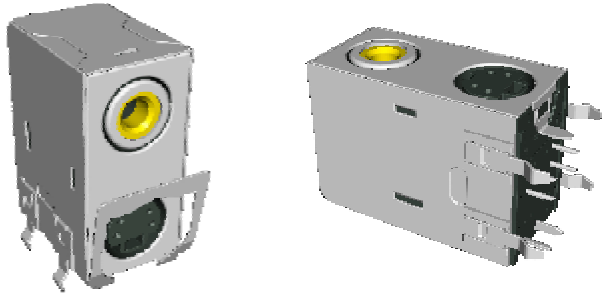

| | | | | | | | |
|---------------------------|------------|----------------------------------|--|---|--|---|---|
| SMR | 001 | Pa | XX | XX | T | Gft | X |
| STACK MINI DIN & RCA JACK | SERIES NO. | PCB TYPE Pa: RIGHT ANGLE TYPE | NO. OF CONTACTS (FOR MINI DIN JACK) 04, 06 | COLOR OF PLASTIC (FOR RCA JACK) SEE TABLE 1 | SHELL PLATING OPTION T: TIN PLATING | CONTACT PLATING OPTION Gft: GOLD FLASH ON CONTACT, TIN PLATING ON SOLDER TAIL | SPECIAL OPTION BLANK: STANDARD S: WITH GROUNDING SPRING |

NOTE : SOME SIZES, STYLES AND OPTION ARE NON-STANDARD, NON-CANCELLABLE, NON-RETURNABLE

