

VI.1 NOTE: THIS DEVICE IS ROHS COMPLIANT.

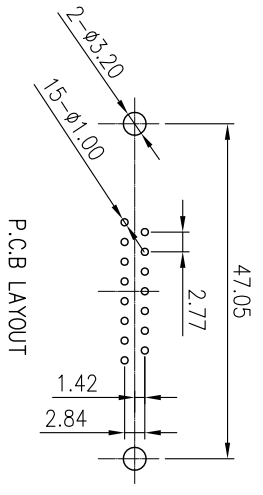
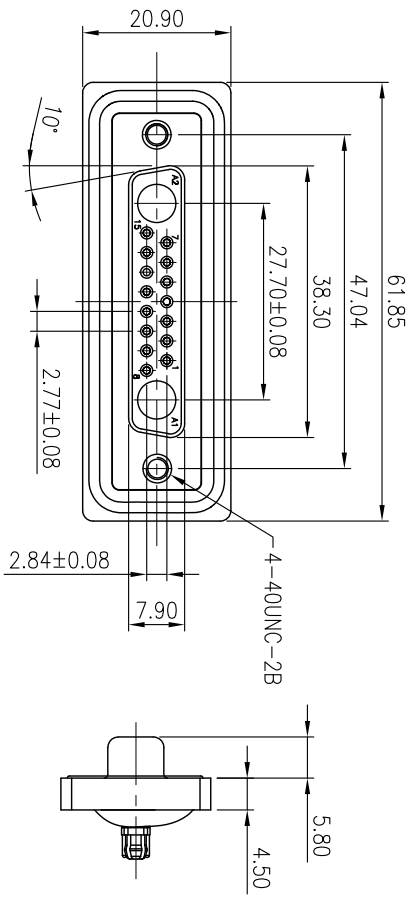
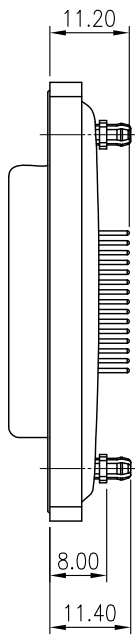

		REVISIONS					
SYM	DESCRIPTION	DATE	APPROVED	SYM	DESCRIPTION	DATE	APPROVED
Δ				Δ			
Δ				Δ			
**CUSTOMER DRAWING FOR REFERENCE ONLY, SAMPLES APPROVAL ARE REQUIRED!!							351

MATERIALS
 CONTACTS: BRASS
 INSULATOR: PBT, UL94V-0 RATED
 SHELL: COLD ROLLER STEEL.
 METAL: WATERTIGHT FRAME: Zn3#
 O-RING: SILICONE
 EPOXY SEALANT: EPOXY
 WATERPROOF RATE: IP68

ELECTRICAL CHARACTERISTICS
 CONTACT CURRENT RATING: 3 AMPS
 DIELECTRIC WITHSTANDING VOLTAGE: AC 1000V r.m.s
 INSULATION RESISTANCE: 500MΩ MIN. AT DC 500V
 CONTACT RESISTANCE: 30mΩ MAX.
 OPERATING TEMPERATURE: -55°C~+105°C

ORDER INFORMATION:
 WCDB201-PF17W2GX
 201: SERIES NO.
 P: TERMINAL TYPE, PCB TYPE, STRAIGHT
 F: FEMALE
 17W2: CONTACT ARRANGEMENT, 17 PINS 2 COAXIAL
 GX: PLATING OPTION
 Gf: GOLD FLASH
 G15: 15u" GOLD PLATED
 G30: 30u" GOLD PLATED

TOLERANCES UNLESS OTHERWISE SPECIFIED		SIGNATURES		DATE		MODEL	
SYMBOL	UNIT	SCALE	CHECKED	APPROVALS	NO.	TITLE	
Δ	mm	1/1	PEGGY		08/MAR/11'	WATERPROOF COMBO D-SUB	
						WCDB201-PF17W2G_	

MMT CORPORATION

TEL:(510)979-2188 www.mmtmachine.com FAX:(510)979-2189