

		REVISIONS					
SYM	DESCRIPTION	DATE	APPROVED	SYM	DESCRIPTION	DATE	APPROVED
Δ				Δ			
Δ				Δ			
<b>**CUSTOMER DRAWING FOR REFERENCE ONLY, SAMPLES APPROVAL ARE REQUIRED!!</b>							351

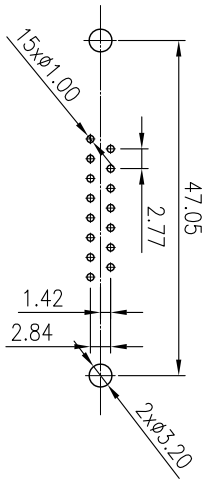
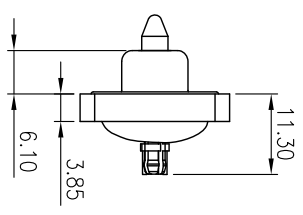
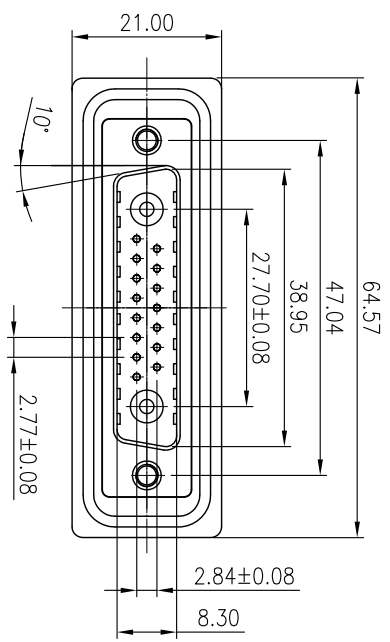
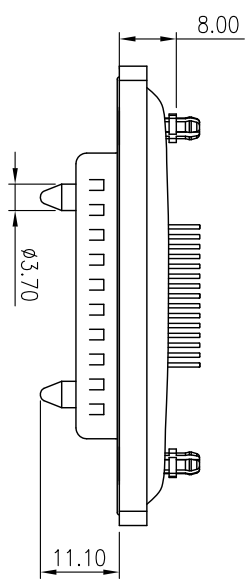

P.C BOARD LAYOUT

**MATERIALS**  
 CONTACTS: BRASS  
 INSULATOR: PBT, UL94V-0 RATED  
 SHELL: COLD ROLLER STEEL.  
 METAL WATERTIGHT FRAME: PBT+30%GF BLACK  
 O-RING: SILICONE  
 EPOXY SEALANT: EPOXY  
 WATERPROOF RATE: IP68

**ELECTRICAL CHARACTERISTICS**  
 CONTACT CURRENT RATING: 3 AMPS  
 DIELECTRIC WITHSTANDING VOLTAGE: AC 1000V r.m.s  
 INSULATION RESISTANCE: 500MΩ MIN AT DC 500V  
 CONTACT RESISTANCE: 25mΩ MAX.  
 OPERATING TEMPERATURE: -55°C~+105°C

**ORDER INFORMATION:**  
 WCDB202-PM17W2GX  
 202: SERIES NO.  
 P: TERMINAL TYPE, PCB TYPE, STRAIGHT  
 M: MALE  
 17W2: CONTACT ARRANGMENT, 17 PINS 2 COAXIAL  
 GX: PLATING OPTION  
 Gf: GOLD FLASH  
 G15: 15u" GOLD PLATED  
 G30: 30u" GOLD PLATED

TOLERANCES UNLESS OTHERWISE SPECIFIED		SIGNATURES		DATE		MODEL	
±0.25		DRAWN	AARON	23/MAR/11'	TITLE	WATERPROOF COMBO D-SUB	
SYMBOL	UNIT	CHECKED	UNA	23/MAR/11'	NO.	WCDB202-PM17W2G-	
Δ	mm	APPROVALS					
	SCALE						
	1/1						

**MMT CORPORATION**