

8 7 6 5 4 3 2 1
 VI.1 NOTE: THIS DEVICE IS ROHS COMPLIANT.

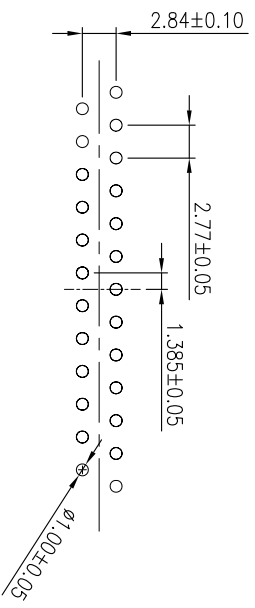
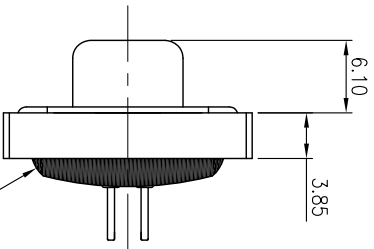
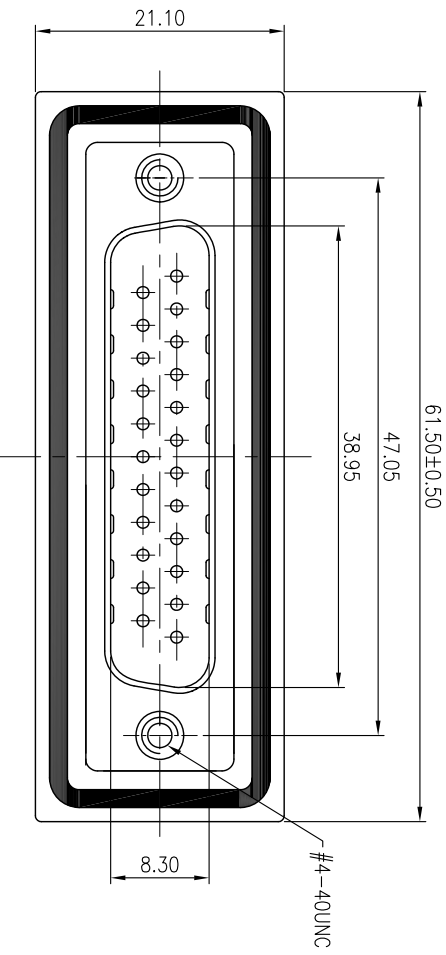
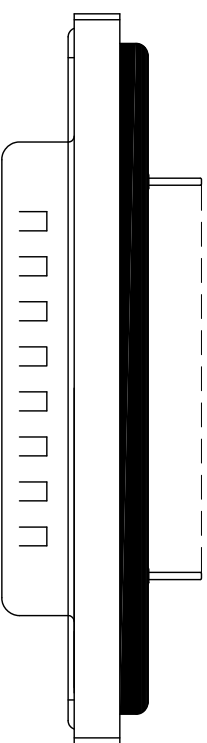

REVISIONS		1	2	3	4	5	6	7	8
SYM	DESCRIPTION	DATE	APPROVED	SYM	DESCRIPTION	DATE	APPROVED	SYM	DESCRIPTION
Δ				Δ				Δ	
Δ									

****CUSTOMER DRAWING FOR REFERENCE ONLY, SAMPLES APPROVAL ARE REQUIRED!!**

351

MATERIALS
 CONTACTS: BRASS
 INSULATOR: PBT, UL94V-0 RATED
 SHELL: COLD ROLLER STEEL
 METAL WATERIGHT FRAME: PBT GF UL 94V-0, COLOR: BLACK
 O-RING: SILICONE
 EPOXY SEALANT: EPOXY

ELECTRICAL CHARACTERISTICS
 CONTACT CURRENT RATING: 3 AMPERES
 DIELECTRIC WITHSTANDING VOLTAGE: AC 1000V R.M.S.
 INSULATION RESISTANCE: 500MΩ MIN AT DC 500V.
 CONTACT RESISTANCE: 25mΩ MAX.
 TEMPERATURE RATING: -55°C~+105°C
 WATERPROOF RATE: IP67

ORDER INFORMATION:
 WDB950-PM25GX-XK
 WDB: WATERPROOF D-SUB CONNECTOR
 950: SERIES NO.

P: PCB TYPE, STRAIGHT
 M: MALE
 25: NO. OF CONTACTS
 GX: CONTACT PLATING OPTION
 Gf: GOLD FLASH ON CONTACT
 G15: 15u" GOLD ON CONTACT
 G30: 30u" GOLD ON CONTACT
 X: FLANGE MOUNTING OPTION
 O: #4-40 THREAD HOLE
 1: #4-40 THREAD HOLE WITH #4-40UNC SCREWLOCK
 K: INSULATOR COLOR, BLACK

TOLERANCES UNLESS OTHERWISE SPECIFIED		SIGNATURES		DATE		MODEL	
SYMBOL	UNIT	SCALE	CHECKED	APPROVALS	DRAWN	DATE	TITLE
Δ	mm	2/1	PEGGY		AARON	31/MAY/11'	D-SUB WATERPROOF CONN.
						31/MAY/11'	WDB950-PM25G--K

MMT CORPORATION