

VI.1 NOTE: THIS DEVICE IS ROHS COMPLIANT.

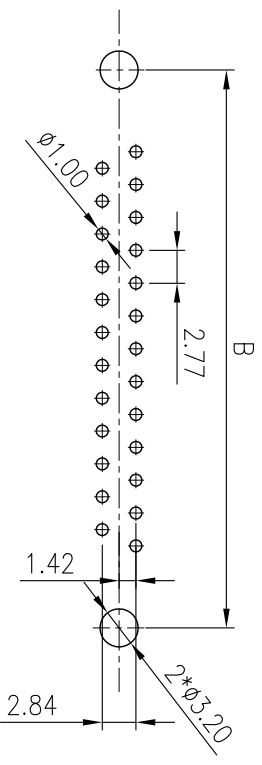
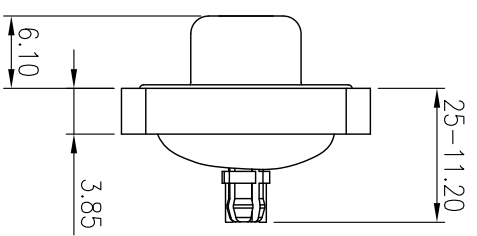
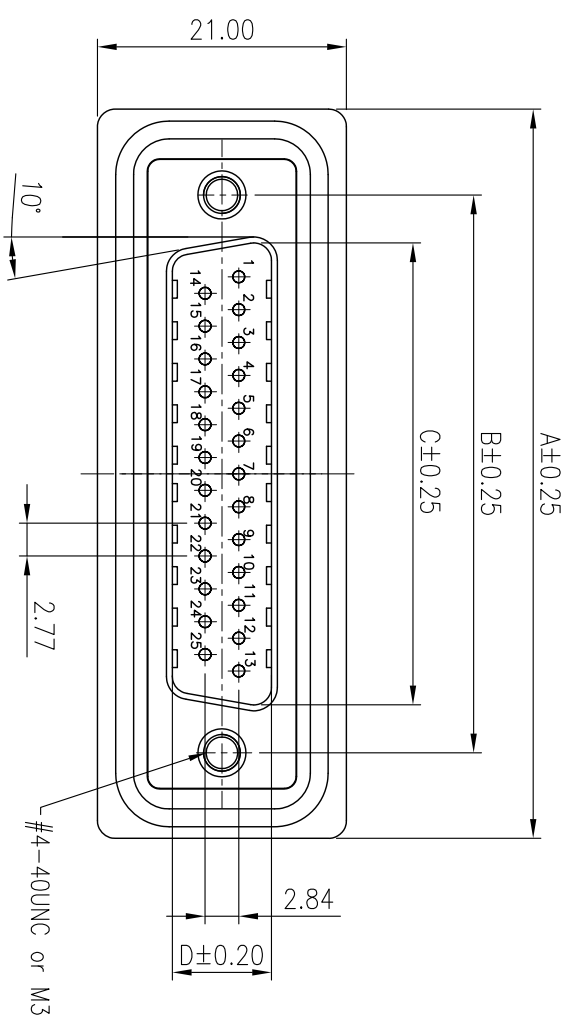
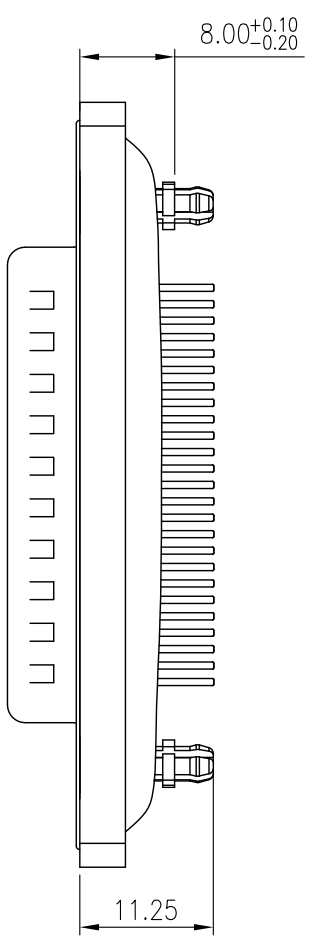

REVISIONS		1	2	3	4	5	6	7	8
SYM	DESCRIPTION	DATE	APPROVED	SYM	DESCRIPTION	DATE	APPROVED	SYM	DESCRIPTION
Δ				Δ				Δ	
Δ									

****CUSTOMER DRAWING FOR REFERENCE ONLY, SAMPLES APPROVAL ARE REQUIRED!!**

351

MATERIALS
 CONTACTS: BRASS
 INSULATOR: PBT, UL94V-0 RATED
 SHELL: COLD ROLLER STEEL
 METAL WATERTIGHT FRAME: PBT+30%GF UL 94V-0, COLOR: BLACK
 O-RING: SILICONE
 EPOXY SEALANT: EPOXY

ELECTRICAL CHARACTERISTICS
 CONTACT CURRENT RATING: 3 AMPERES
 DIELECTRIC WITHSTANDING VOLTAGE: AC 1000V R.M.S.
 INSULATION RESISTANCE: 500MΩ MIN AT DC 500V.
 CONTACT RESISTANCE: 25mΩ MAX.
 TEMPERATURE RATING: -55°C~+105°C
 WATERPROOF RATE: IP67

ORDER INFORMATION:
 WDB952-PMXXXG-XK
 WDB: WATERPROOF D-SUB CONNECTOR
 952: SERIES NO.
 P: PCB TYPE, STRAIGHT
 M: MALE
 XX: NO. OF CONTACTS
 GX: CONTACT PLATING OPTION
 Gf: GOLD FLASH ON CONTACT
 G15: 15u" GOLD ON CONTACT
 G30: 30u" GOLD ON CONTACT
 X: FLANGE MOUNTING OPTION
 0: #4-40 THREAD HOLE
 1: #4-40 THREAD HOLE WITH #4-40UNC SCREWLOCK
 M3: M3 THREAD HOLE DEPTH 3.5mm MAX.
 K: INSULATOR COLOR, BLACK

PART NO.	No. of Contact	A	B	C	D
WDB952-PM09GX-XK	09	39.50	25.00	16.90	8.30
WDB952-PM15GX-XK	15	48.00	33.30	25.25	8.30
WDB952-PM25GX-XK	25	64.50	47.05	38.95	8.30
WDB952-PM37GX-XK	37	78.40	63.50	55.40	8.30

TOLERANCES UNLESS OTHERWISE SPECIFIED		SIGNATURES		DATE	MODEL	
SYMBOL	UNIT	SCALE	CHECKED	MELODY	21/SEP/22	TITLE
Δ	mm	2/1	APPROVALS			D-SUB WATERPROOF CONN.
						WDB952-PM__G__K

MMT CORPORATION

TEL:(510)979-2188 www.mmtmachine.com FAX:(510)979-2189